

# BSL26/BSL26C

Emergency LED Driver

# PHILIPS bodine

A Division Of Philips Electronics North America Corporation

## Up to 5.1 W emergency illumination with LEDs

### Product Summary

#### UL RECOGNIZED/CSA CERTIFIED

Factory Installation only  
(Indoor and Damp)  
Output LVLE Compliant



#### Illumination Time

90 Minutes

#### Full Warranty

5 Years (NOT pro-rata)

#### Dual Input Voltage

120/277 VAC, 60 Hz

#### AC Input Current

280 mA

#### AC Input Power Rating

3.0 W

#### Output Voltage

3.0 to 30 VDC (Maximum)

#### Output Current

265 mA (Maximum)

#### Output Power

5.1 W (Maximum),  
measured at nominal battery voltage

#### Test Switch

Illuminated Test Switch

#### Battery

High-Temperature,  
Maintenance-Free  
Nickel-Cadmium Battery  
7- to 10-Year Life Expectancy

#### Battery Charging Current

250 mA

#### Recharge Time

24 Hours

#### Charging Indicator Light

LED

#### Temperature Rating (Ambient)

0°C to +50°C  
(32°F to 122°F)

#### Dimensions

9.4" x 2.4" x 1.5"  
(238 mm x 60 mm x 38 mm)  
Mounting Center 8.9" (226 mm)

#### Weight

BSL26 - 2.0 lbs. (0.91 kg)  
BSL26C Type 1 - 3.0 lbs. (1.4 kg)  
BSL26C Type 1 option 6 - 2.9 lbs. (1.3 kg)  
BSL26C Type 2 - 2.6 lbs. (1.2 kg)  
BSL26C Type 2 option 6 - 2.5 lbs. (1.1 kg)

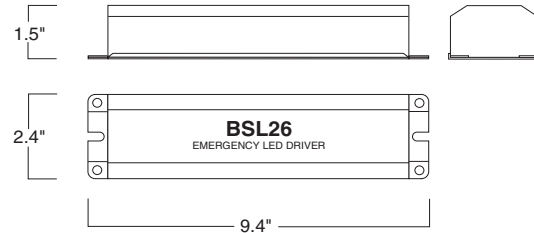

### Application

The BSL26C emergency LED driver works in conjunction with an AC LED driver that has an output current not to exceed 2.8 ADC Continuous to convert LED fixtures into emergency lighting. The emergency driver consists of a high-temperature nickel-cadmium battery, charger and electronic circuitry in one compact red case. The BSL26C can be used with an LED lighting load of up to 5.1 Watts measured at nominal battery voltage at rated current of 265 mA for 90 minutes. If used in an emergency-only fixture, no AC driver is necessary. The BSL26 is suitable for indoor and damp locations and for sealed & gasketed fixtures, including fixtures rated for wet locations. The BSL26C is suitable for indoor and damp locations. Neither the BSL26C nor the BSL26 is suitable for air handling heated air outlets and wet or hazardous locations. For more information about specific LED and AC driver compatibility, please call the factory.

### Operation

When AC power fails, the BSL26C immediately switches to the emergency mode, operating the LEDs at a reduced lumen output for a minimum of 90 minutes. When AC power is restored, the emergency driver automatically returns to the charging mode.

### Installation

The BSL26C does not affect normal fixture operation and may be used with either a switched or unswitched fixture. If a switched fixture is used, an unswitched hot lead must be connected to the emergency driver. The emergency driver must be fed from the same branch circuit as the AC driver. Installation is not recommended with fixtures where the ambient temperature may fall below 0° C.

### UL, CSA and Code Compliance

The BSL26C has been tested by Underwriters Laboratories in accordance with the standards set forth in UL 924, "Emergency Lighting and Power Equipment," and by the Canadian Standards Association (CSA) in accordance with the standards set forth in C22.2 No. 141, "Emergency Lighting Equipment." The BSL26C is UL Component Recognized and CSA Certified for factory installation only. Emergency illumination time exceeds the National Electrical Code (NEC), Life Safety Code (NFPA-LSC), National Building Code of Canada (NBC), National Fire Code of Canada (NFC) and UL 90-minute requirements.

### Specifiers Reference

Project \_\_\_\_\_ Type \_\_\_\_\_ Model No. \_\_\_\_\_  
Comments \_\_\_\_\_

L3000112

08/06/12 © Philips Emergency Lighting  
P.O. Box 460 Collierville, TN USA 38027-0460  
Sales 800-223-5728 FAX 901-853-5009  
Tech. Support 888-263-4638  
www.philips.com/bodine

# BSL26/BSL26C

Emergency LED Driver

Up to 5.1 W emergency illumination with LEDs

## Emergency Illumination

The BSL26C operates an LED load of up to 5.1 W measured at nominal battery voltage at rated current (265 mA) for a minimum of 90 minutes.

## Specification

Emergency lighting shall be provided by using a LED fixture equipped with a Philips Bodine BSL26C emergency driver. This emergency driver shall consist of a high-temperature, maintenance-free nickel-cadmium battery, charger and electronic circuitry contained in one 9 3/8" x 2 3/8" x 1 1/2" red metal case. The BSL26C comes with 2' length(s) of flexible conduit. (The BSL26 does not have conduit.) An illuminated test switch (ITS) to monitor charger and battery and installation hardware shall be provided. The emergency driver shall be capable of operating an LED load of up to 5.1 Watts at a maximum rated current (265 mA) for a minimum of 90 minutes. It is suitable for indoor and damp locations and for sealed & gasketed fixtures (BSL26 only). The BSL26C shall have 3 Watts of input power and a 14.4 Watt-hour battery capacity and shall comply with emergency standards set forth by the current NEC. The emergency driver shall be UL Recognized and CSA Certified for factory installation only and shall be warranted for a full five years from date of purchase.

## Installation Options and Ordering Codes

The BSL26C can be ordered in several mounting configurations and with different test switch/LED options. Please see the Ordering Codes at right to determine which configuration best meet your requirements.

## Warranty

Model BSL26C is warranted for five (5) full years from date of purchase. This warranty covers only properly installed Philips Bodine emergency LED drivers used under normal conditions. For the warranty period, Philips Emergency Lighting will, at its option, repair or replace without charge a defective emergency LED driver, provided it is returned to the factory transportation prepaid and our inspection determines it to be defective under terms of the warranty. Repair or replacement, as stated above, shall constitute the purchaser's exclusive warranty, which does not extend to transportation, installation, labor or any other charges; nor does it apply to any equipment of another manufacturer used in conjunction with the emergency driver.

### BSL26

Includes Loose ITS Parts Kit

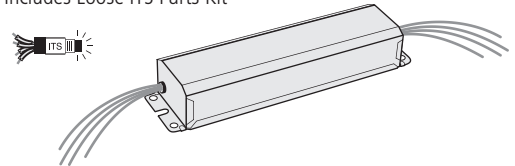

### BSL26C Type 1

Includes ITS on Wall Plate

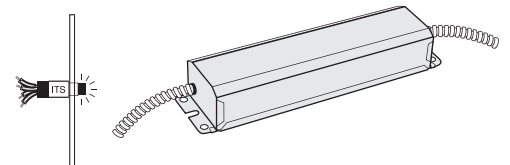

### BSL26C Type 1 option 6

Includes ITS

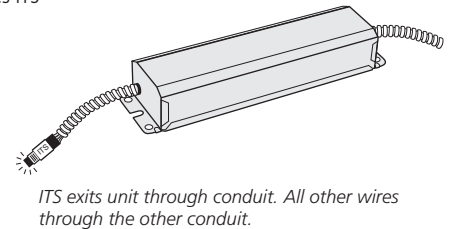

### BSL26C Type 1 option 6B

Includes ITS

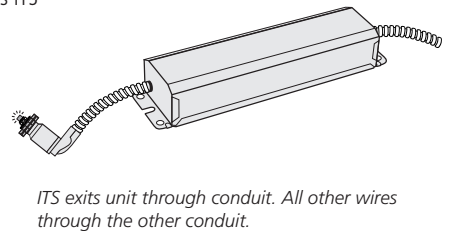

### BSL26C Type 2

Includes ITS on Wall Plate

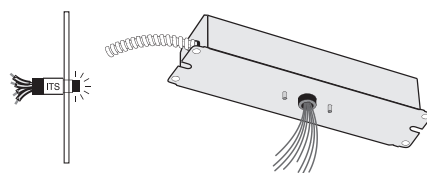

Test switch and LED wires exit unit through conduit. All other wires exit through lid. Studs are threaded so unit can be mounted on a J-box plate.

### BSL26C Type 2 option 6

Includes ITS

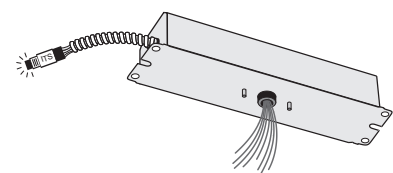

ITS exits unit through conduit. All other wires through lid. Studs are threaded so unit can be mounted on a J-box plate.

L3000112

08/06/12 © Philips Emergency Lighting  
P.O. Box 460 Collierville, TN USA 38027-0460  
Sales 800-223-5728 FAX 901-853-5009  
Tech. Support 888-263-4638  
www.philips.com/bodine

For the most current technical information and notices, please visit TechNotes on our website.