

# softlite™ III 1x4



## features

1'x4' semi-recessed indirect with center basket below the ceiling.

High reflectance, low gloss Matte White finish controls glare and provides high efficiency.

Shallow housing reflectors extend less than 3" above ceiling.

Two-piece endcaps provide row-mount capability for all Softlite™ III configurations.

Diffuser assembly is retained by self-aligning torsion springs and pulls down for easy relamping.

Softlite™ III provides high angle uniform distribution ideal for general illumination.

## dimensional data

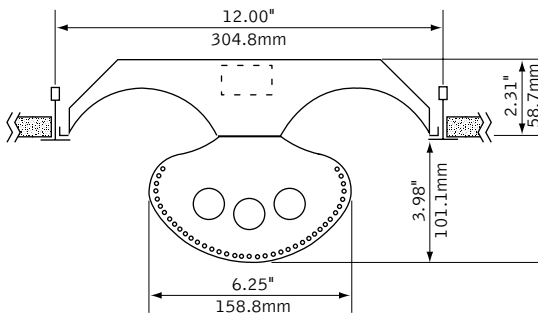

## lampping options

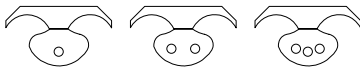

T8 LAMPS

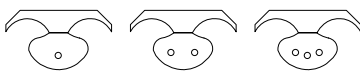

T5/T5H0 LAMPS

## shielding options & details



perforated

radial blade louver

continuous row mount

## companion luminaire

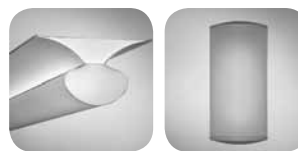

linear

sconce

## performance

2-Lamp T8  
74% Efficiency  
1235 cd @ 0°

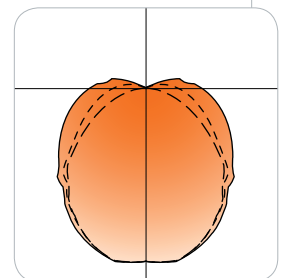

Visit [focalpointlights.com](http://focalpointlights.com) for complete photometric data.

fixture:  
project:

### mounting information

#### grid

specify "G" for flat 9/16" and 15/16" tee or "ST" for 9/16" slot tee grid types.

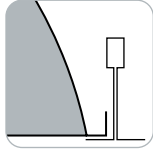

"G" flat tee

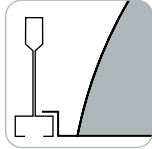

"ST" slot tee

#### drywall frame kit

specify "DF" Drywall Frame Kit for drywall ceiling conditions.

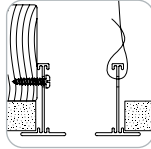

Use tie-wire or screws to secure frame kit.

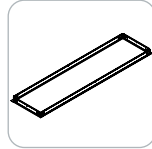

cut out dimensions:  
1': Min: 12.25"  
Max: 12.563"  
4': Min: 48.25"  
Max: 48.563"

### specifications

#### construction

One-piece 20 Ga. steel reflector and housing.  
Die-cast aluminum end caps support perforated lamp shield.  
Optional radial blade louver: .75"H x 1" frequency fabricated of 20 Ga. steel with acrylic lens insert.  
Bottom and top access 20 Ga. steel ballast compartment.

weight: 26 lbs

#### optic

20 Ga. steel reflector finished in Matte Satin White powder coat.  
Lamps are shielded by detachable 22 Ga. steel perforated lamp shield with acrylic lens insert.

#### electrical

Electronic ballasts are thermally protected and have a Class "P" rating.  
Optional dimming ballasts available.  
Consult factory for dimming specifications and availability.  
UL and cUL listed.

#### finish

Polyester powder coat applied over a 5-stage pre-treatment.

### ordering

luminaire series	Softlite III	FS3	<u>FS3</u>
nominal size	1' x 4'	14	<u>14</u>
distribution	Bi-Directional	B	<u>B</u>
lamp quantity	One Lamp	1	_____
	Two Lamps	2	_____
	Three Lamps	3	_____
lamp type	T8	T8	_____
	T5	T5	_____
	T5H0	T5H0	_____
ballast	Electronic Instant Start <20% THD	E	_____
	Electronic Program Start <10% THD	S	_____
	Electronic Dimming Ballast*	D	_____
voltage	120 Volt	120	_____
	277 Volt	277	_____
	347 Volt	347	_____
mounting	Grid	G	_____
	Slot Tee	ST	_____
	("ST" must be indicated for slot tee application. "G" luminaires are not compatible with slot tee ceiling systems.)		
shielding	Perforated Shield	PS	_____
	Radial Blade Louver	RLP	_____
factory options	Chicago Plenum	CP	_____
	Drywall Frame Kit	DF	_____
	(Cut out dimensions: Min: 12.25"/Max: 12.563" Min: 48.25"/Max 48.563")		
	Emergency Battery Pack*	EM	_____
	Earthquake Clips	EQ	_____
	HLR/GLR Fuse	FU	_____
	Flex Whip*	FW	_____
	Include 3000K Lamp*	L830	_____
	Include 3500K Lamp*	L835	_____
	Include 4100K Lamp*	L841	_____
	Separate Circuit*	SC	_____
	Separate Circuit Tandem*	SCT	_____
	Labor Saving Master Satellite*	LS	_____
	Ballast Saving Tandem*	BST	_____
	Lutron™ Sensor Feed*	SF	_____
	(EcoSystem ballast required)		
finish	Matte Satin White	WH	<u>WH</u>

\* for more information see Reference section.

# softlite™ III 1x4



Filename: FS3142T8PS.IES  
 Catalog #: FS3-14-B-2-T8-E-120-G-PS-WH  
 Efficiency: 74%  
 Test #: 12008.0

## CANDLEPOWER DISTRIBUTION

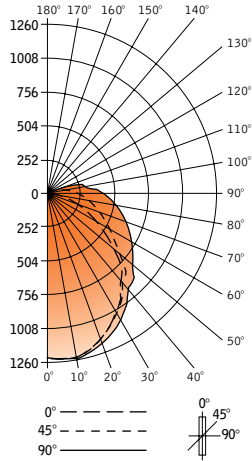

Spacing 1.2  
 Criterion: 1.3

Vertical Angle	Horizontal Angle				Zonal Lumens	
	0°	22.5°	45°	67.5°		90°
0°	1235	1235	1235	1235	1235	
5°	1247	1247	1247	1247	119	
15°	1219	1219	1224	1225	1229	347
25°	1114	1117	1123	1132	1138	521
35°	962	963	977	996	1008	616
45°	798	805	831	873	894	650
55°	554	567	617	716	760	574
65°	344	366	486	605	656	486
75°	178	216	373	501	554	385
85°	44	118	265	394	445	279
90°	4	94	231	349	402	
95°	4	47	181	298	346	191
105°	11	16	92	227	254	124
115°	11	11	24	67	90	38
125°	0	0	0	16	26	7
135°	0	0	0	0	0	0
145°	0	0	0	0	0	0
155°	0	0	0	0	0	0
165°	0	0	0	0	0	0
175°	0	0	0	0	0	0
180°	0	0	0	0	0	0

## LUMEN SUMMARY

Zone	Lumens	% Lamp	% Fixt
0°-30°	986	16.7	22.8
0°-40°	2825	47.9	65.2
0°-60°	3974	67.4	91.7
0°-90°	359	6.1	8.3
<b>Total Luminaire</b>	<b>0°-180° 4334</b>	<b>74</b>	<b>100.0</b>

## LUMINANCE DATA (CD/M<sup>2</sup>)

Vertical Angle	0°	45°	90°
45°	3069	2388	2569
55°	2627	1972	2429
65°	2214	1812	2446
75°	1871	1731	2572
85°	1373	1698	2851

## CO-EFFICIENTS OF UTILIZATION

Floor	80				70				50				30				10				00			
Ceiling	70	50	30	10	70	50	30	10	50	10	50	10	50	10	50	10	50	10	50	10	50	10	50	10
Wall	86	86	86	86	83	83	83	83	78	78	74	74	69	69	69	69	67	67	63	63	60	60	56	56
RCR	0	1	2	3	4	5	6	7	8	9	10	10	10	10	10	10	10	10	10	10	10	10	10	10
1	78	74	70	67	75	71	65	67	62	63	59	60	56	54										
2	70	64	58	54	68	62	53	58	51	55	49	52	47	45										
3	64	56	50	45	62	55	44	52	43	49	41	46	40	38										
4	59	50	43	38	57	48	38	46	36	43	35	41	34	32										
5	54	44	37	32	52	43	32	41	31	38	30	36	29	27										
6	49	39	33	28	48	38	28	36	27	35	26	33	25	24										
7	45	35	29	24	44	34	24	33	23	31	23	30	22	21										
8	42	32	25	21	40	31	21	29	20	28	20	27	19	18										
9	39	29	22	18	37	28	18	26	18	25	17	24	17	15										
10	36	26	20	16	35	25	16	24	16	23	15	22	15	13										

Numbers indicate percentage values of

Go to [www.focalpointlights.com](http://www.focalpointlights.com) for additional photometric data.