

recessed  
**mondana**



Design: Hartmut S. Engel and RZB

**features**

Decorative recessed luminaire with round opal diffuser, may be mounted in wall or ceiling.

Available in 26" and 21" diameters.

IP 65 rated. Clear silicone o-ring seal keeps bugs and dust out of diffuser to ensure shadow free illumination. Housing designed for both IC and non-IC rated ceilings.

Optical cavity creates uniform halo of light around housing providing a distinct visual presence.

Mondana is ideally suited for corporate, hospitality or medical applications that require a luminaire with a contemporary design and clean visual appearance.

**companion luminaires**

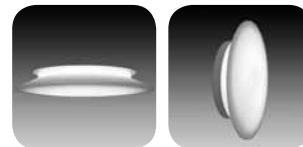

semi-recessed

surface mount

**dimensional data**

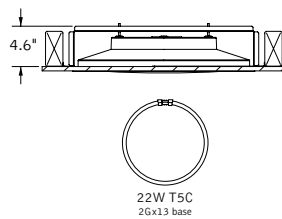
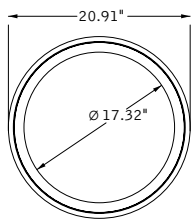
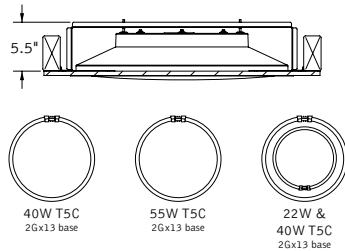
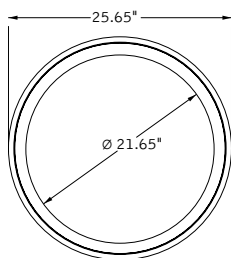

**performance**

21" Diameter  
1-Lamp 22W T5 Circular  
62% Efficiency  
386 cd @ 0°

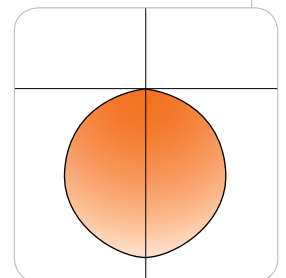

Visit [focalpointlights.com](http://focalpointlights.com) for complete photometric data.

fixture:  
project:

### mounting information

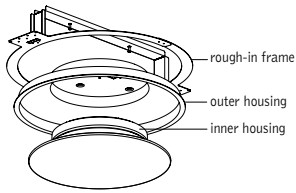

#### Drywall framing dimensions

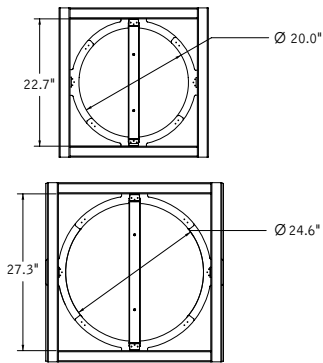

#### Tile cut-out dimensions

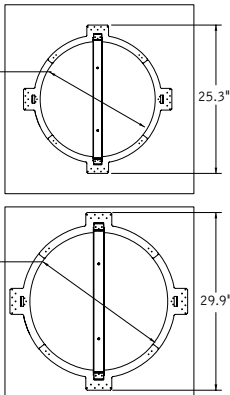

>2' tile required for large Dia.

### specifications

#### construction

Molded plastic inner housing.  
One-piece 18 Ga. spun steel outer housing.  
Lamps are shielded by opal white, screw-on molded plastic diffuser with clear silicone o-ring seal.  
Lamp and ballast are mounted to 20 Ga. reflector.  
IP65 rated.  
All luminaires are provided with 18 Ga. galvanized steel rough-in frame.

26" Dia. Weight: 15 lbs  
21" Dia. Weight: 12 lbs

#### optic

One-piece 20 Ga. steel reflectors finished in Matte Satin White powder coat.

#### electrical

Electronic ballasts are thermally protected and have a Class "P" rating.  
UL and cUL listed for insulated and non insulated ceiling types.  
Requires 1/2" trade size conduit with lock nut style connector, snap-in connectors are not compatible.

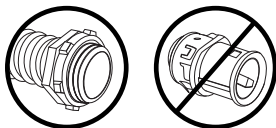

#### finish

Plastic inner housing molded in matte white finish. Outer steel housing finished in Matte Satin White.

### ordering

|                                   |        |                 |
|-----------------------------------|--------|-----------------|
| <b>luminaire series</b>           |        | <u>FMN</u>      |
| Mondana                           | FMN    |                 |
| <b>mounting</b>                   |        | <u>R</u>        |
| Recessed                          | R      |                 |
| <b>nominal size</b>               |        | <u>        </u> |
| 26" Diameter (ADA compliant)      | 26     |                 |
| 21" Diameter (ADA compliant)      | 21     |                 |
| <b>lampping</b>                   |        | <u>        </u> |
| <b>26" Diameter</b>               |        |                 |
| One Lamp 40W T5 Circular          | FC40   |                 |
| One Lamp 55W T5 Circular          | FC55   |                 |
| (1) 22W & (1) 40W T5 Circular     | FC2240 |                 |
| <b>21" Diameter</b>               |        |                 |
| One Lamp 22W T5 Circular          | FC22   |                 |
| <b>voltage</b>                    |        | <u>        </u> |
| 120 Volt                          | 120    |                 |
| 277 Volt                          | 277    |                 |
| 347 Volt                          | 347    |                 |
| <b>ballast</b>                    |        | <u>S</u>        |
| Electronic Program Start <10% THD | S      |                 |
| <b>factory options</b>            |        | <u>        </u> |
| Fusing                            | FU     |                 |
| Include 3000K Lamp                | L830   |                 |
| Include 3500K Lamp                | L835   |                 |
| Include 4100K Lamp                | L841   |                 |
| <b>finish</b>                     |        | <u>WH</u>       |
| Matte White Housing               | WH     |                 |

\* for more information see Reference section.

recessed  
**mondana™**



Filename: FMNR21FC22.IES  
 Catalog #: FMN-R-21-FC22-1C-120-S-WH  
 Efficiency: 62%  
 Test #: 15379.0

**CANDLEPOWER DISTRIBUTION**

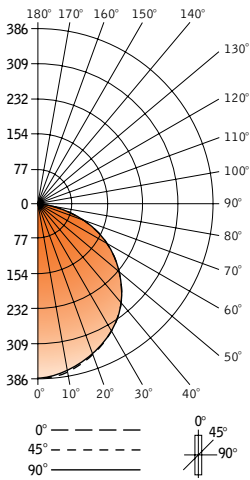

| Vertical Angle | Horizontal Angle |       |     |       | Zonal Lumens |
|----------------|------------------|-------|-----|-------|--------------|
|                | 0°               | 22.5° | 45° | 67.5° |              |
| 0°             | 386              | 386   | 386 | 386   | 386          |
| 5°             | 383              | 383   | 383 | 376   | 380          |
| 15°            | 365              | 365   | 364 | 365   | 363          |
| 25°            | 338              | 338   | 340 | 341   | 339          |
| 35°            | 306              | 303   | 303 | 304   | 305          |
| 45°            | 260              | 260   | 260 | 260   | 261          |
| 55°            | 205              | 204   | 204 | 205   | 207          |
| 65°            | 140              | 142   | 140 | 140   | 140          |
| 75°            | 74               | 77    | 74  | 74    | 79           |
| 85°            | 21               | 20    | 22  | 21    | 23           |
| 90°            | 6                | 5     | 7   | 6     | 6            |
| 95°            | 0                | 0     | 0   | 0     | 0            |
| 105°           | 0                | 0     | 0   | 0     | 0            |
| 115°           | 0                | 0     | 0   | 0     | 0            |
| 125°           | 0                | 0     | 0   | 0     | 0            |
| 135°           | 0                | 1     | 0   | 0     | 2            |
| 145°           | 0                | 0     | 0   | 0     | 0            |
| 155°           | 0                | 0     | 0   | 0     | 0            |
| 165°           | 0                | 0     | 0   | 0     | 0            |
| 175°           | 0                | 0     | 2   | 0     | 0            |
| 180°           | 0                | 0     | 0   | 0     | 0            |

Spacing 1.2  
 Criterion: 1.3

**LUMEN SUMMARY**

| Zone                   | Lumens      | % Lamp      | % Fixt       |
|------------------------|-------------|-------------|--------------|
| 0°-30°                 | 297         | 16.5        | 26.6         |
| 0°-90°                 | 1114        | 61.9        | 100.0        |
| 90°-130°               | 0           | 0           | 0            |
| 90°-180°               | 0           | 0           | 0            |
| <b>Total Luminaire</b> | <b>1115</b> | <b>61.9</b> | <b>100.0</b> |

**LUMINANCE DATA (CD/M<sup>2</sup>)**

| Vertical Angle | 0°   | 45°  | 90°  |
|----------------|------|------|------|
| 45°            | 1468 | 1414 | 1420 |
| 55°            | 1427 | 1347 | 1367 |
| 65°            | 1323 | 1223 | 1223 |
| 75°            | 1142 | 999  | 999  |
| 85°            | 962  | 702  | 670  |

**CO-EFFICIENTS OF UTILIZATION**

| Floor        | 80        | 70        | 20        | 50        | 30        | 10        | 00        |
|--------------|-----------|-----------|-----------|-----------|-----------|-----------|-----------|
| Ceiling      | 70        | 50        | 10        | 50        | 10        | 50        | 10        |
| Wall         | 74        | 74        | 74        | 72        | 72        | 69        | 69        |
| <b>RCR 0</b> | <b>68</b> | <b>65</b> | <b>62</b> | <b>60</b> | <b>66</b> | <b>64</b> | <b>59</b> |
| 1            | 62        | 57        | 53        | 50        | 60        | 56        | 49        |
| 2            | 57        | 50        | 46        | 42        | 55        | 50        | 41        |
| 3            | 52        | 45        | 39        | 35        | 51        | 44        | 35        |
| 4            | 47        | 39        | 34        | 30        | 46        | 39        | 30        |
| 5            | 44        | 35        | 30        | 26        | 42        | 35        | 26        |
| 6            | 40        | 32        | 26        | 22        | 39        | 31        | 22        |
| 7            | 37        | 28        | 23        | 19        | 36        | 28        | 19        |
| 8            | 34        | 25        | 20        | 17        | 33        | 25        | 17        |
| 9            | 31        | 3         | 19        | 15        | 32        | 23        | 15        |
| 10           | 31        | 3         | 19        | 15        | 32        | 23        | 15        |

Numbers indicate percentage values of reflectivity.

Go to [www.focalpointlights.com](http://www.focalpointlights.com) for additional photometric data.

recessed  
**mondana™**



Filename: FMNR26FC40.IES  
 Catalog #: FMN-R-26-FC40-1C-120-S-WH  
 Efficiency: 57%  
 Test #: 15381.0

**CANDLEPOWER DISTRIBUTION**

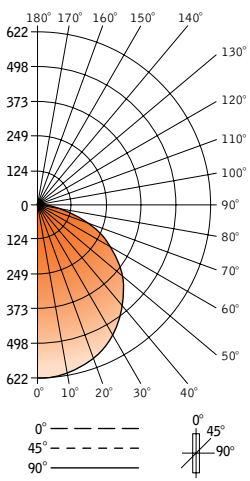

| Vertical Angle | Horizontal Angle |       |     |       | Zonal Lumens |
|----------------|------------------|-------|-----|-------|--------------|
|                | 0°               | 22.5° | 45° | 67.5° |              |
| 0°             | 622              | 622   | 622 | 622   | 622          |
| 5°             | 620              | 620   | 621 | 620   | 620          |
| 15°            | 602              | 603   | 603 | 603   | 60           |
| 25°            | 564              | 562   | 561 | 562   | 562          |
| 35°            | 506              | 507   | 504 | 502   | 506          |
| 45°            | 435              | 433   | 431 | 429   | 432          |
| 55°            | 344              | 337   | 338 | 340   | 339          |
| 65°            | 244              | 240   | 241 | 241   | 235          |
| 75°            | 127              | 125   | 126 | 126   | 120          |
| 85°            | 28               | 32    | 31  | 31    | 30           |
| 90°            | 5                | 7     | 5   | 6     | 6            |
| 95°            | 0                | 0     | 0   | 0     | 0            |
| 105°           | 0                | 0     | 0   | 0     | 0            |
| 115°           | 0                | 0     | 0   | 0     | 0            |
| 125°           | 0                | 0     | 0   | 0     | 0            |
| 135°           | 0                | 0     | 0   | 0     | 0            |
| 145°           | 0                | 0     | 0   | 0     | 0            |
| 155°           | 0                | 0     | 0   | 0     | 0            |
| 165°           | 0                | 0     | 0   | 0     | 0            |
| 175°           | 0                | 0     | 0   | 0     | 0            |
| 180°           | 0                | 0     | 0   | 0     | 0            |

Spacing 1.3  
 Criterion: 1.3

**LUMEN SUMMARY**

| Zone                   | Lumens      | % Lamp      | % Fixt       |
|------------------------|-------------|-------------|--------------|
| 0°-30°                 | 490         | 15.3        | 26.5         |
| 0°-90°                 | 1850        | 57.8        | 100.0        |
| 90°-130°               | 0           | 0           | 0            |
| 90°-180°               | 0           | 0           | 0            |
| <b>Total Luminaire</b> | <b>1850</b> | <b>57.8</b> | <b>100.0</b> |

**LUMINANCE DATA (CD/M<sup>2</sup>)**

| Vertical Angle | 0°   | 45°  | 90°  |
|----------------|------|------|------|
| 45°            | 1626 | 1570 | 1574 |
| 55°            | 1585 | 1502 | 1506 |
| 65°            | 1526 | 1428 | 1392 |
| 75°            | 1297 | 1173 | 1117 |
| 85°            | 849  | 725  | 702  |

**CO-EFFICIENTS OF UTILIZATION**

| Floor        | 80        | 70        | 20        | 50        | 30        | 10        | 00        |
|--------------|-----------|-----------|-----------|-----------|-----------|-----------|-----------|
| Ceiling      | 70        | 50        | 10        | 50        | 10        | 50        | 10        |
| Wall         | 69        | 69        | 69        | 67        | 67        | 64        | 64        |
| <b>RCR 0</b> | <b>63</b> | <b>61</b> | <b>58</b> | <b>56</b> | <b>62</b> | <b>59</b> | <b>58</b> |
| 1            | 58        | 53        | 49        | 46        | 56        | 52        | 46        |
| 2            | 53        | 47        | 43        | 39        | 52        | 46        | 39        |
| 3            | 49        | 42        | 37        | 33        | 47        | 41        | 33        |
| 4            | 44        | 37        | 32        | 28        | 43        | 36        | 28        |
| 5            | 41        | 33        | 28        | 24        | 39        | 32        | 24        |
| 6            | 37        | 30        | 24        | 21        | 36        | 29        | 21        |
| 7            | 34        | 26        | 21        | 18        | 33        | 26        | 18        |
| 8            | 32        | 24        | 19        | 16        | 31        | 23        | 15        |
| 9            | 29        | 21        | 17        | 14        | 29        | 21        | 14        |
| 10           | 29        | 21        | 17        | 14        | 29        | 21        | 14        |

Numbers indicate percentage values of reflectivity.

Go to [www.focalpointlights.com](http://www.focalpointlights.com) for additional photometric data.