

### ASSEMBLY AND INSTALLATION:

**TURN OFF POWER FROM THE MAIN CIRCUIT BEFORE INSTALLING FIXTURE.**

Parts List:

- 2 x Saber Fixture
- 1 x Articulating Joint
- 2 x ¼-20 Set Screw

#### Step 1: Slide Fixture into Articulating Joint

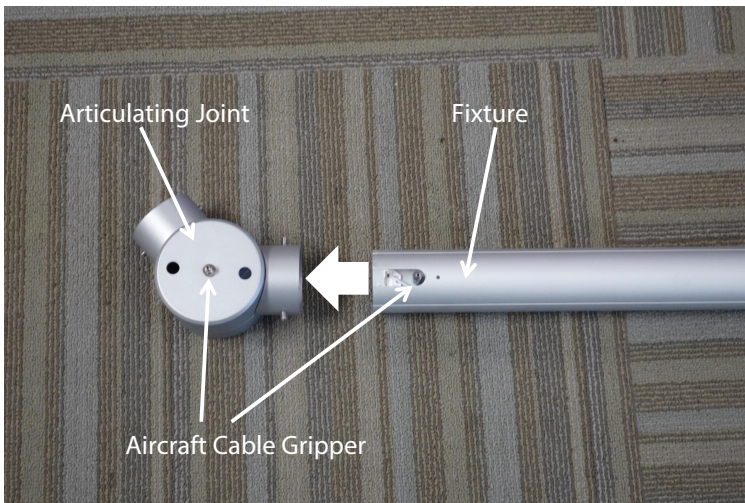

#### Step 2: Tighten Set Screws on Articulating Arm

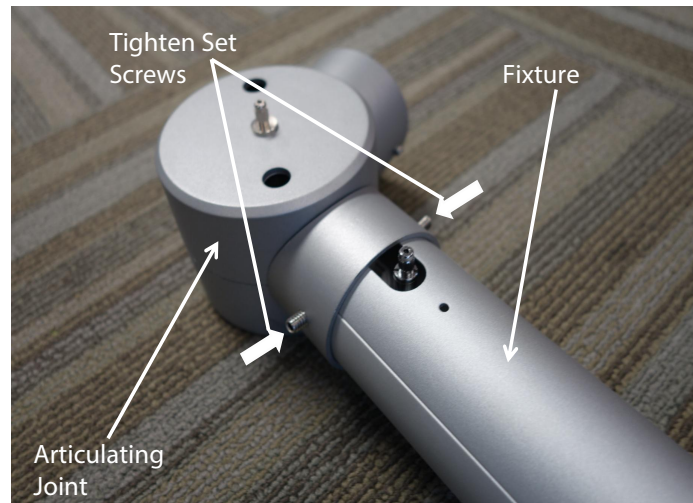

#### Step 3: Use Aircraft Cable Grippers to Mount Fixture

