

DRIVER SPECIFICATIONS FOR 12168-11



DRIVER SPECIFICATIONS FOR 12168-11

Features

- Class 2 compliance
- Universal input voltage 120~277V AC
- 0~10V dimmable

- AC Input Voltage:** 120~277V AC,
DC Output Voltage: 50/60Hz 24V DC
DC Output Current: 4A
Output Wattage: 96W
Dimming Function: 0-10V dimmable
Max. Case Temperature: 80°C (176°F)
Approval: RoHS compliant

Approval:



* Consult factory for wiring length and details.

* Caution: Do not install on-off switch at the output (load) side of a constant current LED driver as it will damage the fixture(s). Warranty will be void on both driver and fixture(s).

Driver Dimension:

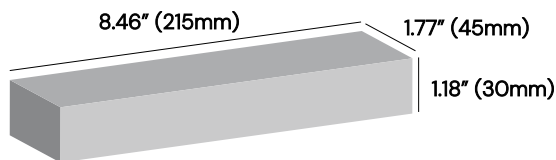

Enclosure Dimensions:

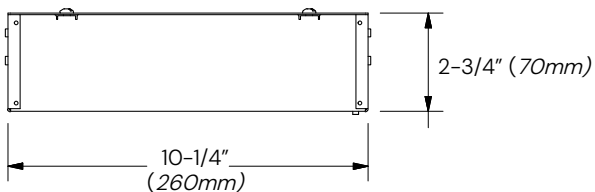
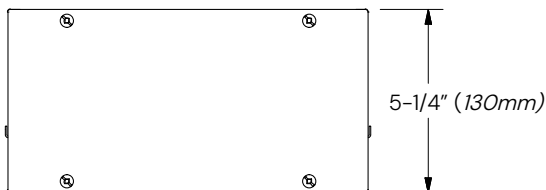

Order Code	Enclosure
<u>LED100W24VZ-01</u>	<u>B</u>

B = drive enclosure (10-1/4" X 5-1/4" X 2-3/4" or 260mm X 130mm X 70mm)