

Project Name:

Type:

Quantity:

FIXTURE SPECIFICATIONS

INTENDED USE

The Alcon Lighting 6022 LST architectural fluorescent linear surface or pendant-mount square louver is a baffled luminaire suitable for damp locations and is available with electronic ballast options. The LST Series is ideal for lighting applications such as long narrow corridors, aisles, and libraries.

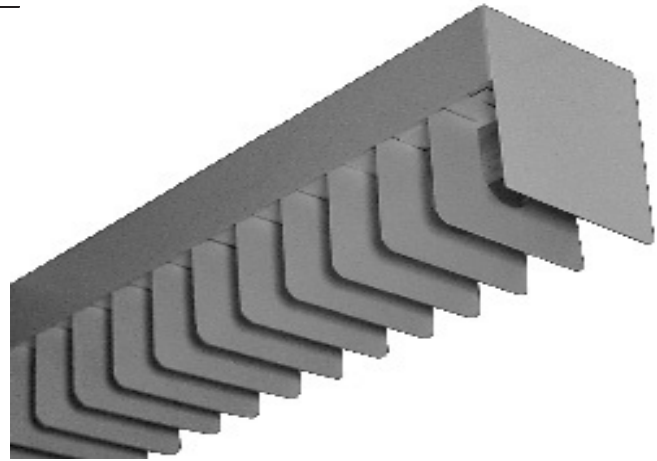

FEATURES

4 FT - W 6" x L 48" x H 5.5"

8 FT - W 6" x L 96" x H 5.5"

Construction: 22 gauge cold rolled steel welded housing. Row mountable.

Finish: Baked white powder-coated finish

Type: Baffled

Voltage: 120-277V

Listings: Suitable for Damp locations

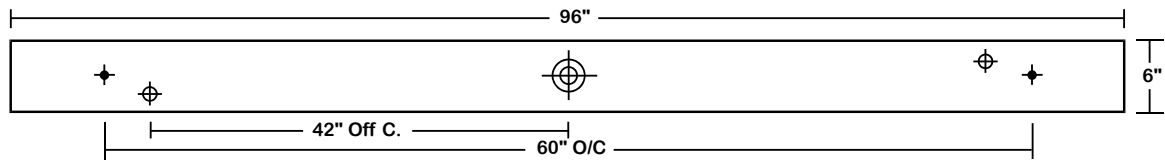
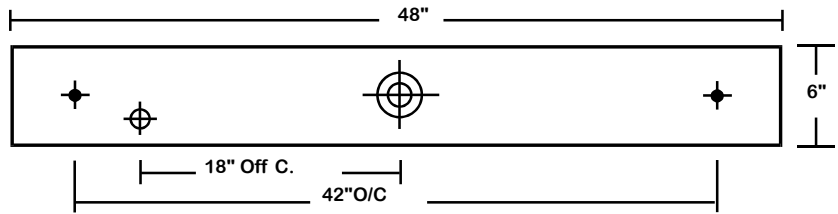
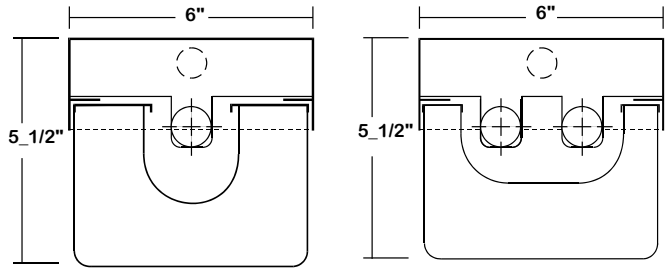

ORDERING INFORMATION Example: (6022-P-4-T8-AC48)

Model	Profile	Size	Lamps	Pendant Mounting	Options
6022	S Surface	4 4'	T5 2 Lamps (for 4) 4 Lamps (for 8)	AC48 48" Adjustable Aircraft Cable	EM Emergency Battery Pack
	P Pendant	8 8'			
			T8 2 Lamps (for 4) 4 Lamps (for 8)	AC96 96" Adjustable Aircraft Cable	
				ST24 24" Stem	