

FEATURES & SPECIFICATIONS

INTENDED USE

The **Alcon Lighting 6022 LST Architectural Fluorescent Linear Surface Mount Square Louver** is a baffled luminaire suitable for damp locations and is available with electronic ballast options. The LST Series is ideal for lighting applications such as long narrow corridors, aisles, and libraries.

DETAILS

4 FT - W 6" x L 48" x H 5.5"

8 FT - W 6" x L 96" x H 5.5"

Construction: 22 gauge cold rolled steel welded housing

Finish: Baked white powder coated finish
Row Mountable

ADDITIONAL FEATURES

Type: Baffled

Voltage: 120-277

Listings: Suitable for Damp locations

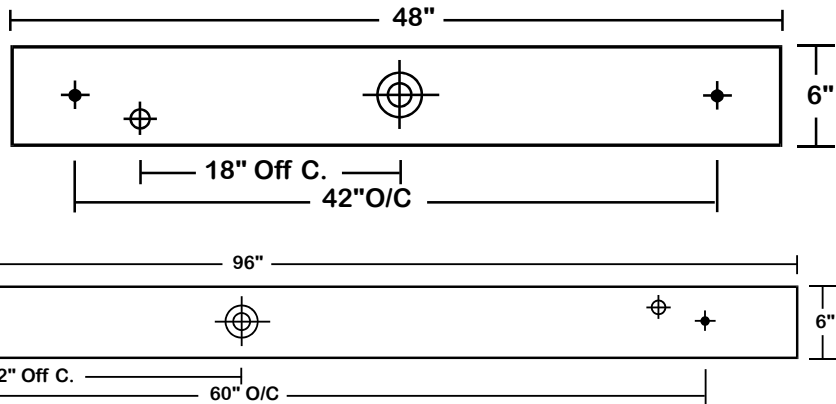
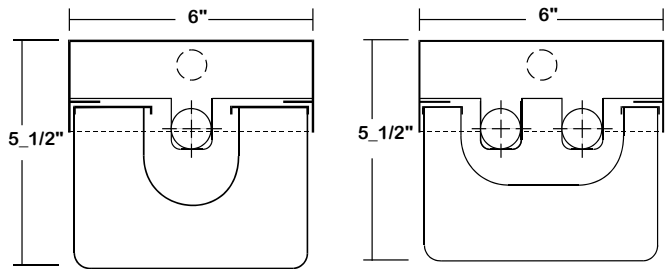
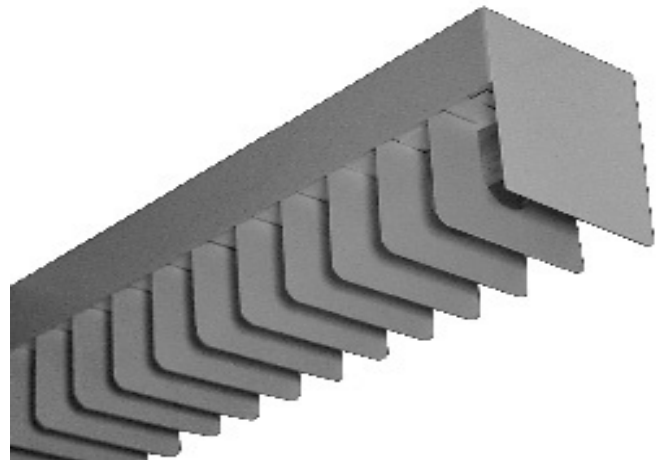

Ordering Information:

Example: (6022-4-T5-EM)

Model	Size	Lamps	Options
6022	4 4'	T5 2 Lamps (for 4')	EM Emergency Battery Pack
	8 8'	4 Lamps (for 8')	
		T8 2 Lamps (for 4')	
		4 Lamps (for 8')	