

24000-F FLANGE KIT INSTALLATION INSTRUCTIONS

FLANGE KIT:

- Flange kit used in the field to convert a standard grid troffer to a flanged troffer.
- Side and end rails are extruded aluminum finished in white powder coating. Corner clips are zinc plated steel.
- For any Alcon Lighting recessed troffer or parabolic suitable for installation in 15/16" inverted T-bar grid, in a drywall or plaster ceiling.
- Easily install without the use of tools. Smooth edges for easy handling.

INSTALLATION:

- Cut ceiling opening to proper dimensions. Ceiling opening required is nominal width and length plus 3/8".
- Slip fit (snap-lock) corner clips into side and end rails.
- Place assembled Flange Kit in ceiling opening and wire support each corner to ceiling structure. (at four corners as shown)
- Pull up tight against ceiling.
- Place grid trim troffer in flange kit.

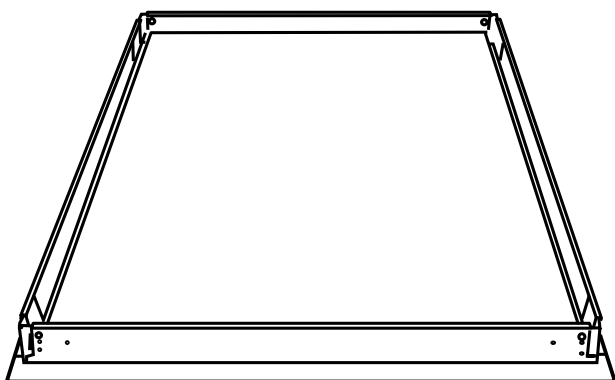

CEILING OPENING		
SIZE	WIDTH	LENGTH
1'X2'	12-3/8" (314mm)	24-3/8" (619mm)
1'X4'	12-3/8" (314mm)	48-3/8" (1229mm)
2'X2'	24-3/8" (619mm)	24-3/8" (619mm)
2'X4'	24-3/8" (619mm)	48-3/8" (1229mm)

All dimensions are in inches (millimeters).

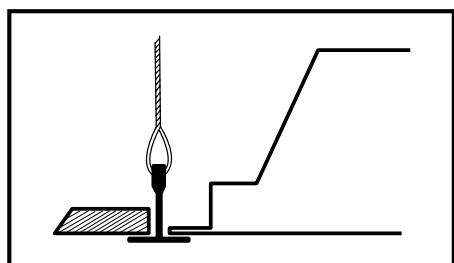
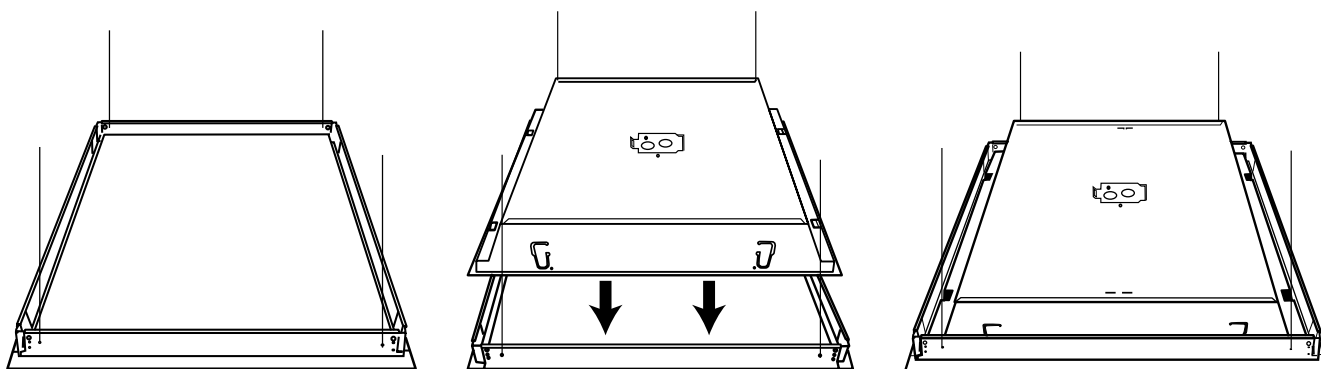

Flange Kit in ceiling opening and wire support each corner to ceiling structure. (at four corners as shown)