

FEATURES & SPECIFICATIONS

INTENDED USE

The **iLED 1x4 Architectural LED Surface Mount Recessed Troffer** is a Specification Grade low profile fixture and is the ideal solution for commercial and industrial applications looking for comfortable, bright lighting, enhanced energy savings, long life, and easy and economical maintenance. The iLED Architectural LED Surface Mount Recessed Troffer offers the flexibility to easily change wattage, lumens, and color temperature.

DETAILS

W 11.75" x **L** 48" x **Dp** 3.75"

Construction: Die-formed and embossed code 22 gauge steel housing

Finish: High reflectance baked white enamel

Lens: Clear 0.10 thick A12 Acrylic

ADDITIONAL FEATURES

Voltage: 120-277 UNV

Wattage 36W (2x18W)

Lumens: 4200 lms

Support: Direct Surface Mount

Life: 50,000 Hrs

Operating Temp: -20°C to 50°C
Lamp Included

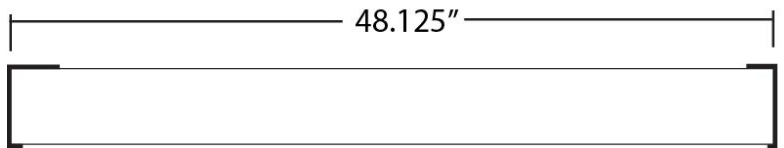
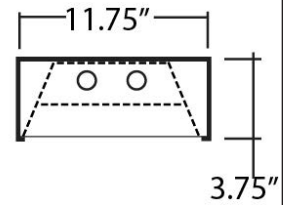

Ordering Information:

Example: (14056-30K-010-EM)

Model	Color Temp	Dimming	Finish	Options
<input type="text" value="14056"/>	<input type="text" value="30K 3000K"/> <input type="text" value="40K 4000K"/> <input type="text" value="50K 5000K"/>	<input type="text" value="(Blank)"/> Non-Dimming (Standard) <input type="text" value="010"/> 0-10V Dimming (5-Wire)	<input type="text" value="(Blank)"/> White <input type="text" value="BK"/> Black <input type="text" value="SL"/> Silver <input type="text" value="BZ"/> Bronze	<input type="text" value="EM"/> Emergency Backup Battery

¹Only available with 0-10V Dimming