

Project Name:

Type:

Quantity:

FIXTURE SPECIFICATIONS

INTENDED USE

Designed for mounting on ceilings and other surfaces, our architectural-grade wraparound healthcare lighting product offers an economical, efficient and low-profile choice for doctor's or dental offices, hospitals and other medical facility applications. The fully enclosed linear ceiling surface or pendant light is finished with antimicrobial white paint to resist bacteria, rust and corrosion. The 12516-S or 12516-P downlight, die-formed and welded in 22-gauge cold rolled steel and assembled in America, yields diffused, moderate illumination.

FEATURES

Construction: Die-formed and welded 22-gauge cold rolled steel

Continuous Row: Steel end plates with 7/8" KO standard for continuous row mounting

Finish: White antimicrobial finish

Lens: Frosted acrylic lens

Voltage: 120-277V, 50/60 Hz

Ambient Operating Temperature: 22°F (-30°C) ~ 122°F (50°C)

Life: 54,000 hours

Warranty: 5 year carefree for parts & components (Labor Not Included)

Listing: DLC, cULus, EM battery backup is CEC compliant, Damp location



Narrow

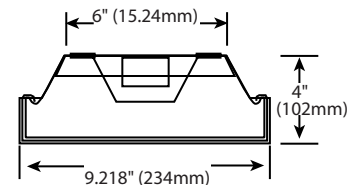

Wide

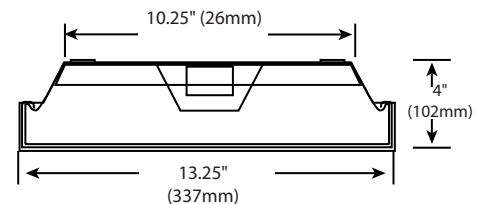

ORDERING INFORMATION Example: (12516-S-N-2-18-27K-9-010)

Model	Mounting	Body	Length Wattage Lumen	Color Temp	CRI	Dimming	Warranty	Options
12516	S Surface P Pendant	N <small>Standard</small> Narrow W Wide	2-18 2FT 18 Watts 2126 lms 2-25 2FT 25 Watts 2953 lms 2-36 2FT 36 Watts 4253 lms 4-18 4FT 18 Watts 2126 lms 4-25 4FT 25 Watts 2953 lms 4-36 4FT 36 Watts 4253 lms 4-54 4FT 54 Watts 6379 lms 4-72 4FT 72 Watts 8506 lms 8-72 8FT 72 Watts 8506 lms 8-108 8FT 108 Watts 12759 lms	27K ¹ 2700K 30K 3000K 35K 3500K 40K 4000K 50K 5000K <small>Tunable White</small> TW2065 ² Tunable White 2000-6500K TW2750 ² Tunable White 2700-5000K	8 80+ 9 90+	010 0-10V 10%-100% BLS Bi-Level Step Dimming 50%/100% BLSXX Bi-Level Step Dimming Replace X with Percentage from 10%-90% TLS Tri-Level Step Dimming 30%/70%/100% TLSXX Tri-Level Step Dimming Replace X and X with Percentages from 10%-90% 050 Tunable White 0-10V	Blank <small>Standard</small> 5 Year Warranty W7 7 Year Warranty W10 10 Year Warranty	EM5 5W EM Battery Backup EM7 7W EM Battery Backup

¹ Must be paired with 90+ CRI option
² Must be paired with 050 driver