

STEM MOUNT INSTALLATION INSTRUCTIONS

- 1 Pull electrical wires from cylinder through stem.

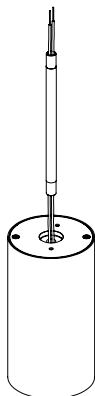

- 2 Thread stem into hole on top of cylinder until secure.

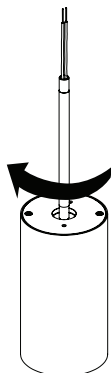

- 3 Insert stem through canopy. Thread swivel ball onto stem until secure and tighten set screw to ensure it is locked into place.

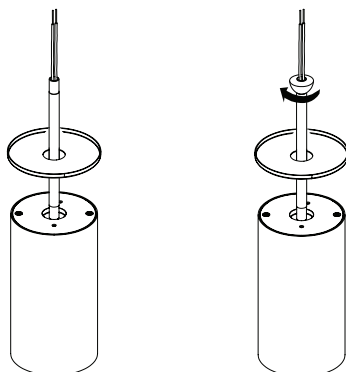

- 4 Attach bracket to junction box with two (2) screws (not provided).
Note: Compatible with 3" octagonal, 3" round metallic, 3" round non-metallic old-work, 3" round non-metallic new-work, 4" octagonal, 4" round and 4" square junction box.

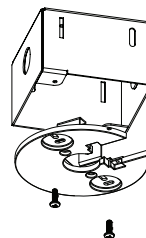

- 5 Make wire connections to electrical circuit in accordance with local and NEC standards.

- 6 Insert assembled stem into bracket opening, then slide stem to center of bracket. Allow swivel ball to rest on top of bracket.

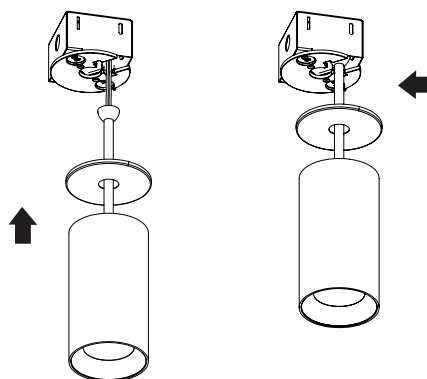

- 7 Screw bracket plate to bracket with two (2) screws (provided) to cover bracket opening.

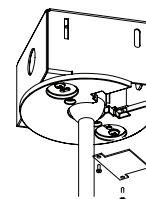

- 8 Raise canopy onto junction box. Canopy will attach to bracket magnetically.

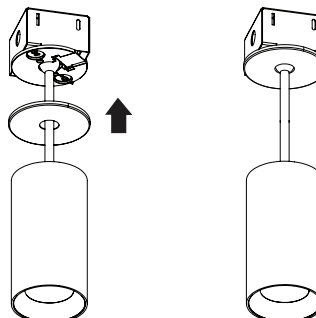

CORD MOUNT INSTALLATION INSTRUCTIONS

- 1 Make wire connections to electrical circuit in accordance with local and NEC standards.
- 2 Set cord length using adjustable cord grip.
Note: If adjustment is made, safety clamp (included) must be used.
- 3 Attach bracket to junction box with two (2) screws (not provided).
Note: Compatible with 3" octagonal, 3" round metallic, 3" round non-metallic old-work, 3" round non-metallic new-work, 4" octagonal, 4" round and 4" square junction box.

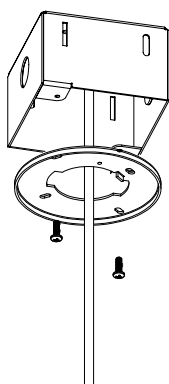

- 4 Raise canopy onto junction box. Canopy will attach to bracket magnetically.

