

**WARNING:** Disconnect main power at the source prior to installation! Only qualified electricians should install Alcon Lighting products.

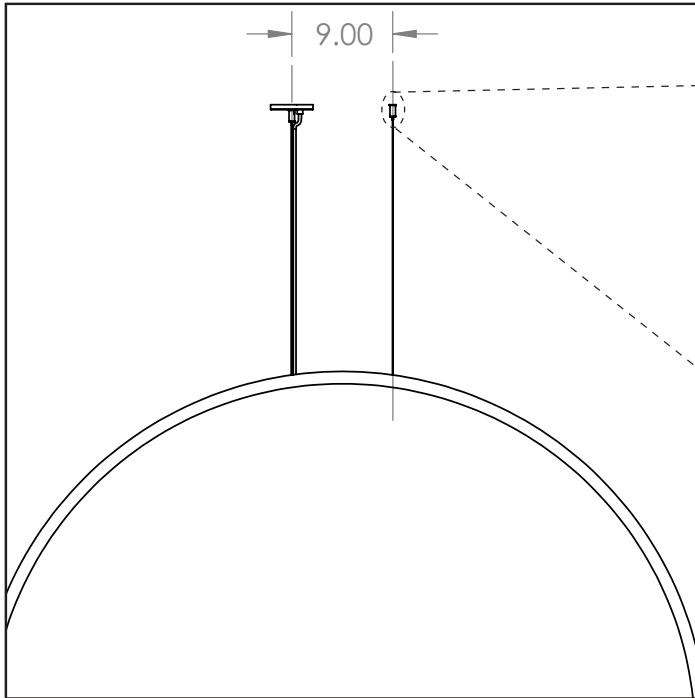

Maximum Wiring Distance  
(at full load)

Wire Size (AWG)	Distance (feet)
18	18
16	29
14	46
12	71
10	120

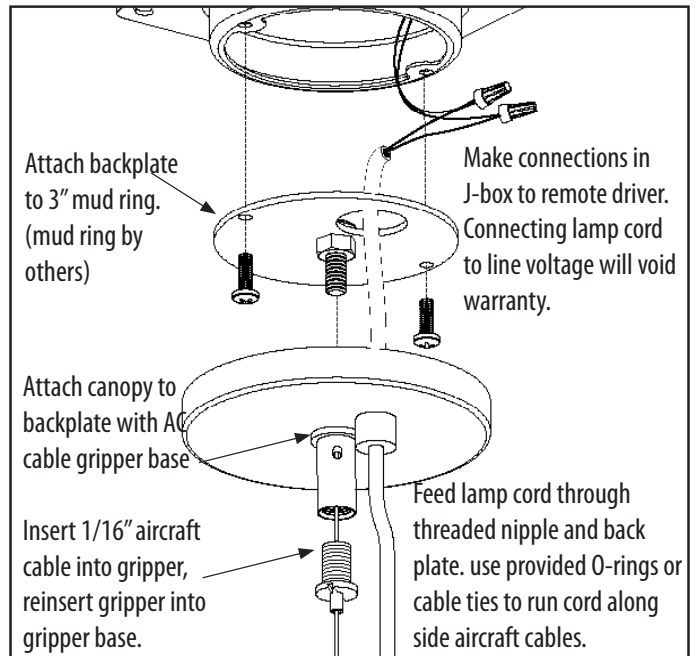
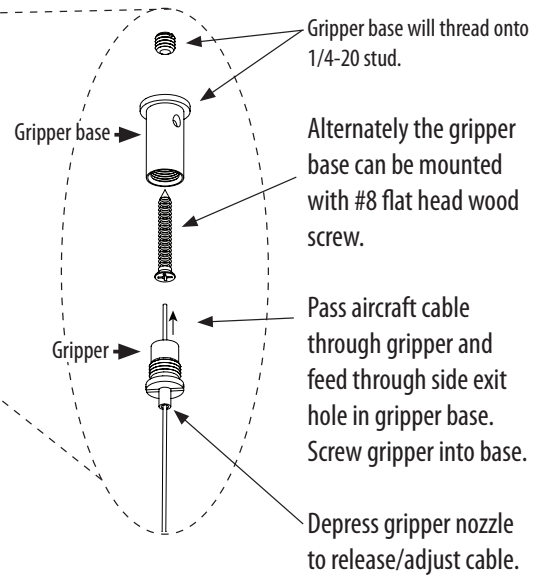

### Direct Only wiring:

Red to DC positive  
Blue to DC negative

### Direct/Indirect wiring:

Red to DC positive  
Blue to DC negative

Red/White to DC positive  
Blue/White to DC negative

Driver one

Driver two

### Dimming:

Purple and Gray wires from driver to 0-10V dimmer, cap if not used

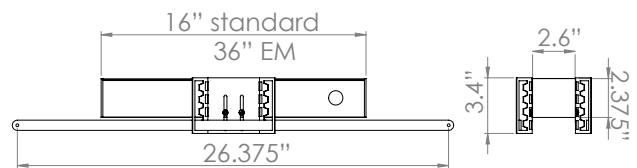

Remote driver housing comes with bar hangers for mounting above a suspended ceiling, drivers must remain accessible after finished installation. Driver housings must not be mounted closer than 4 inches apart. Bar hangers and brackets can be removed for direct mounting to structure with screws. Connect J-box to Driver housing with conduit by others.