

## FIXTURE SPECIFICATIONS

### INTENDED USE

The Ashton Architectural LED Pendant Lighting Direct/Indirect Light Fixture delivers continuous clean lines and clear light to commercial, hospitality and residential interior lighting applications. Our modern, slim profiles and stylish linear chandelier designs offer excellent direct and indirect lighting and exceptional performance and versatility in offices, classrooms, conference rooms, museums, retail outlets, hotels, restaurants, and more. The integrated LED is available in standard lengths of 4', 8', and 12', and can be joined together in seamless runs of any length.

### FEATURES

**Construction:** Die-Formed 20 Gauge Cold-Rolled Steel

(Flat End Steel Plate Standard Die-Cast Aluminum Decorative End Cap Optional)

**Continuous Row:** Full Ability to Tandem Mount for Continuous Run Application, Equipped with Male & Female Quick Connect Harnesses

**Light Distribution:** 6% Down / 94% Up

**Reflector:** Die-Formed, High-Reflective

**Lens:** Semi-Specular Aluminum Louver

**Electrical:** Constant Current, Class 2

**Voltage:** 120-277V (347V and 480V Available for Canadian Projects, Consult Factory)

**CRI:** 80+ (90+ available, Consult Factory)

**Power Factor:** > .9

**Life:** 60,000 Hours L70

**Operating Temperature:** -22°F (-30°C) - 122°F (50°C)

**Emergency Lumens:** System Lumens x Emergency Wattage / System Wattage

**Warranty:** 5 Years Carefree for Parts & Components (Labor Not Included)

**Listings:** UL Listed for Dry & Damp Location



DEC - Shown without Decorative End Cap

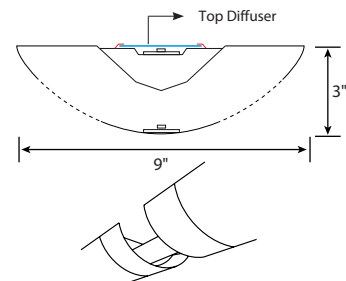

A non-lit continuous coupler is provided for continuous runs with decorative end caps

## ORDERING INFORMATION Example: (12106-60W-30K-WH-010-AC48)

Model	Length   Wattage   Lumens	Color Temp	CRI	Finish	Pendant Mounting	Dimming	Options	Optional Controls
<b>12106</b>	<b>2-30</b>	<b>30K</b>	<b>8</b> <small>Standard</small>	<b>WH</b> <small>Standard</small>	<b>AC4</b>	<b>010</b> <small>Standard</small>	<b>Blank</b>	<b>Blank</b>
	2FT   30W   4144 lms	3000K	80+ CRI	White	4' Adjustable Aircraft Cable	0-10V 1%	No Options	No Controls
	<b>2-36</b>	<b>35K</b>	<b>9</b>	<b>BK</b>	<b>AC8</b>	<b>TRI</b>	<b>EM5</b>	<b>LV</b>
	2FT   36W   4332 lms	3500K	90+ CRI	Black	8' Adjustable Aircraft Cable	TRIAC (120V)	5W Emergency Ballast	Lutron
	<b>2-36</b>	<b>40K</b>		<b>SL</b>	<b>ACX</b>	<b>ELV</b>	<b>EM8</b>	<b>VIVE™</b> Wireless
	2FT   40W   4884 lms	4000K		Silver	Specify X in Feet (Max 30')	Electronic Low Voltage	8W Emergency Ballast	PH
	<b>3-45</b>	<b>50K</b>		<b>XXXX</b>		<b>ES566</b>	<b>EM16</b>	<b>PH</b>
	3FT   45W   6213 lms	5000K		Specify XXXX: Use RAL # found on Page 2		eldoLED 0-10V SOLOdrive	16W Emergency Ballast	Philips EasySense™
	<b>3-54</b>					<b>BLS</b>	<b>OS</b>	<b>EN</b>
	3FT   54W   6489 lms					Bi-Level Step 40/100%	Occupancy Sensor w/ Daylight Harvesting	Siemens Enlightened™
	<b>3-60</b>					<b>BLS<del>XX</del></b>	<b>DS</b>	
	3FT   60W   7320 lms					Bi-Level Step <del>XX</del> /100%	Daylight Dimming Photo Sensor	
	<b>4-23</b>					<b>TLS</b>	<b>AB</b>	
	4FT   23W   3052 lms					Tri-Level Step 30/70/100%	Separate Dimming Control of Uplight and Downlight	
	<b>4-60</b>					<b>TLS<del>XXZZ</del></b>	<b>EC<sup>1</sup></b>	
	4FT   60W   8288 lms					Tri-Level Step <del>XX</del> / <del>ZZ</del> /100%	Decorative End Cap 1.5" Width	
	<b>4-72</b>						<b>ILD</b>	
	4FT   72W   8664 lms						Indirect Light Diffuser for Close to Ceiling Applications	
	<b>4-81</b>							
	4FT   81W   9768 lms							
	<b>8-120</b>							
	8FT   120W   16568 lms							
	<b>8-144</b>							
	8FT   144W   17312 lms							
	<b>8-162</b>							
	8FT   162W   19528 lms							
	<b>12-180<sup>1</sup></b>							
	12FT   180W   24828 lms							
	<b>12-216<sup>1</sup></b>							
	12FT   216W   25980 lms							
	<b>12-243<sup>1</sup></b>							
	12FT   243W   29304 lms							

<sup>1</sup> A non-lit continuous coupler is provided for continuous runs with decorative end caps



## Available Finishes

### Standard

	Matte White	RAL #9003
--	-------------	-----------

Set up fee and longer lead time will be applied on non-standard finishes.





### Metropolitan

	Black	RAL #9011
	Silver	RAL #9022
	Urban Native	RAL #8025
	Military Green	RAL #6011
	Carmin	RAL #8028
	Chocolate Spice	RAL #8017
	Asher Grey	RAL #7004
	Tech Grey	RAL #7016
	Slate	RAL #7031
	Mason	RAL #7039

### Vibrant

	Violet Dreams	RAL #4006
	Sangria Sunset	RAL #2004
	Deep Pink	RAL #4010
	Ruby Red	RAL #3027
	Island Skye	RAL #6027
	Sophia	RAL #5015
	Antique Spring	RAL #6019
	Daisy	RAL #1018
	Gun Metal	RAL #7024

## Controls

Smart Sensors	Protocol	Compatible Networks	Occupancy	Daylight	Temperature Reporting	Communication to Luminaire
	Enlighted RF	Enlighted RF	Integrated	Integrated	Yes	Wireless
	EcoSystem	Quantum, Energi Savr Node, Energi TriPak	Enabled	Enabled	No	Wired
	Lutron Clear Connect*	Lutron Vive System Network	Enabled	Enabled	No	Wireless
	ZigBee HA	Philips	Enabled	Enabled	No	Wired



## Controls Installed on the Fixture



**FCJS-010**  
Individual  
Fixture Control

Fixture Will be Shipped LUTRON VIVE Enabled with LUTRON FCJS-010 0-10V Control Module Installed on the Fixture. Fixtures will be compatible with Lutron FC-SENSOR Occupancy/Daylight Sensor or FC-VSENSOR Vacancy/Daylight Sensor which can be Added in the Field for Remote Mounting. Fixture May be Controlled with any Vive control systems. Fixtures must be ordered with a 0-10V. Driver.



**FCJS-ECO**  
Individual  
Fixture Control

Fixture Will be Shipped LUTRON VIVE Enabled with LUTRON FCJS-ECO EcoSystem Control Module Control Module Installed on the Fixture. Fixtures will be compatible with Lutron FC-SENSOR Occupancy/Daylight Sensor or FC-VSENSOR Vacancy/Daylight Sensor which can be Added in the Field for Remote Mounting. Fixture May be Controlled with any Vive control systems. Fixtures must be ordered with a Lutron Driver.

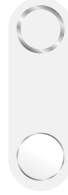

### DFCSJ-OEM-OCC

Fixture Will be Shipped LUTRON VIVE Enabled with DFCSJ-OEM-OCC\* Vive Integral Fixture Control (with Sensing) Installed on the Fixture. Fixture May be Controlled with any Vive control systems. Fixtures must be ordered with a DMX or Lutron EcoSystem Driver

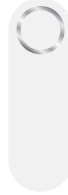

### DFCSJ-OEM-RF

Fixture Will be Shipped LUTRON VIVE Enabled with LUTRON DFCSJ-OEM-RF\* Vive Integral Fixture Control (RF Only) Installed on the Fixture. Fixture May be Controlled with any Vive control systems. Fixtures must be ordered with a DMX or Lutron EcoSystem Driver.

## Controls Provided by Lutron



Vive Wireless Hub



DayLight  
Sensor



Ceiling Mount  
Occupancy/Daylight  
Sensor



Ceiling Mount  
Occupancy Sensor



Pico  
Remote



Wall Mount  
Switch



Wall Mount  
Occupancy Sensor

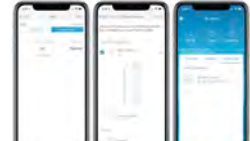

Lutron App



Fixture will be shipped with Leviton ZL027-N0W power control module installed on the fixture. Fixtures will be compatible with Leviton ZL00J-D0W sensor control module which can be added in the field for remote mounting. Fixture must be controlled with Leviton Intellect Keypad Room Controller, or Leviton Neuron App.



**ZL027-N0W**  
Power control module



**ZL00J-D0W**  
Sensor control module

## Leviton Keypad



**ZLDNK-1W**



**ZLDNK-2W**



**ZLDNK-4W**



**ZLDNK-8W**

Intellect™ Keypad Room  
Controller (Required)

## Leviton App



Neuron App



Philips EasySense sensors provide luminaire-level control with Occupancy sensing, Daylight harvesting, and Field task tuning.

## Controls Installed on the Fixture



### PHILIPS-XSR + SNS200

Fixture will be Shipped with EasySense SNS200 Sensor installed and PHILIPS-XSR driver. Fixture May Only be Controlled with Philips Field App or Wireless Switches.



### SRB + SNS200

Fixture Will be Shipped with EasySense SNS200 Sensor installed and PHILIPS SRB Bridge. Fixture May Only be Controlled with Philips Field App or Wireless Switches or any 0-10V. Wall Box Dimmer.



## Controls Provided by Philips



ZBT-S1AWH



ZBT-S2AWH

Illumra Wireless Switches



### PHILIPS-XSR + SNS200-CMP

Fixture will be Shipped Sensor Ready with PHILIPS-XSR driver and EasySense SNS200-CMP Sensor which is Included to be Remote Mounted. Fixture May Only be Controlled with Philips Field App or Wireless Switches



### SRB + SNS200-CMP

Fixture Will be Shipped Sensor Ready with PHILIPS SRB Bridge and EasySense SNS200-CMP Sensor which is Included to be Remote Mounted. Fixture May Only be Controlled with Philips Field App or Wireless Switches or any 0-10V. Wall Box Dimmer.





### SRB

Fixture will be Shipped Sensor Ready with SRB Bridge . Fixture will be Compatible with EasySense Sensor SNS200-CMP which can be Added in the Field for Remote Mounting. Fixture May Only be Controlled with Philips Field App or Wireless Switches or any 0-10V. Wall Box Dimmer.



Philips Field App

## Compatible Dimmers

MFG	Triac	ELV	0-10
	TG-600P	DVELV-303P	NTSTV
	LG-600P	SELV-300P	NFTV
	TGCL-153P	MAELV-600	DVSTV
	DV-600P	FAELV-500	
	DVCL-153P		
	S-603PG		
	CT-103P		
	S-600P		
	6161	IPE04	IP710-DLZ
	6633-P	VPE06-1LZ	
	6683		
	6631-2		
	IPI06-1LZ		

## COLOR TEMPERATURE GUIDE



## Pendant Installation

A simple design and adjustable components provide a flexible and hassle-free experience when installing the Continuum Series™.

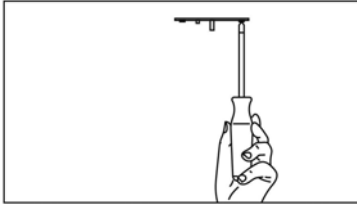

**Step 1:** Secure cross brackets to junction boxes for both power and non power mounting points.

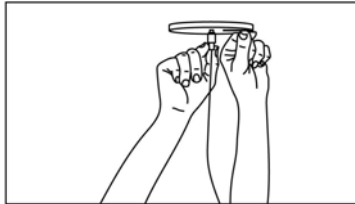

**Step 2:** Secure canopy with power canopy coupler (Power Feed Mount) & secure canopy with cable terminal (Non Power Feed Mount).



**Step 3:** Feed aircraft cable into cable grippers, adjust height and level luminaire.



**Step 4:** Unscrew outer coupler to allow access to junction box. Feed power cord through canopy.



**Step 5:** Secure canopy back in place with outer coupler.

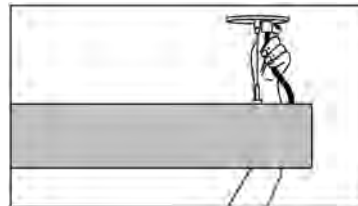

**Step 6:** Snap strain relief around power cord. Press into canopy.