

Project Name:

Type:

Quantity:

FIXTURE SPECIFICATIONS

INTENDED USE

Made in die-formed and welded 22-gauge, cold-rolled steel with the capacity to tandem mount for a continuous run application, our high-CRI LED product is made to last, making this direct/indirect light perfect for commercial, hospitality and residential interiors. Offered with pre-fabricated and fully illuminated corners and a frosted, acrylic glare-free lens that snaps in, the powerful, versatile commercial-grade product suits today's office, classroom, conference room, museum, retailer, hotel and restaurant.

PRODUCT FAMILY

- 12100-66-P** | Pendant Mount
- 12100-66-W** | Wall Mount
- 12100-66-S** | Surface Mount
- 12100-66-R** | Recessed Mount

AVAILABLE LENGTHS

- 4FT** | W 6" x L 48" x H 6"
- 8FT** | W 6" x L 96" x H 6"
- Continuous Run** | Consult Factory
- Custom Length** | Consult Factory

FEATURES

- Construction:** Die-formed and welded 22-gauge cold rolled steel
- Continuous Run:** Full ability to tandem mount for continuous run application equipped with male & female quick connect harnesses
- Mounting:** For most effective indirect lighting result, mount at no less than 18" from the Ceiling
- Custom Design:** Offered with pre-fabricated and fully illuminated corners
- Lens:** Glare-free snap-in frosted acrylic for even distribution
- Voltage:** 120-277V (50/60 Hz) Constant current
- Universal Dimming:** TRIAC (Forward-Phase), ELV (Reverse-Phase), 0-10V
- CRI:** 80+ & 90+
- Life:** 50,000 Hours L70
- Warranty:** 5 Years carefree for parts & components (Labor not included)
- Listings:** CA Title 24 Compliant, cETL Listed, LED Chips Tested to LM-80 Standards

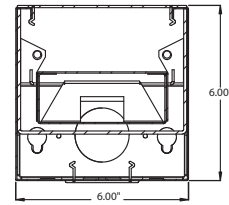

ORDERING INFORMATION Example: (12100-66-P-D-R24-S-4-AC48-WH-27K-010-EM-LV)

Model	Mount	Distribution	Lumen Output	Shape	Mounting	Finish	Color Temp
12100-66 6" x 6"	P Pendant	D Direct	Per 4 Foot Sections R24 24 watts 2400 lms	S Single Unit	AC48 Standard 48" Adjustable Cable AC144 ¹ 144" Adjustable Aircraft Cable (x2) ST24 ¹ 24" Stem (x2) STXX ¹ Custom Stem Length	WH White BK Black SL Silver Premium RD Red BL Blue GR Green OR Orange SB Satin Brass	27K ² 2700K 30K 3000K Commercial 35K 3500K 40K 4000K Industrial 50K 5000K
		I Indirect WW Wall Wash	R48 48 watts 4800 lms	CR Continuous Run			
		D/I Direct/Indirect	Per 4 Foot Sections R12D24 UP: 12 watts 1200 lms DOWN: 24 watts 2600 lms R18D36 UP: 18 watts 1800 lms DOWN: 36 watts 3600 lms	RC Rectangle			
				SQ Square			
				CU² Custom			

¹ 0.4" Thick 5-Conductor Power Cable (x1) + 5" Round Canopy (x2)
² 2700K Only Available for 90+ CRI
³ Required for D/I Distributions Only

Alcon 12100-66-P Linear Pendant-Mount LED Downlight

Project Name:

Type:

Quantity:

FIXTURE SPECIFICATIONS

INTENDED USE

Made in die-formed and welded 22-gauge, cold-rolled steel with the capacity to tandem mount for a continuous run application, our high-CRI LED product is made to last, making this direct/indirect light perfect for commercial, hospitality and residential interiors. Offered with pre-fabricated and fully illuminated corners and a frosted, acrylic glare-free lens that snaps in, the powerful, versatile commercial-grade product suits today's office, classroom, conference room, museum, retailer, hotel and restaurant.

PRODUCT FAMILY

- 12100-66-P** | Pendant Mount
- 12100-66-W** | Wall Mount
- 12100-66-S** | Surface Mount
- 12100-66-R** | Recessed Mount

AVAILABLE LENGTHS

- 4FT** | **W 6" x L 48" x H 6"**
- 8FT** | **W 6" x L 96" x H 6"**
- Continuous Run** | Consult Factory
- Custom Length** | Consult Factory



FEATURES

- Construction:** Die-formed and welded 22-gauge cold rolled steel
- Continuous Run:** Full ability to tandem mount for continuous run application equipped with male & female quick connect harnesses
- Mounting:** For most effective indirect lighting result, mount at no less than 18" from the Ceiling
- Custom Design:** Offered with pre-fabricated and fully illuminated corners
- Lens:** Glare-free snap-in frosted acrylic for even distribution
- Voltage:** 120-277V (50/60 Hz) Constant current
- Universal Dimming:** TRIAC (Forward-Phase), ELV (Reverse-Phase), 0-10V
- CRI:** 80+ & 90+
- Life:** 50,000 Hours L70
- Warranty:** 5 Years carefree for parts & components (Labor not included)
- Listings:** CA Title 24 Compliant, cETL Listed, LED Chips Tested to LM-80 Standards

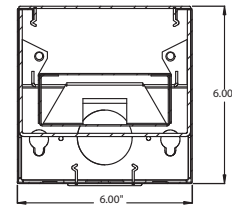

ORDERING INFORMATION Example: (12100-66-W-D-R24-RC-8x8-WH-27K-8-EM)

Model	Mount	Distribution	Lumen Output	Shape
12100-66 6" x 6"	W Wall	D Direct	R24 24 watts 2400 lms	S Single Unit
		I Indirect	R48 48 watts 4800 lms	CR Continuous Run
		WW Wall Wash		RC Rectangle
		D/I Direct/Indirect	R12D24 UP: 12 watts 1200 lms DOWN: 24 watts 2600 lms	
			R18D36 UP: 18 watts 1800 lms DOWN: 36 watts 3600 lms	
				SQ Square
				CU² Custom

Finish	Color Temp	CRI
Standard	Residential	8 Standard
WH White	27K¹ 2700K	80+ CRI
BK Black	30K 3000K	9
SL Silver	Commercial	90+ CRI
Premium	35K 3500K	
RD Red	40K 4000K	
BL Blue	Industrial	
GR Green	50K 5000K	
OR Orange		
SB Satin Brass		

Options	Controls
EM Remote Emergency Backup Battery (4ft canopy)	Optional
AB² Independent Control of Up & Down	LV Lutron VIVE™ Wireless
DS Daylight Sensor	LE Lutron EcoSystem™
OS Occupancy Sensor	BM Bluetooth Mesh

CR
Continuous Run

RC
Rectangle

SQ
Square

CU²
Custom

¹ 2700K only available in 90+ CRI
² Required for D/I Distributions Only

Project Name:

Type:

Quantity:

FIXTURE SPECIFICATIONS

INTENDED USE

Made in die-formed and welded 22-gauge, cold-rolled steel with the capacity to tandem mount for a continuous run application, our high-CRI LED product is made to last, making this direct/indirect light perfect for commercial, hospitality and residential interiors. Offered with pre-fabricated and fully illuminated corners and a frosted, acrylic glare-free lens that snaps in, the powerful, versatile commercial-grade product suits today's office, classroom, conference room, museum, retailer, hotel and restaurant.

PRODUCT FAMILY

- 12100-66-P** | Pendant Mount
- 12100-66-W** | Wall Mount
- 12100-66-S** | Surface Mount
- 12100-66-R** | Recessed Mount

AVAILABLE LENGTHS

- 4FT** | W 6" x L 48" x H 6"
- 8FT** | W 6" x L 96" x H 6"
- Continuous Run** | Consult Factory
- Custom Length** | Consult Factory



FEATURES

- Construction:** Die-formed and welded 22-gauge cold rolled steel
- Continuous Run:** Full ability to tandem mount for continuous run application equipped with male & female quick connect harnesses
- Mounting:** For most effective indirect lighting result, mount at no less than 18" from the Ceiling
- Custom Design:** Offered with pre-fabricated and fully illuminated corners
- Lens:** Glare-free snap-in frosted acrylic for even distribution
- Voltage:** 120-277V (50/60 Hz) Constant current
- Universal Dimming:** TRIAC (Forward-Phase), ELV (Reverse-Phase), 0-10V
- CRI:** 80+ & 90+
- Life:** 50,000 Hours L70
- Warranty:** 5 Years carefree for parts & components (Labor not included)
- Listings:** CA Title 24 Compliant, cETL Listed, LED Chips Tested to LM-80 Standards

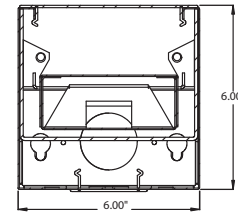

Alcon 12100-66-S Linear Surface-Mount LED Downlight

ORDERING INFORMATION Example: (12100-66-S-D-R24-RC-8x8-27K-WH-D10-EM)

Model	Mount	Distribution	Lumen Output	Shape
12100-66 6" x 6"	S Surface	D Direct WW Wall Wash	R24 24 watts 2400 lms R48 48 watts 4800 lms	S Single Unit CR Continuous Run RC Rectangle SQ Square
				4' or 8' Total Run (in Feet)
				Width Length
				Width Length

Finish	Color Temp	CRI
Standard	Residential	8 Standard
WH White	27K¹ 2700K	80+ CRI
BK Black	30K 3000K	9
SL Silver	Commercial	90+ CRI
Premium	35K 3500K	
RD Red	40K 4000K	
BL Blue	Industrial	
GR Green	50K 5000K	
OR Orange		
SB Satin Brass		

Options	Controls
EM Remote Emergency Backup Battery (4ft canopy)	Optional LV Lutron VIVE™ Wireless
DS Daylight Sensor	LE Lutron EcoSystem™
OS Occupancy Sensor	BM Bluetooth Mesh

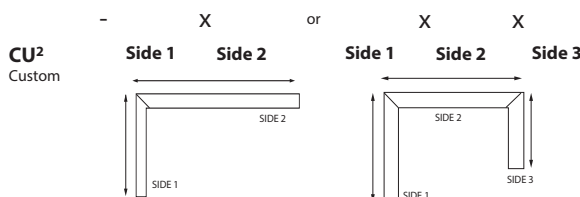

¹2700K only available in 90+ CRI

Project Name:

Type:

Quantity:

FIXTURE SPECIFICATIONS

INTENDED USE

The specification grade **Continuum 66 LED Recessed Mount Architectural Linear Luminaire** delivers continuous clean lines and clear light to commercial, hospitality and residential interior lighting applications. Our modern, slim profiles and stylish designs offer excellent illumination, exceptional performance and versatility in offices, classrooms, conference rooms, museums, retail outlets, hotels, restaurants, and more. The integrated LED Continuum is available in standard lengths of 4' and 8', and can be joined together in seamless runs of any length.

PRODUCT FAMILY

- 12100-66-P** | Pendant Mount
- 12100-66-W** | Wall Mount
- 12100-66-S** | Surface Mount
- 12100-66-R** | Recessed Mount

AVAILABLE LENGTHS

- 4FT** | W 6" x L 48" x H 6"
- 8FT** | W 6" x L 96" x H 6"
- Continuous Run** | Consult Factory
- Custom Length** | Consult Factory

FEATURES

- Construction:** Die-Formed and Welded 22-Gauge Cold Rolled Steel
- Continuous Run:** Full Ability to Tandem Mount for Continuous Run Application, Equipped with Male & Female Quick Connect Harnesses
- Custom Design:** Offered with Pre-Fabricated and Fully Illuminated Corners
- Lens:** Glare Free Snap In Frosted Acrylic for Even Distribution
- Voltage:** 120-277V (50/60 Hz) Constant Current
- Universal Dimming:** TRIAC (Forward-Phase), ELV (Reverse-Phase), 0-10V
- CRI:** 80+ & 90+
- Life:** 50,000 Hours L70
- Warranty:** 5 Years Carefree for Parts & Components (Labor Not Included)
- Listings:** CA Title 24 Compliant, cETL Listed, LED Chips Tested to LM-80 Standards

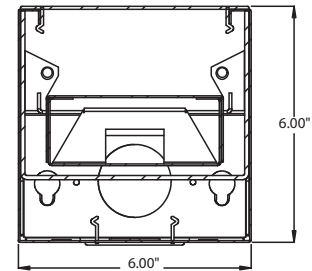
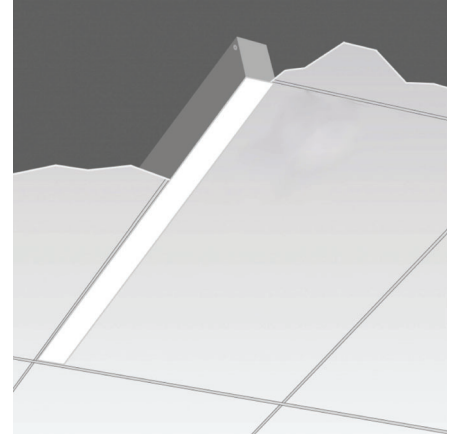

ORDERING INFORMATION Example: (12100-66-R-D-R24-RC-8x8-WH-27K-8-EM)

Model	Mount	Distribution	Lumen Output	Shape	Finish	Color Temp	CRI
12100-66 6" x 6"	R Recessed T-Bar	D Direct WW Wall Wash	R24 24 watts 2400 lms	S Single Unit	Standard WH White BK Black SL Silver Premium RD Red BL Blue GR Green OR Orange SB Satin Brass	Residential 27K ¹ 2700K 30K 3000K Commercial 35K 3500K 40K 4000K Industrial 50K 5000K	8 Standard 80+ 9 90+
	RF Recessed Flanged	R48 48 watts 4800 lms	CR Continuous Run	Total Run (in Feet) 			
	RTL Recessed Trimless		RC Rectangle	Width Length 			
			SQ Square	Width Length 			

Options	Controls
EM Remote Emergency Backup Battery (4ft canopy)	Optional LV Lutron VIVE™ Wireless
DS Daylight Sensor	LE Lutron EcoSystem™
OS Occupancy Sensor	BM Bluetooth Mesh

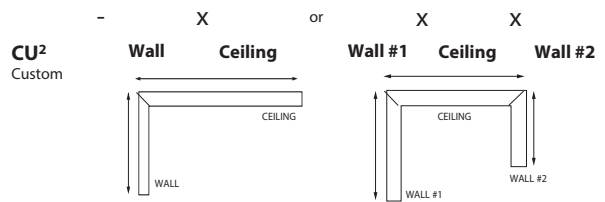

Alcon Lighting 12100-66-R Continuum 66 Architectural LED Linear Recessed Mount Direct Down Light Fixture

PENDANT/WALL/SURFACE/RECESSED MOUNT 48"

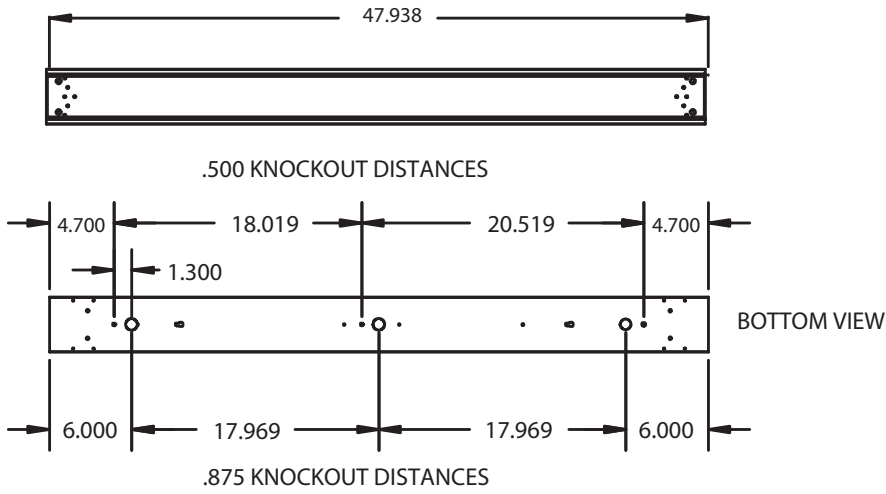

PENDANT/WALL/SURFACE/RECESSED MOUNT 96"

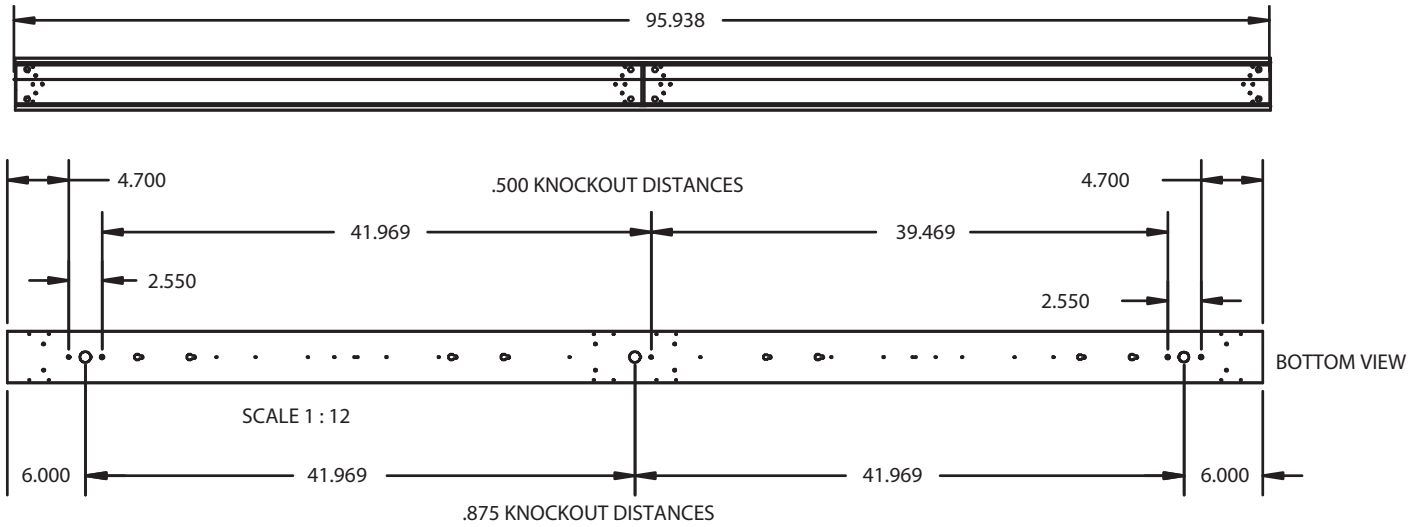

Compatible Dimmers					
Mfg.	Model	Mfg.	Model	Mfg.	Model
Lutron	S-603PG	Lutron	DVELV-303P	Lutron	CT-103P
Leviton	IPI06-1LZ	Lutron	SELV-300P	Cooper	SLC03P
Leviton	6631-2	Leviton	6683-IW	Leviton	IPE04
Lutron	DVCL-153P	Leviton	6161	Lutron	MAELV-600
Lutron	DV-600P	Leviton	6633-P	Lutron	FAELV-500
Lutron	TGCL-153P	Lutron	TG-600P	Lightolier	ZP260QEW
Lutron	S-600P	Cooper	DLC03P	Cooper	DAL06P
Leviton	VPE06	Lutron	LG-600P	Leviton	IP710-DLZ