

FIXTURE SPECIFICATIONS

INTENDED USE

The specification grade **Continuum 66 LED Suspension Architectural Linear Luminaire** delivers continuous clean lines and clear light to commercial, hospitality and residential interior lighting applications. Our modern, slim profiles and stylish designs offer excellent illumination, exceptional performance and versatility in offices, classrooms, conference rooms, museums, retail outlets, hotels, restaurants, and more. The integrated LED Continuum is available in standard lengths of 4' and 8', and can be joined together in seamless runs of any length.

PRODUCT FAMILY

- 12100-66-P** | Pendant Mount
- 12100-66-W** | Wall Mount
- 12100-66-S** | Surface Mount
- 12100-66-R** | Recessed Mount

AVAILABLE LENGTHS

- 4FT** | W 6" x L 48" x H 6"
- 8FT** | W 6" x L 96" x H 6"

FEATURES

- Construction:** Die-Formed and Welded 22-Gauge Cold Rolled Steel
- Continuous Row:** Full Ability to Tandem Mount for Continuous Run Application Equipped with Male & Female Quick Connect Harnesses
- Custom Design:** Offered with Pre-Fabricated and Fully Illuminated Corners
- Lens:** Glare Free Snap In Frosted Acrylic for Even Distribution
- Voltage:** 120-277V (50/60 Hz) Constant Current
- Dimming:** 5-Wire 0-10V (100%-10%), 3-Wire Electronic Low Voltage (100%-1%)
- CRI:** 80+ & 90+
- Life:** 50,000 Hours L70
- Warranty:** 5 Years Carefree for Parts & Components (Labor Not Included)
- Listings:** CA Title 24 Compliant, cETL Listed, LED Chips Tested to LM-80 Standards

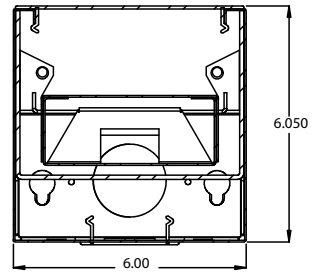

ORDERING INFORMATION Example: (12100-66-P-D-R24-RC-8x8-27K-WH-D10-AC48-EM)

Model	Mount	Distribution	Lumen Output	Shape	CCT	Finish	Driver	Suspension	
12100-66 6" x 6"	P Pendant	D Direct I Indirect WW Wall Wash	(Per 4 Foot Sections) R24 24 watts 2400 lms R48 48 watts 4800 lms	S Single Unit CR Continuous Run	4' or 8' Total Run (in Feet) 	27K¹ 30K 35K 40K 50K	WH White BL Blue BK Black SL Silver SB Satin BR Brass RAL Consult Factory	D10 5-Wire 0-10V (100%-10%) ELV 3-Wire Electronic Low Voltage (100%-1%)	AC48³ 48" Adjustable Aircraft Cable (x2) AC144³ 144" Adjustable Aircraft Cable (x2) ST24³ 24" Stem (x2) STXX³ Custom Stem Length
		D/I Direct/Indirect	(Per 4 Foot Sections) R12D24 UP: 12 watts 1200 lms DOWN: 24 watts 2600 lms R18D36 UP: 18 watts 1800 lms DOWN: 36 watts 3600 lms	RC Rectangle SQ Square	Width Length 				
				CU² Custom	Width Length 				
					Side 1 Side 2 or Side 1 Side 2 Side 3 				

- Options**
- EM** Remote Emergency Backup Battery
 - AB⁴** Independent Control of Up & Down

¹90+ CRI
²Driver: Programmable Driver with Desired Lumen Output
³20.4" Thick 5-Conductor Power Cable (x1)
⁵" Round Canopy (x2)
⁴Required for D/I Distributions Only

THIS PRODUCT IS ONLY TO BE INSTALLED BY A QUALIFIED TECHNICIAN IN ACCORDANCE WITH NATIONAL AND LOCAL ELECTRICAL CODES.

Formerly: 12109 Beam 66

FIXTURE SPECIFICATIONS

INTENDED USE

The specification grade **Continuum 66 LED Wall Mount Architectural Linear Luminaire** delivers continuous clean lines and clear light to commercial, hospitality and residential interior lighting applications. Our modern, slim profiles and stylish designs offer excellent illumination, exceptional performance and versatility in offices, classrooms, conference rooms, museums, retail outlets, hotels, restaurants, and more. The integrated LED Continuum is available in standard lengths of 4' and 8', and can be joined together in seamless runs of any length.

PRODUCT FAMILY

- 12100-66-P** | Pendant Mount
- 12100-66-W** | Wall Mount
- 12100-66-S** | Surface Mount
- 12100-66-R** | Recessed Mount

AVAILABLE LENGTHS

- 4FT** | W 6" x L 48" x H 6"
- 8FT** | W 6" x L 96" x H 6"

FEATURES

- Construction:** Die-Formed and Welded 22-Gauge Cold Rolled Steel
- Continuous Row:** Full Ability to Tandem Mount for Continuous Run Application, Equipped with Male & Female Quick Connect Harnesses
- Custom Design:** Offered with Pre-Fabricated and Fully Illuminated Corners
- Lens:** Glare Free Snap In Frosted Acrylic for Even Distribution
- Voltage:** 120-277V (50/60 Hz) Constant Current
- Dimming:** 5-Wire 0-10V (100%-10%), 3-Wire Electronic Low Voltage (100%-1%)
- CRI:** 80+ & 90+
- Life:** 50,000 Hours L70
- Warranty:** 5 Years Carefree for Parts & Components (Labor Not Included)
- Listings:** CA Title 24 Compliant, cETL Listed, LED Chips Tested to LM-80 Standards

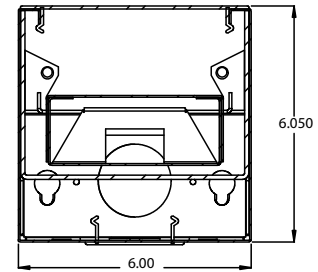

ORDERING INFORMATION Example: (12100-66-W-D-R24-RC-8x8-27K-WH-D10-EM)

Model	Mount	Distribution	Lumen Output	Shape	CCT	Finish	Driver	Options
12100-66 6" x 6"	W Wall	D Direct	(Per 4 Foot Sections) R24 24 watts 2400 lms	S Single Unit	4' or 8' Total Run (in Feet) 	27K¹ 30K 35K 40K 50K	D10 5-Wire 0-10V (100% -10%) ELV 3-Wire Electronic Low Voltage (100%-1%)	EM Remote Emergency Backup Battery AB³ Independent Control of Up & Down
		I Indirect	R48 48 watts 4800 lms	CR Continuous Run				
		WW Wall Wash						
		D/I Direct/Indirect	(Per 4 Foot Sections) R12D24 UP: 12 watts 1200 lms DOWN: 24 watts 2600 lms R18D36 UP: 18 watts 1800 lms DOWN: 36 watts 3600 lms	RC Rectangle				
				SQ Square				
				CU² Custom				

¹90+ CRI
²Driver: Programmable Driver with Desired Lumen Output
³Required for D/I Distributions Only

THIS PRODUCT IS ONLY TO BE INSTALLED BY A QUALIFIED TECHNICIAN IN ACCORDANCE WITH NATIONAL AND LOCAL ELECTRICAL CODES.

Formerly: 12109 Beam 66

FIXTURE SPECIFICATIONS

INTENDED USE

The specification grade **Continuum 66 LED Surface Mount Architectural Linear Luminaire** delivers continuous clean lines and clear light to commercial, hospitality and residential interior lighting applications. Our modern, slim profiles and stylish designs offer excellent illumination, exceptional performance and versatility in offices, classrooms, conference rooms, museums, retail outlets, hotels, restaurants, and more. The integrated LED Continuum is available in standard lengths of 4' and 8', and can be joined together in seamless runs of any length.

PRODUCT FAMILY

- 12100-66-P** | Pendant Mount
- 12100-66-W** | Wall Mount
- 12100-66-S** | Surface Mount
- 12100-66-R** | Recessed Mount

AVAILABLE LENGTHS

- 4FT** | W 6" x L 48" x H 6"
- 8FT** | W 6" x L 96" x H 6"

FEATURES

- Construction:** Die-Formed and Welded 22-Gauge Cold Rolled Steel
- Continuous Row:** Full Ability to Tandem Mount for Continuous Run Application Equipped with Male & Female Quick Connect Harnesses
- Custom Design:** Offered with Pre-Fabricated and Fully Illuminated Corners
- Lens:** Glare Free Snap In Frosted Acrylic for Even Distribution
- Voltage:** 120-277V (50/60 Hz) Constant Current
- Dimming:** 5-Wire 0-10V (100%-10%), 3-Wire Electronic Low Voltage (100%-1%)
- CRI:** 80+ & 90+
- Life:** 50,000 Hours L70
- Warranty:** 5 Years Carefree for Parts & Components (Labor Not Included)
- Listings:** CA Title 24 Compliant, cETL Listed, LED Chips Tested to LM-80 Standards

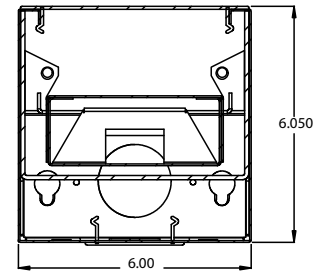

ORDERING INFORMATION Example: (12100-66-S-D-R24-RC-8x8-27K-WH-D10-EM)

Model	Mount	Distribution	Lumen Output	Shape	CCT	Finish	Driver	Options	
12100-66 6" x 6"	S Surface	D Direct WW Wall Wash	(Per 4 Foot Sections) R24 24 watts 2400 lms R48 48 watts 4800 lms	S Single Unit CR Continuous Run	4' or 8' Total Run (in Feet) 	27K' 30K 35K 40K 50K	WH White BL Blue BK Black SL Silver SB Satin BR Brass RAL Consult Factory	D10 5-Wire 0-10V (100%-10%) ELV 3-Wire Electronic Low Voltage (100%-1%)	EM Remote Emergency Backup Battery

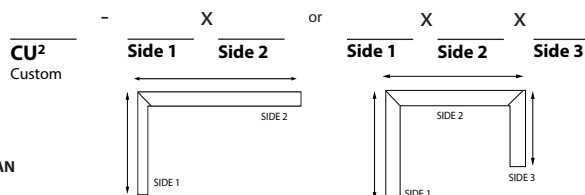
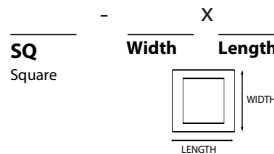
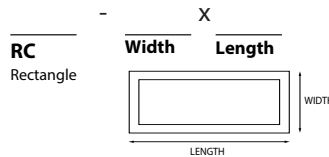

¹90+ CRI

²Driver: Programmable Driver with Desired Lumen Output

THIS PRODUCT IS ONLY TO BE INSTALLED BY A QUALIFIED TECHNICIAN IN ACCORDANCE WITH NATIONAL AND LOCAL ELECTRICAL CODES.

FIXTURE SPECIFICATIONS

INTENDED USE

The specification grade **Continuum 66 LED Recessed Mount Architectural Linear Luminaire** delivers continuous clean lines and clear light to commercial, hospitality and residential interior lighting applications. Our modern, slim profiles and stylish designs offer excellent illumination, exceptional performance and versatility in offices, classrooms, conference rooms, museums, retail outlets, hotels, restaurants, and more. The integrated LED Continuum is available in standard lengths of 4' and 8', and can be joined together in seamless runs of any length.

PRODUCT FAMILY

- 12100-66-P** | Pendant Mount
- 12100-66-W** | Wall Mount
- 12100-66-S** | Surface Mount
- 12100-66-R** | Recessed Mount

AVAILABLE LENGTHS

- 4FT** | W 6" x L 48" x H 6"
- 8FT** | W 6" x L 96" x H 6"

FEATURES

- Construction:** Die-Formed and Welded 22-Gauge Cold Rolled Steel
- Continuous Row:** Full Ability to Tandem Mount for Continuous Run Application, Equipped with Male & Female Quick Connect Harnesses
- Custom Design:** Offered with Pre-Fabricated and Fully Illuminated Corners
- Lens:** Glare Free Snap In Frosted Acrylic for Even Distribution
- Voltage:** 120-277V (50/60 Hz) Constant Current
- Dimming:** 5-Wire 0-10V (100%-10%), 3-Wire Electronic Low Voltage (100%-1%)
- CRI:** 80+ & 90+
- Life:** 50,000 Hours L70
- Warranty:** 5 Years Carefree for Parts & Components (Labor Not Included)
- Listings:** CA Title 24 Compliant, cETL Listed, LED Chips Tested to LM-80 Standards

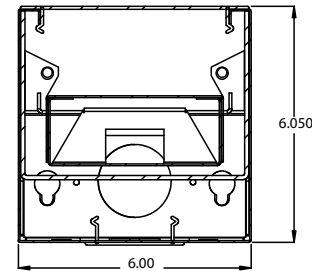
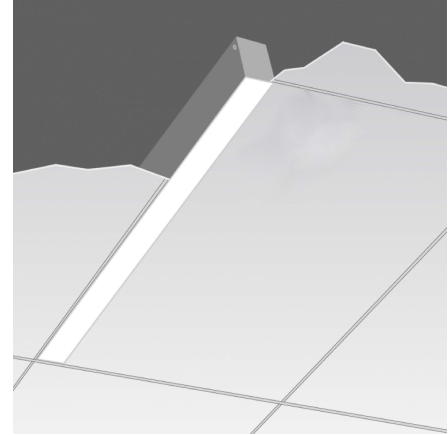

ORDERING INFORMATION Example: (12100-66-R-D-R24-RC-8x8-27K-WH-D10-EM)

Model	Mount	Distribution	Lumen Output	Shape	CCT	Finish ³	Driver	Options	
12100-66 6" x 6"	R Recessed T-Bar	D Direct WW Wall Wash	(Per 4 Foot Sections) R24 24 watts 2400 lms R48 48 watts 4800 lms	S Single Unit CR Continuous Run	4' or 8' Total Run (in Feet) 	27K' 30K 35K 40K 50K	WH White BL Blue BK Black SL Silver SB Satin BR Brass BL Blue OR Orange GR Green RD Red RAL Consult Factory	D10 5-Wire 0-10V (100%-10%) ELV 3-Wire Electronic Low Voltage (100%-1%)	EM Remote Emergency Backup Battery
				RC Rectangle 					
				SQ Square 					
				CU² Custom 					

¹90+ CRI
²Driver: Programmable Driver with Desired Lumen Output
³Not Required for Recessed Trimless

THIS PRODUCT IS ONLY TO BE INSTALLED BY A QUALIFIED TECHNICIAN IN ACCORDANCE WITH NATIONAL AND LOCAL ELECTRICAL CODES.

Formerly: 12109 Beam 66

PENDANT/WALL/SURFACE/RECESSED MOUNT 48"

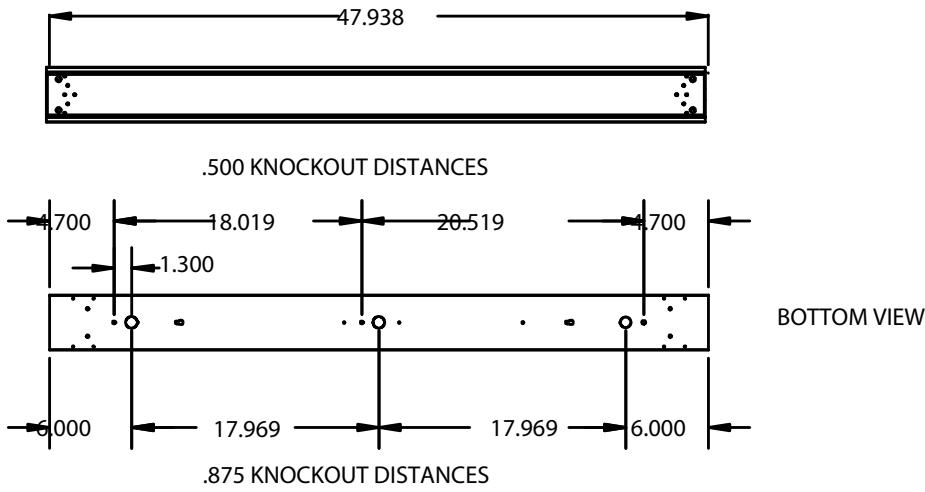

PENDANT/WALL/SURFACE/RECESSED MOUNT 96"

