

Project Name:

Type:

Quantity:

FIXTURE SPECIFICATIONS

INTENDED_USE

Aluminum, architectural-grade linear LED downlighting is the most versatile of its class. Available for pendant, wall, ceiling surface, recessed, drywall, trimless, t-bar and wood cladding applications. This two-inch product is field color temperature selectable providing clean, high-CRI LED light for architectural residential, hospitality and commercial use. Voltage, length and lumen outputs vary. Compatible with wood ceilings. Dimming and emergency backup battery features available.

PRODUCT FAMILY

12100-23-P Pendant Mount

12100-23-W Wall Mount

12100-23-S Surface Mount

12100-23-R Recessed Mount

FEATURES

Construction: Aluminum housing

Color Temperature: 3000K/3500K/4000K/5000K Color temperature selectable switch/field adjustable

Indirect Mounting: For most effective indirect lighting result, mount at no less than 18" from the ceiling

Voltage: 120-277V 50/60 Hz

Dimming: 0-10V 5-wire dimming

CRI: 80+

Life: +60,000 reported L70 hours @ 55°C

Power Factor: >0.95

Operating Temperature: -13°F ~ 104°F (-25°C ~ 40°C)

Warranty: 5 years carefree for parts & components (labor not included)

Listings: UL Listed, DLC listed (4 foot only), IP54, Suitable for Damp Location

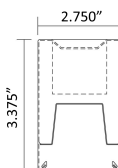

OP | Opal Polycarbonate Lens

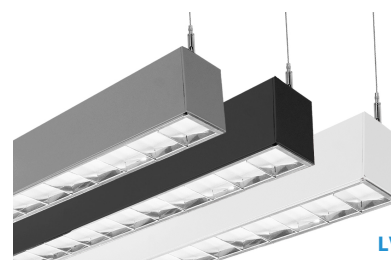
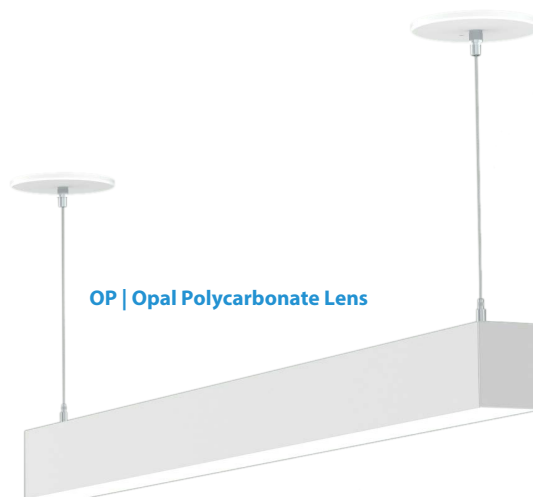

LV | Louver Lens

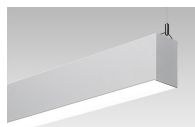

Pendant



Surface



Wall

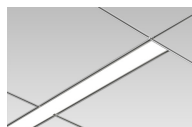

Recessed T-Bar

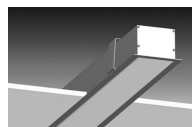

Recessed Flanged
Drywall & Wood

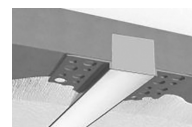

Recessed Trimless
Drywall

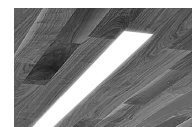

Recessed Trimless
Wood



ORDERING INFORMATION Example: (12100-23-P-OP-D10-I8-4-WH-AC6-REM)

Model	Mounting	Lens Type	LED Downlight <i>Wattage Lumens per Foot</i>	LED Uplight <i>Wattage Lumens per Foot</i>	Length	Flange Finish ³	Pendant Mount	Options
12100-23	P Pendant	OP Opal	D10 10 Watts 1195 Lumens	Blank No Uplight	2 2 ft	WH ^{Standard} White	(Blank) None Required	REM Remote
	W Wall	Polycarbonate			3 3 ft	BK Black	AC6 6' Adjustable Aircraft Cable	Emergency
	S ¹ Surface	LVR ² Louver		I4 4 Watts 432 Lumens	4 4 ft	SL Silver	ST2 2' Stem	Back-Up
	RT ¹ Recessed T-Bar				6 6 ft		ST3 3' Stem	Battery
	RF ¹ Recessed Flanged				8 8 ft		ST4 4' Stem	
	RTL ^{1,3} Recessed Trimless Drywall							
	RTLW ^{1,3} Recessed Trimless Wood							

¹ LED uplight unavailable for this option

² Louver option includes lens | 1081 lms/ft @ 4000K

³ Not available for Recessed T-Bar, Recessed Trimless Drywall or Recessed Trimless wood options

Mounting Details

1" Grid Mounting Options

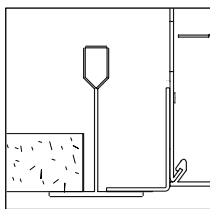

Flange Detail

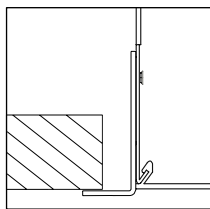

Spackle Flange Trimless

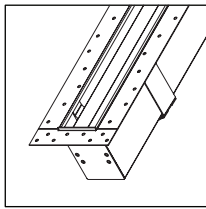

Ceiling to Wall

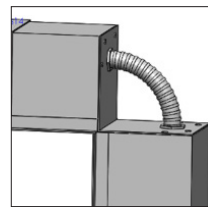

Surface

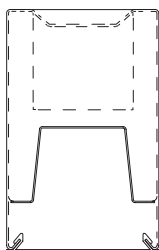

Recessed T-Bar

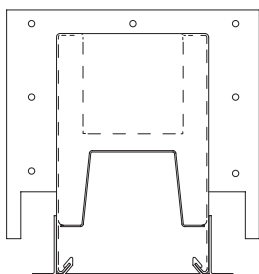

Cable Pendant

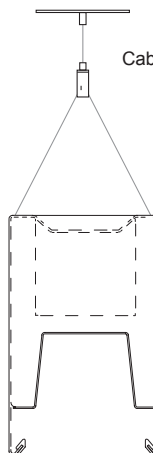

Stem Pendant

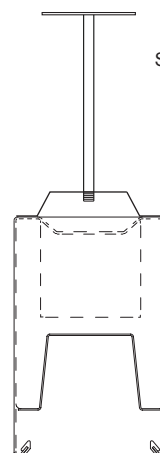

Drywall

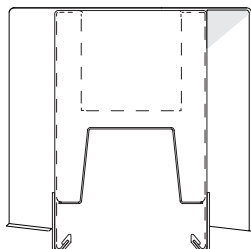

Wall

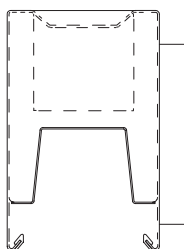

Recessed Wood Installation

- Make recessed preparations by installing a horizontal plank of wood on top of the wood ceiling at recessed height of 3-3/8".
- Screw and anchor kit provided with each fixture can be used to fasten the top of the fixture to the wood plank through the holes on top of the fixture.
- You can also install vertical wood boards on top of the ceiling at the edge of the opening and open the fixture and put screws through the sides of the fixture housing to fasten it to the wood boards.

Pendant Installation

A simple design and adjustable components provide a flexible and hassle-free experience when installing the Continuum Series™.

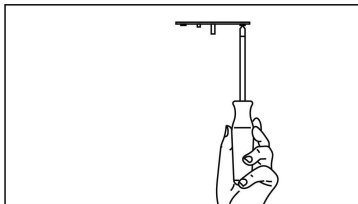

Step 1: Secure cross brackets to junction boxes for both power and non power mounting points.

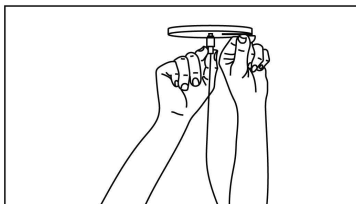

Step 2: Secure canopy with power canopy coupler (Power Feed Mount) & secure canopy with cable terminal (Non Power Feed Mount).

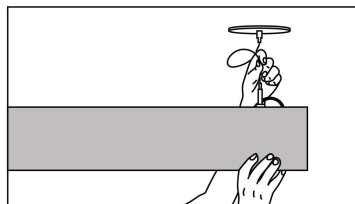

Step 3: Feed aircraft cable into cable grippers, adjust height and level luminaire.

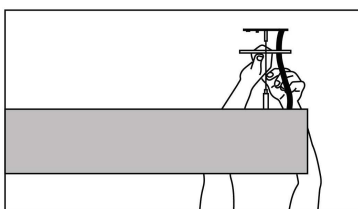

Step 4: Unscrew outer coupler to allow access to junction box. Feed power cord through canopy.

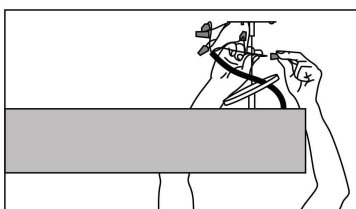

Step 5: Secure canopy back in place with outer coupler.

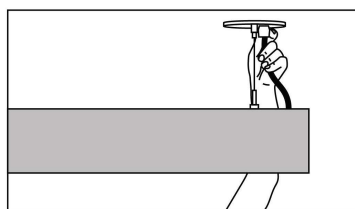

Step 6: Snap strain relief around power cord. Press into canopy.

Recessed T-Bar Installation

The T-Bar variant of the Continuum Series™ is built to easily install and integrate into the standard grid ceilings in modern interior spaces. The luminaire's flange conveniently hides any imperfections in cuts to the tile, creating a clean, seamless look.

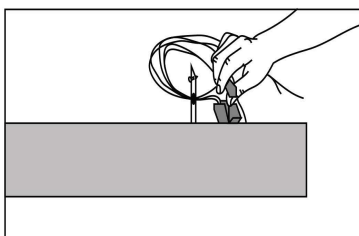

Step 1: Shut off power. Remove ceiling tile from desired light fixture location. Remove knockout plate. Remove pigtail.

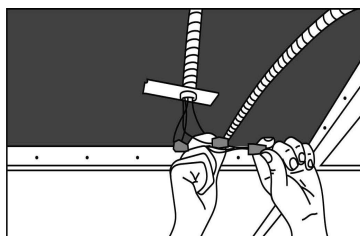

Step 2: Mount knockout plate to flex conduit. Connect pigtail to conduit wires.

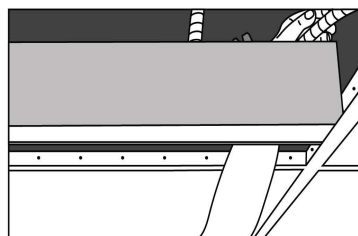

Step 3: Lay luminaire in grid at desired position. Secure fixture to structure above using structural wire (by others) via holes in the end plates.

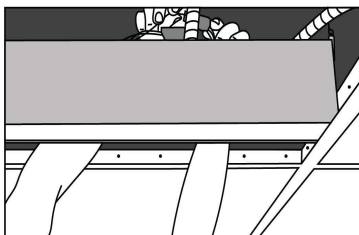

Step 4: Connect pigtail disconnects to luminaire disconnects. Insert wires into housing. Insert knockout plate and fasten using screw provided.

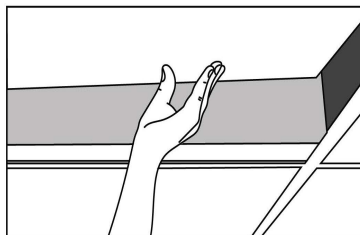

Step 5: Cut tile to fit beside luminaire and install on both sides of the luminaire.

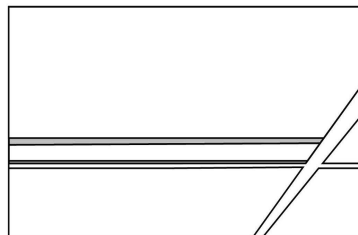

Step 6: Power can now be turned on.