

Multi-function RGB+W DMX Controller

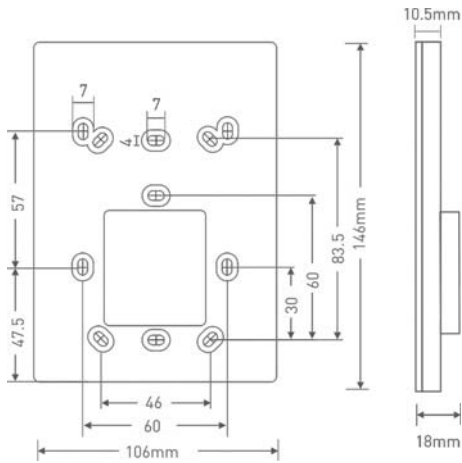

Touch Panel

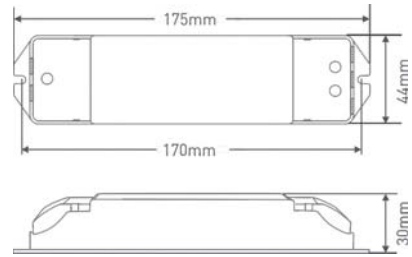

Receiver

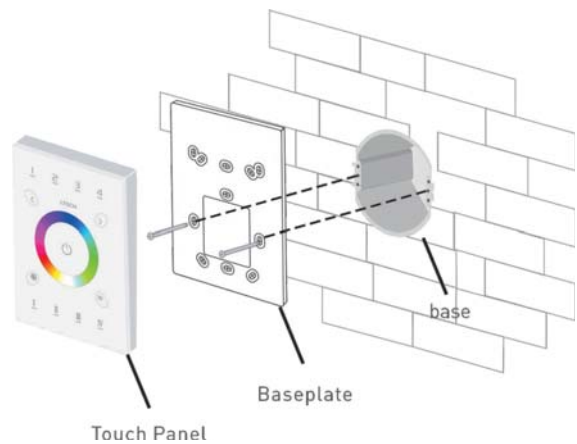
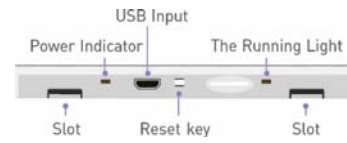
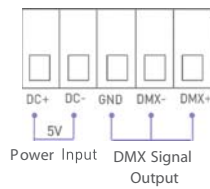
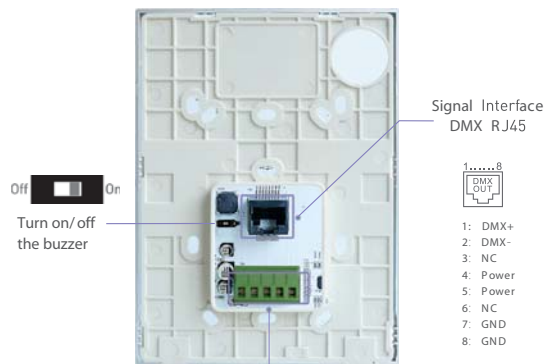

Multi-function RGB+W DMX Controller

1. Install the back box into the wall. Typical box as below:

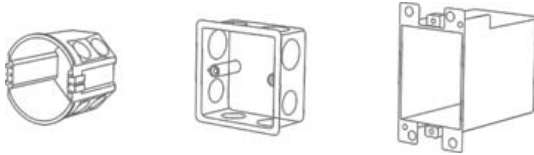

2. Use a straight screwdriver to pry the position shown:

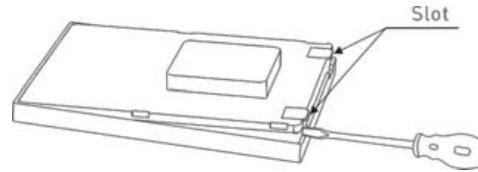

3. Screw the baseplate and the back box in the wall firmly.

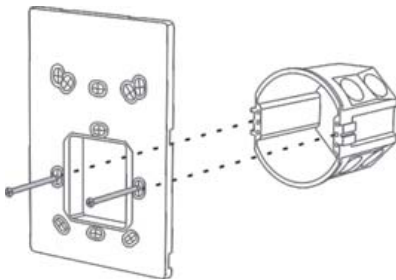

4. Connect in a right way and put the power adapter into the back box.

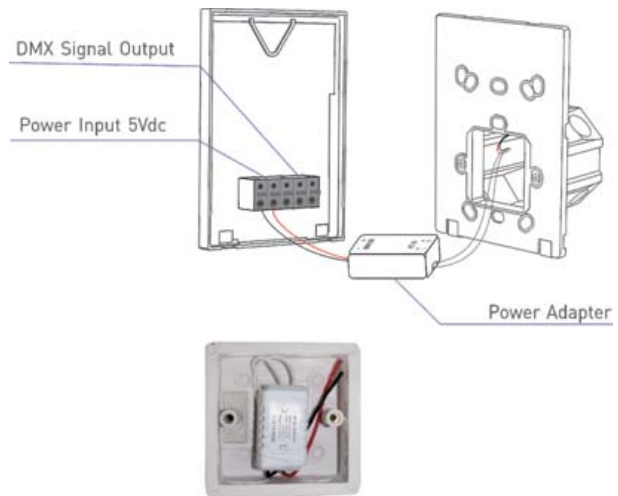

5. Embed the upper touch panel into the baseplate and then tap the bottom to press into the slots.

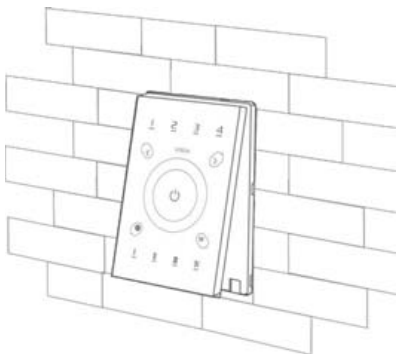

Multi-function RGB+W DMX Controller Key Functions



The Changing Mode (Press  to Select):

1. Static Red
2. Static Green
3. Static Blue
4. Static Yellow
5. Static Purple
6. Static Cyan
7. Static White
8. RGB Jumping
9. 7 Colors Jumping
10. RGB Smooth
11. 7 Colors Smooth
12. Static Black

DMX Output Wiring

