



# REGOLO GENERAL WARNING



## WARNING:

DO NOT ASSEMBLE CONTINUOUS RUN ON THE GROUND AND LIFT INTO PLACE.  
JOINTS WILL DISTORT AND NOT CREATE A TIGHT FIT.  
JOINING HARDWARE WILL HAVE TO BE PURCHASED AND REPLACED.

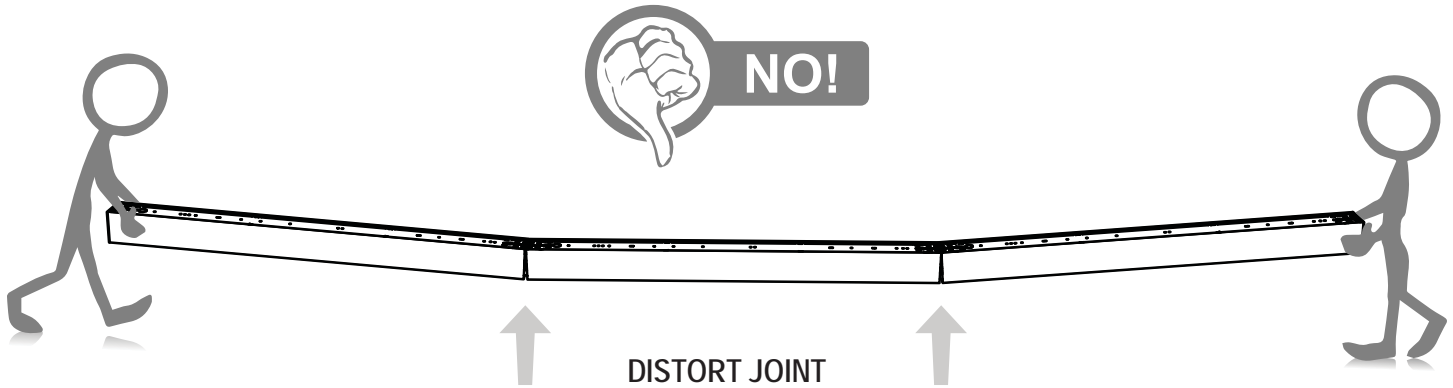

FOR PROPER INSTALL INFORMATION SEE  
RESPECTIVE SERIES INSTALLATION INSTRUCTIONS.

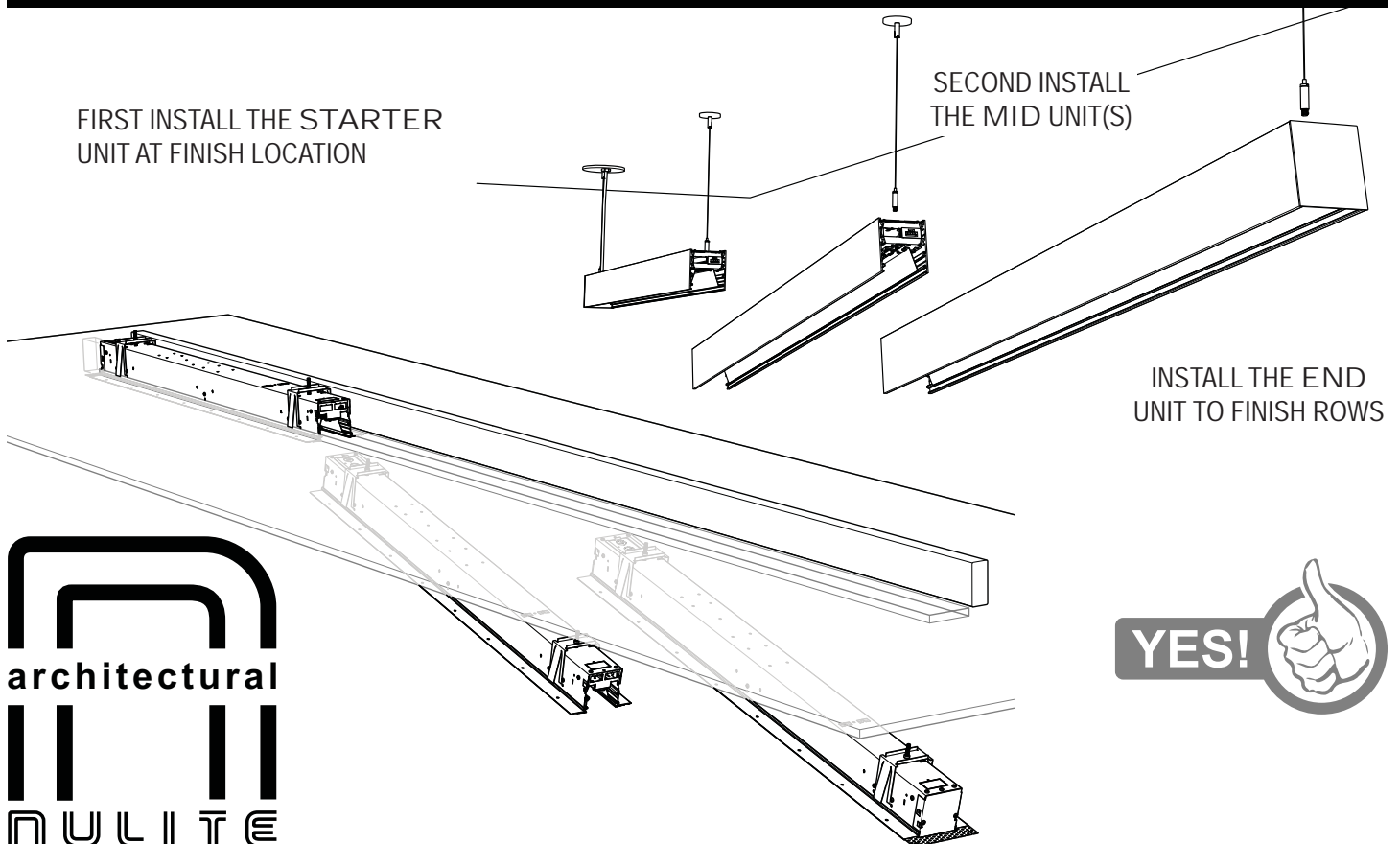

10770 East 51st Ave, Denver, CO 80239 - Phone (303)287-9646 Fax (303)287-0316

Instructions and dimensions are subject to change without notification. Instruction sheets on our website supersede all other versions.

2016 Rev. A

# REGOLO SURFACE

## INSTALLATION INSTRUCTIONS - LED

### ⚠ WARNINGS

Risk of electrical shock or fire, disconnect power during installation or servicing. Read all instructions completely before starting installation. Install and wire in accordance to all national and local codes by a certified electrician. Fixture may be sharp, handle with care. Let fixture cool before maintenance.

### ⚠ AVERTISSEMENTS

Risque d'électrocution ou d'incendie. Déconnectez l'alimentation durant l'installation ou la maintenance. Lisez attentivement toutes les instructions avant de commencer toute installation. Faites installer et câbler selon les normes Nationales et Locales par un électricien certifié. Les installations peuvent être coupantes, à manipuler avec précaution. Laissez refroidir les installations avant une opération de maintenance.

### ⚠ ADVERTENCIA

Riesgo de descarga eléctrica o un incendio, desconecte la alimentación durante la instalación o servicio. Leer todas las instrucciones completas antes de empesar la instalación. Instalar y cablear en acuerdo a las reglas nacionales y códigos locales por un electricista certificado. El accesorio puede estar agudo, agarre con cuidado deje que el accesorio. Enfriar antes de mantenimiento.

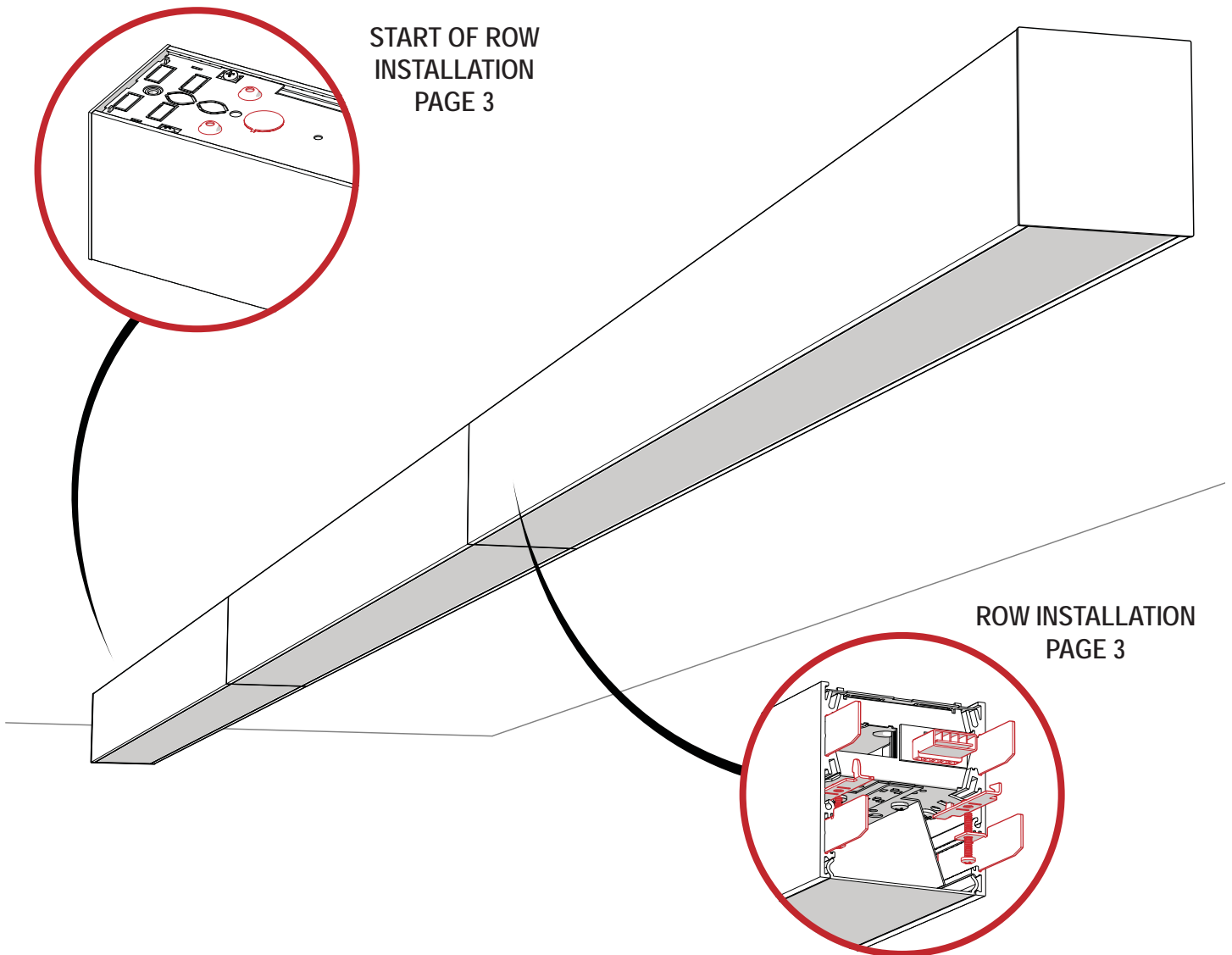
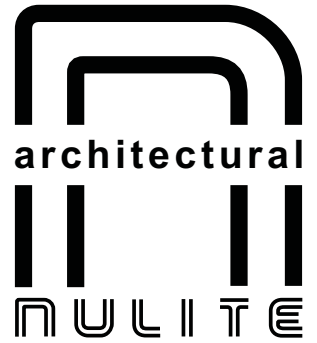

# OVERVIEW

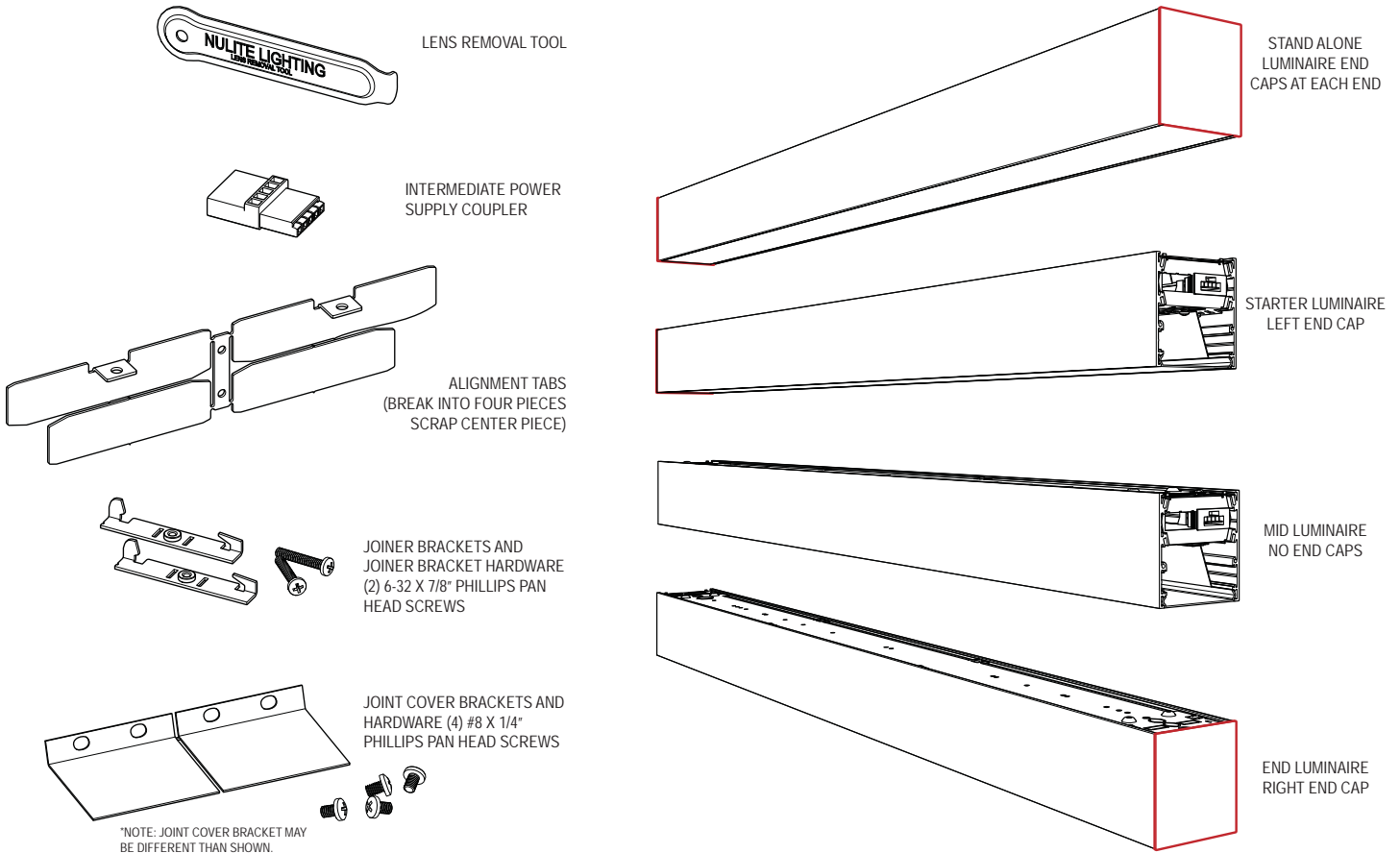

# MAINTENANCE



## AVOID TOUCHING THE LED BOARDS.

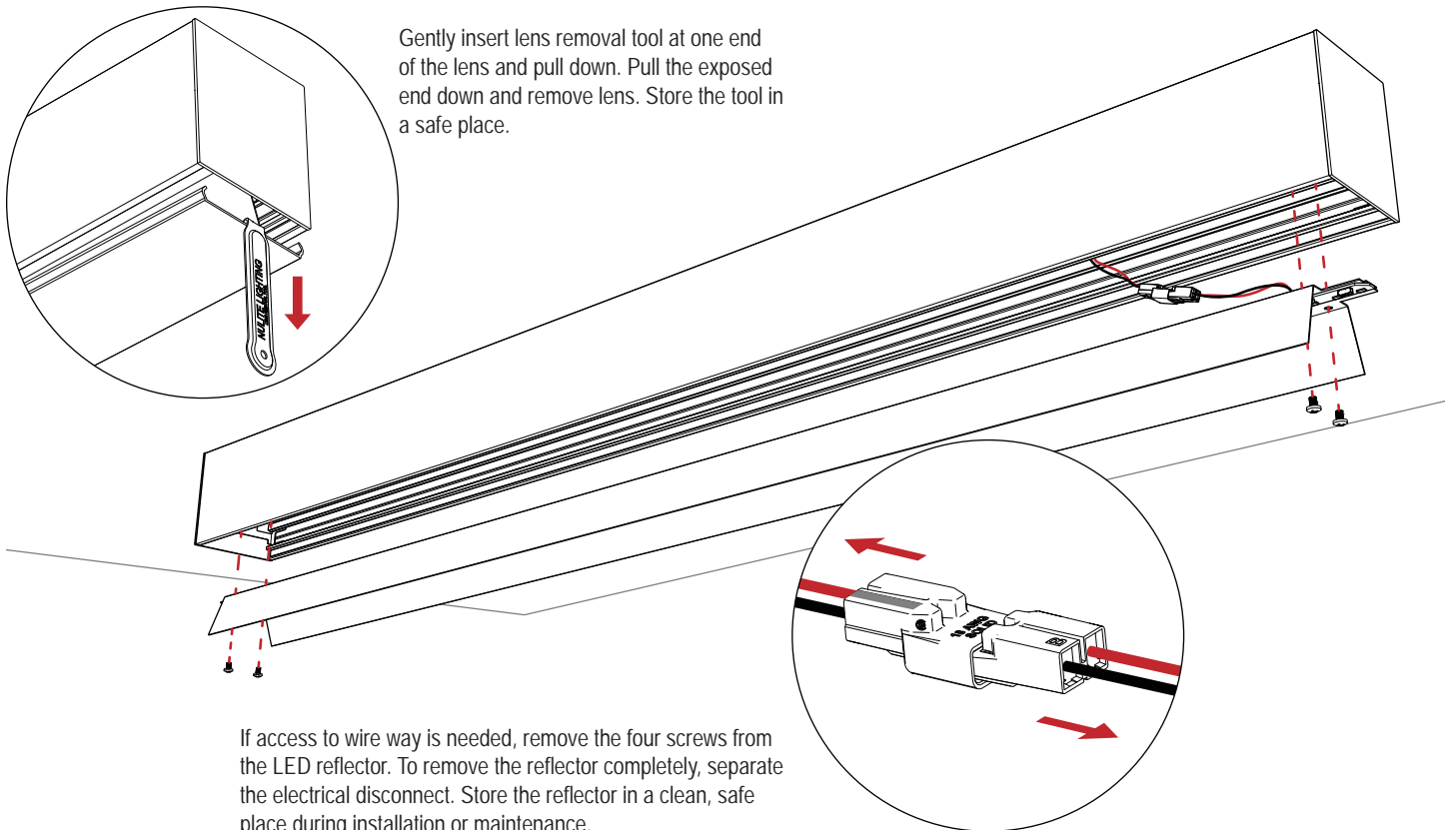

# PLAN VIEW OF HOUSING BACK

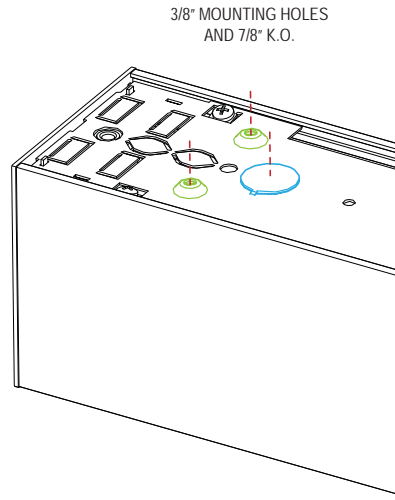
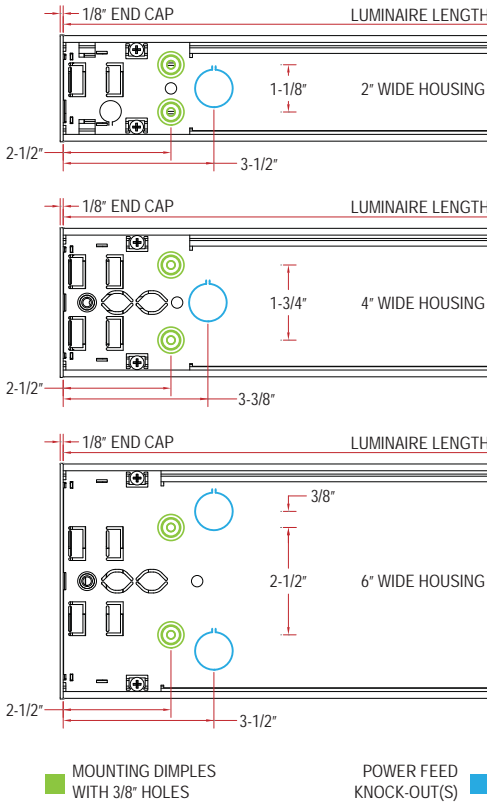

# ROW INSTALLATION

**1** Follow step 1 for individual installation.

Layout and install the luminaire to desired surface with adequate hardware using the 4 mounting dimples. Mounting hardware is not included. (Refer to plan view).

**2**

INTERMEDIATE POWER SUPPLY COUPLER

STARTER LUMINAIRE

MID LUMINAIRE

ALIGNMENT TABS

Align the tabs with the extrusion slots. Make sure the power supply connectors snap together.

**3**

Layout and install the mid luminaire with adequate hardware.

MID LUMINAIRE

STARTER LUMINAIRE

**4**

Joiner brackets are not symmetrical and must be installed in correct slots to work properly.

**5**

**6**

**7**

Secure by tightening the two joiner bracket screws simultaneously (not all at once).

**8**

Install the joint cover brackets with provided #8X1/4" sheet metal screws.