

FEATURES & SPECIFICATIONS

INTENDED USE — Specification premium, high performance, static T5 luminaires provide general illumination for recessed applications; ideal for restricted plenum spaces.

Attributes: Designed specifically for use with high-efficiency T5 lamps, electronic ballasts and rotary sockets.

CONSTRUCTION — Smooth hemmed sides and smooth, inward formed end flanges for easy handling. Lighter weight fixture allows safe, easy installation.

Standard steel door frame has superior structural integrity with premium extruded appearance and precision flush mitered corners. Powder-painted, steel latches provide easy, secure door closure.

Superior mechanical light seal requires no foam gasketing. Integral T-bar clips secure fixture to T-bar system. Housing formed from cold-rolled steel. No asbestos is used in this product.

US PATENTS: 6,210,025; 6,231,213; 6,213,625; 2,288,471.

Finish: Five-stage iron-phosphate pretreatment ensures superior paint adhesion and rust resistance. Painted parts finished with highly reflective matte white enamel.

OPTICS — Post painted perforated steel face plate with aluminum parabolic baffles, provides unique appearance in ceiling. Aluminum parabolic baffles are available in two-lamp configurations. Blades are available in straight, convex and concave shapes. Baffles are designed to provide maximum light control and efficiency.

ELECTRICAL — Standard ballast is electronic programmed rapid start, thermally protected, resetting, Class P, HPF, non-PCB, UL Listed, CSA certified ballast, universal voltage and sound rated A.

Luminaire is suitable for damp locations. AWM, TFN or THHN wire used throughout, rated for required temperatures.

LISTINGS — Standard: UL. Optional: Canada — CSA or cUL; Mexico — NOM.

WARRANTY — Guaranteed for one year against mechanical defects in manufacture.

Note: Specifications subject to change without notice.

Catalog Number
Notes
Type

Specification Premium T5 Troffer

SP5 2'X2'

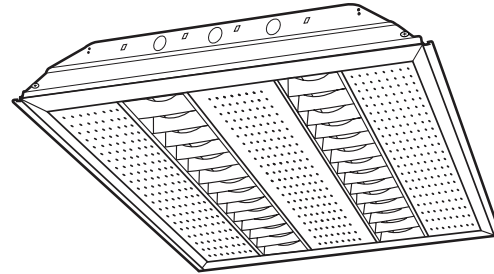

ALUMINUM BAFFLES
T5 and T5HO Lamps
2 lamps

Specifications

Length: 24 (61.0)

Width: 24 (61.0)

Depth: 3-1/4 (8.3)

Weight: 19 lbs (8.6 kg)

All dimensions are inches (centimeters).

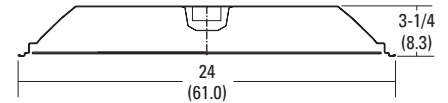

ORDERING INFORMATION

For shortest lead times, configure products using **bolded options**.

Example: 2SP5 G 2 14T5 NEOXBL MVOLT GEB95

Series	Trim type	Number of lamps	Lamp type	Door frame	Diffuser type	Voltage
2SP5	G Grid F Overlapping flanged	2	14T5 14W T5 (22") 24T5HO 24W T5HO (46") ¹	(blank) Flush steel, white	NEOSBL Steel perforated face plate with straight blade specular louvers NEOCBL Steel perforated face plate with concave specular louvers NEOXBL Steel perforated face plate with convex specular louvers	MVOLT ² 120 277 347 ³ others available

Ballast	Options
GEB95 0.95 ballast factor ⁴	EL6 Emergency battery pack
GEB10PS 1.00 ballast factor	GLR Internal fast-blow fuse ⁵
GEB95S 0.95 ballast factor, step dimming ⁴	GMF Internal slow-blow fuse ⁵
GEB115 1.15 ballast factor ⁴	LP835 3500K
GEB115S 1.15 ballast factor, step dimming ⁴	LPM835P Premiere 3500K ⁴
	LP841 4100K
	PWS1836 6' prewire, 3/8" dia., 18-gauge, 3 wires
	PWS1846 6' prewire, 3/8" dia., 18-gauge, 4 wires ⁶
	JP Palletized and stretch-wrapped without individual cartons
	CSA CSA certified
	NOM NOM certified

Notes

- For T5HO applications, use GEB10PS.
- MVOLT (120-277 volts), 50-60HZ.
- For 347V, use GEB95S or GEB10PS.
- 14T5 lamps only.
- Must specify voltage: 120V or 277V.
- Use with GEB95S or GEB115S.

SP5 2' x 2' MW8 Static T5 Troffer

MOUNTING DATA

Continuous row mounting of flanged units requires CRE and CRM trim options (see Options).

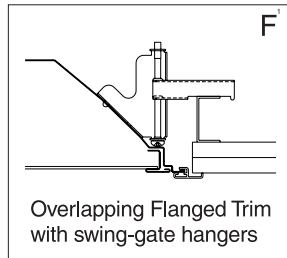
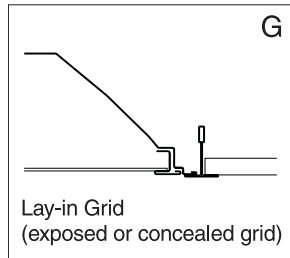

DIMENSIONS

All dimensions are inches (centimeters).

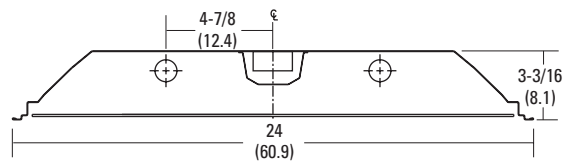

Note

- 1 Recommended rough-in dimensions for F-trim fixtures 24"x24". (Tolerance is +1/4"-0") Swing-gate range 1-3/16" to 3-15/16". Swing-gate span 23-3/8" to 26-11/16". Fixture swing-gate points require additional 9/16" over nominal fixture height.

PHOTOMETRICS

Calculated using the zonal cavity method in accordance with IESNA LM41 procedure. Floor reflectances are 20%. Lamp configurations shown are typical. Full photometric data on these and other configurations available upon request.

Photometric data available upon request.