

## FEATURES & SPECIFICATIONS

**INTENDED USE** — The Shadow Box Square surface mount combines digital lighting and control technologies with an aesthetically pleasing, uniform brightness and clean lines which make the SBSL the perfect solution for applications such as schools, offices and hospitals. The combination of perforated perimeter with white center section is a unique look for today's recessed ceiling applications. High-efficacy light engine delivers long life and excellent color, ensuring a superior quality light installation that is highly efficient and sustainable. **Certain airborne contaminants can diminish integrity of acrylic.** [Click here for Acrylic Environmental Compatibility table for suitable uses.](#)

**CONSTRUCTION** — Housing formed from cold-rolled steel. Housing is painted after fabrication for superior finish.

Smooth hemmed sides and smooth inward-formed end flanges, for easy handling.

Standard extruded aluminum door frame has superior structural integrity with premium appearance and mitered corners. Door frame is painted after fabrication, standard. Powder-painted rotary cam latches provide easy, secure door closure. Integral T-bar clips are standard. Acrylic shielding material is 100% UV stabilized.

**OPTICS** — Stylish open matte white surrounded by perforated patterned trim creates a unique lighted appearance and adds visual interest to the space.

**ELECTRICAL** — Long-life LEDs, coupled with high-efficiency drivers, provide superior quantity and quality of illumination for extended service life. 90% LED lumen maintenance at 60,000 hours (L90/60,000).

nLight® embedded controls make each luminaire addressable - allowing it to digitally communicate with other nLight enabled controls such as dimmers, switches, occupancy sensors and photocontrols. Simply connect all the nLight enabled control devices and the AL luminaires using standard Cat-5 cabling. Unique plug-and-play convenience as devices and luminaires automatically discover each other and self-commission.

Lumen Management: Unique lumen management system (option N80) provides onboard intelligence that actively manages the LED light source so that constant lumen output is maintained over the system life, preventing the energy waste created by the traditional practice of over-lighting.

Step-level dimming option allows system to be switched to 50% power for compliance with common energy codes while maintaining fixture appearance.

eldoLED driver options deliver choice of dimming range, and choices for control, while assuring flicker-free, low-current inrush, 89% efficiency and low EMI.

Driver disconnect provided where required to comply with US and Canadian codes.

**INSTALLATION** — Surface mount. Drivers and internal components are accessible from floor. Suitable for damp location.

Maintenance: LED boards include plug-in connectors for easy replacement or servicing.

**LISTINGS** — CSA certified to US and Canadian standards. DesignLights Consortium® (DLC) qualified product. Not all versions of this product may be DLC qualified. Please check the DLC Qualified Products List at [www.designlights.org/QPL](http://www.designlights.org/QPL) to confirm which versions are qualified.

Protected by one or more of US Patent Nos. D690,868; D690,867.

|                |
|----------------|
| Catalog Number |
| Notes          |
| Type           |

**SBS Series**

SHADOW BOX SQUARE SURFACE MOUNT

GET A QUOTE >

**2SBSLX2**

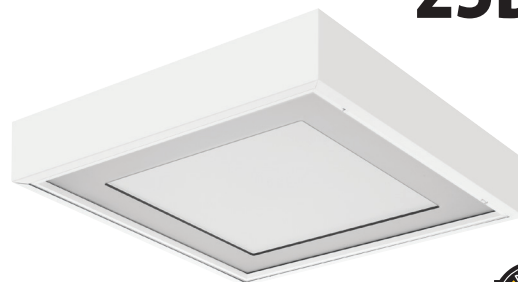

2' x 2' LED



### Specifications

Length: 24-3/4 (62.9)

Width: 24-3/4 (62.9)

Depth: 4-3/4 (12.1)

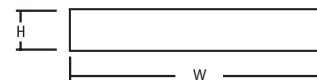

All dimensions are inches (centimeters) unless otherwise indicated.

**WARRANTY** — 5-year limited warranty. Complete warranty terms located at [www.acuitybrands.com/CustomerResources/Terms\\_and\\_conditions.aspx](http://www.acuitybrands.com/CustomerResources/Terms_and_conditions.aspx)

**Note:** Actual performance may differ as a result of end-user environment and application.

All values are design or typical values, measured under laboratory conditions at 25 °C.

Specifications subject to change without notice.

### ORDERING INFORMATION

Lead times will vary depending on options selected. Consult with your sales representative.

**Example:** 2SBSLX2 33L FW EZ1 LP835 N100

| Series   | Lumens <sup>1</sup>   | Door   | Voltage   | Driver   |
|--|---|--|---|--|
| 2SBSLX2 Surface LED 2x2                                      | 20L 2000 lumens<br>33L 3300 lumens<br>40L 4000 lumens   | FW Flush aluminum, white<br>RW Regressed aluminum, white                     | (blank) MVOLT (120-277)<br>347 347 <sup>2</sup> | EZ1 eldoLED dims to 1% (0-10 volt dimming)<br>EZB eldoLED dims to dark (0-10 volt dimming)<br>EDB eldoLED DALI <sup>3</sup><br>EXB eldoLED DMX/RDM <sup>3</sup><br>EXA1 Dims to 1%, XPoint wireless enabled <sup>3,4</sup><br>EXAB Dims to dark, XPoint wireless enabled <sup>3,4</sup><br>SLD Step-level dimming <sup>3</sup> |
| Color temperature  | Control   | Options  |   |  |
| LP830 3000 K<br>LP835 3500 K<br>LP840 4000 K<br>LP850 5000 K | (blank) No controls<br>N80 nLight with 80% (L80) lumen management<br>N80EMG nLight with 80% (L80) lumen management for use with generator supply EM power<br>N100 nLight without lumen management<br>N100EMG nLight without lumen management for use with generator supply EM power | EL7L 700 nominal lumen battery pack<br>EL14L 1400 nominal lumen battery pack |   |  |

GET A QUOTE >

### Notes

- 1 Approximate lumen output.
- 2 Not available with EL7L or EL14L battery packs or SLD driver.
- 3 Not available with N80, N80EMG, N100, or N100EMG.
- 4 Gateway not included. Requires on-site commissioning. Visit [www.lightingcontrols.com/XPointWireless](http://www.lightingcontrols.com/XPointWireless) for more information.

# 2SBSLX2 Surface Mount LED Lighting 2' x 2'

| Performance Data |         |         |             |      |
|------------------|---------|---------|-------------|------|
| Lumen            | Package | Lumens  | Input Watts | LPW  |
| 20L              | LP830   | 1,682.4 | 18          | 93.5 |
| 20L              | LP835   | 1,718.5 | 18          | 95.5 |
| 20L              | LP840   | 1,730.6 | 18          | 96.1 |
| 20L              | LP850   | 1,790.7 | 18          | 99.5 |
| 33L              | LP830   | 2,689.5 | 29          | 92.7 |
| 33L              | LP835   | 2,746.2 | 29          | 94.7 |
| 33L              | LP840   | 2,766.8 | 29          | 95.4 |
| 33L              | LP850   | 2,863.1 | 29          | 98.7 |
| 40L              | LP830   | 3,174.1 | 35          | 90.7 |
| 40L              | LP835   | 3,242.9 | 35          | 92.7 |
| 40L              | LP840   | 3,265.2 | 35          | 93.3 |
| 40L              | LP850   | 3,378.6 | 35          | 96.5 |

## MOUNTING DATA

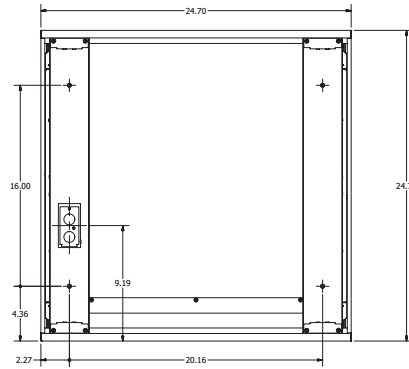

### nLight® Control Accessories:

Order as separate catalog number. Visit [www.sensorswitch.com/nLight](http://www.sensorswitch.com/nLight) for complete listing of nLight controls.

| WallPod stations     | Model number     | Occupancy sensors                              | Model number        |
|----------------------|------------------|--|---------------------|
| On/Off               | nPODM [color]    | Standard range 360°, ceiling (PIR / dual tech) | nCM 9 / nCM PDT 9   |
| On/Off & Raise/Lower | nPODM DX [color] | Extended range 360°, ceiling (PIR / dual tech) | nCM 10 / nCM PDT 10 |
| Graphic Touchscreen  | nPOD GFX         | Wide view (PIR / dual tech)                    | nWV 16 / nWV PDT 16 |
| Photocell controls   | Model number     | CAT5 cable bundles (plenum rated)              | Model number        |
| Continuous dimming   | nCM ADC          | 10', 15 pieces per bundle                      | CAT5 10FT           |
| On/Off & Dimming     | nCM PC ADC       | 30', 15 pieces per bundle                      | CAT5 30FT           |

## PHOTOMETRICS

2SBSLX2 33L EZ1 LP835, 2746.2 delivered lumens, test no. LTL26922P17, tested in accordance to IESNA LM-79.

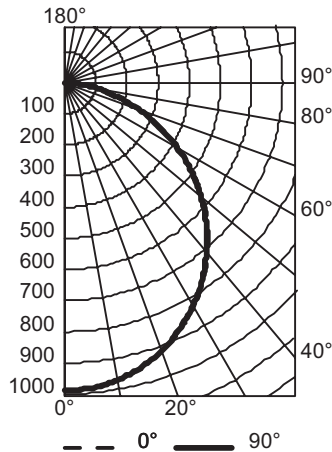

### CP Summary

|     | 0°  | 90° |
|-----|-----|-----|
| 0°  | 986 | 986 |
| 5°  | 981 | 984 |
| 15° | 949 | 946 |
| 25° | 876 | 873 |
| 35° | 775 | 770 |
| 45° | 649 | 642 |
| 55° | 503 | 497 |
| 65° | 342 | 336 |
| 75° | 182 | 176 |
| 85° | 48  | 45  |
| 90° | 0   | 0   |

### Coefficients of Utilization

| ROR | pf  | 20% |     |     |     |     |     |     |     |     |
|-----|-----|-----|-----|-----|-----|-----|-----|-----|-----|-----|
|     |     | 80% |     |     | 70% |     |     | 50% |     |     |
|     | pc  | 70% | 50% | 30% | 50% | 30% | 10% | 50% | 30% | 10% |
| 0   | 119 | 119 | 119 | 116 | 116 | 116 | 111 | 111 | 111 |     |
| 1   | 109 | 104 | 100 | 102 | 98  | 94  | 98  | 94  | 91  |     |
| 2   | 99  | 91  | 84  | 89  | 83  | 77  | 85  | 80  | 75  |     |
| 3   | 90  | 80  | 72  | 78  | 71  | 64  | 75  | 69  | 63  |     |
| 4   | 83  | 71  | 62  | 69  | 61  | 55  | 67  | 60  | 54  |     |
| 5   | 76  | 63  | 54  | 62  | 53  | 47  | 60  | 52  | 47  |     |
| 6   | 70  | 57  | 48  | 56  | 47  | 41  | 54  | 46  | 41  |     |
| 7   | 65  | 51  | 43  | 51  | 42  | 36  | 49  | 42  | 36  |     |
| 8   | 61  | 47  | 38  | 46  | 38  | 33  | 45  | 38  | 32  |     |
| 9   | 57  | 43  | 35  | 43  | 35  | 29  | 41  | 34  | 29  |     |
| 10  | 53  | 40  | 32  | 39  | 32  | 27  | 38  | 31  | 26  |     |

### Zonal Lumen Summary

| Zone       | Lumens | % Lamp | % Fixture |
|------------|--------|--------|-----------|
| 0° - 30°   | 761    | 27.7   | 27.7      |
| 0° - 40°   | 1243   | 45.3   | 45.3      |
| 0° - 60°   | 2180   | 79.4   | 79.4      |
| 0° - 90°   | 2746   | 100.0  | 100.0     |
| 90° - 120° | 0      | 0.0    | 0.0       |
| 90° - 130° | 0      | 0.0    | 0.0       |
| 90° - 150° | 0      | 0.0    | 0.0       |
| 90° - 180° | 0      | 0.0    | 0.0       |
| 0° - 180°  | 2746   | 100.0  | 100.0     |

# 2SBSLX2 Surface Mount LED Lighting 2' x 2'

## Constant Lumen Management

Enabled by the embedded nLight control, the SBSLX actively tracks its run-time and manages its light source such that constant lumen output is maintained over the system life. Referred to as lumen management, this feature eliminates the energy waste created by the traditional practice of over-lighting.

