

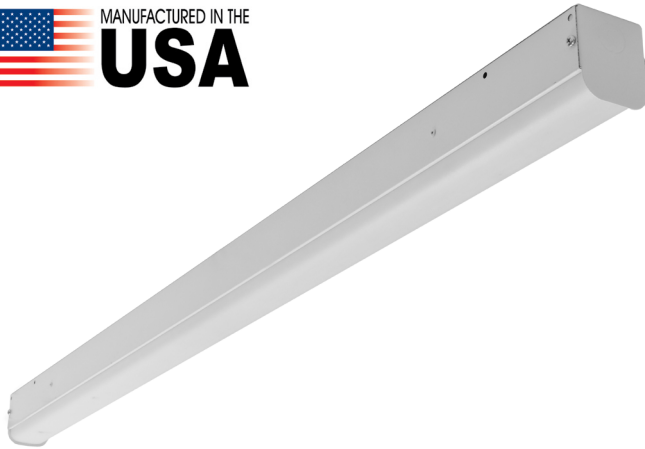

STRIP LIGHT - LED

Job Name _____ Type _____



3-STW100 SERIES

- LED Strip with Diffuser
- 22 ga. Cold Rolled Steel Housing
- Frosted White Acrylic Lens
- Baked White Polyester Finish
- Suitable for Damp Locations
- High efficiency drivers coupled with long-life LEDs, service life up to 193,000 hours (L70)
- Available with:
 - Motion Sensor
 - Emergency Battery Pack
 - Step Dimming Control



DIMENSIONS

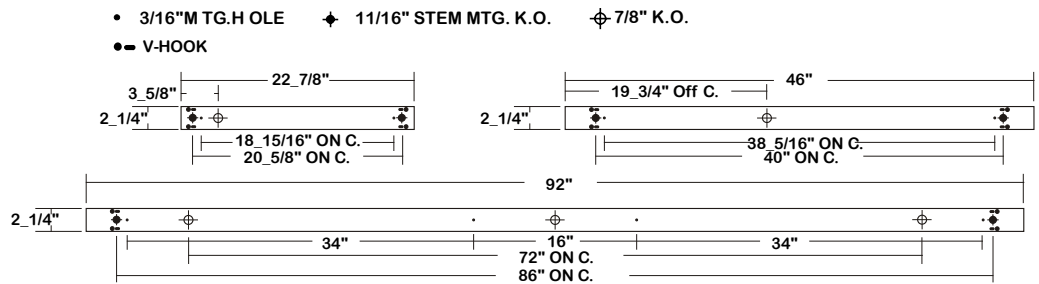
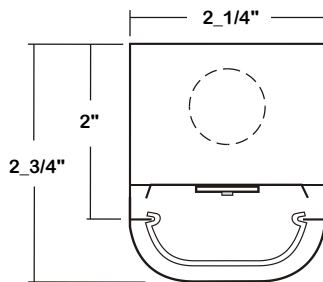

ORDERING GUIDE

Example: **3-STW100** - **6K** - **4L** - **BPL** - **1DRDM** - **UNV** - **1** / **840**

3-STW100 - [] - [] - [] - [] - **UNV** - **1** / []

- SERIES**
- LED SYSTEM LUMEN**
- 2'
 - 1K-Nominal 1000 Lumens LED System
 - 2K-Nominal 2000 Lumens LED System
 - 3K-Nominal 3000 Lumens LED System
 - 4K-Nominal 4000 Lumens LED System
 - 4'
 - 2K-Nominal 2000 Lumens LED System
 - 4K-Nominal 4000 Lumens LED System
 - 6K-Nominal 6000 Lumens LED System
 - 8K-Nominal 8000 Lumens LED System
 - 8'
 - 4K-Nominal 4000 Lumens LED System
 - 8K-Nominal 8000 Lumens LED System
 - 12K-Nominal 12000 Lumens LED System
 - 16K-Nominal 16000 Lumens LED System
- *Additional Luman Packages Available

- LENGTH**
- 2L- Nominal 2'
 - 4L- Nominal 4'
 - 8L- Nominal 8'

- ELECTRICAL OPTION**
- MS- Motion Sensor
 - BPL- Emergency Battery Pack 4' & 8' only
 - SDxx- Step Dimming Control
 - Additional Motion Sensor Options
 - Additional Electrical Options

- CR/CCT**
- 835- 80+CRI / 3500K Color Temp.
 - 840- 80+CRI / 4000K Color Temp.
 - 850- 80+CRI / 5000K Color Temp.
 - *Additional Color Temp. Available
- # OF LED ROW**
- 1- One LED Row
- VOLTAGE**
- UNV- 120V-277V
- DRIVER INFO.**
- 1DRDM- 0-10V Dimming Driver
 - 2DRDM- 0-10V Two Dimming Drivers
 - Additional Driver Options



Los Angeles Lighting Mfg. Co. El Monte / California

TEL: 626-454-8300 FAX: 626-454-8399 www.lalighting.com

STRIP LIGHT - LED

3-STW100 SERIES

SYSTEM DATA

Nominal Size	LED Lumen Package	CRI/CCT	Delivered Lumens	System Watts	Luminaire Efficacy	Fluorescent Equivalent	IES Files	Photometric Report
2'	1K	840	820 LM	9.5 W	86.3 LPW	1-F17T8	LA-T2738	 Click Here
	2K		1553 LM	18.5 W	83.9 LPW	2-F17T8	LA-T2739	
	3K		2320 LM	27.9 W	83.2 LPW	3-F17T8	LA-T2740	
	4K		3075 LM	35.9 W	85.7 LPW	4-F17T8, 2-F24T5HO	LA-T2814	

Nominal Size	LED Lumen Package	CRI/CCT	Delivered Lumens	System Watts	Luminaire Efficacy	Fluorescent Equivalent	IES Files	Photometric Report
4'	2K*	835	1424 LM	17.18 W	82.89 LPW	1-F32T8	LA-T2803	 Click Here
		840	1597 LM	16.97 W	94.11 LPW	1-F32T8	LA-T2733	
		850	1633 LM	17.38 W	93.96 LPW	1-F32T8	LA-T2805	
	4K*	835	2866 LM	34.55 W	82.95 LPW	2-F32T8	LA-T2806	
		840	3004 LM	34.21 W	87.81 LPW	2-F32T8	LA-T2807	
		850	3293 LM	35.39 W	93.05 LPW	2-F32T8	LA-T2808	
	6K	840	4648 LM	52.5 W	88.5 LPW	3-F32T8	LA-T2680	
	8K		6213 LM	66.4 W	93.6 LPW	4-F32T8, 2-F54T5HO	LA-T2815	

Nominal Size	LED Lumen Package	CRI/CCT	Delivered Lumens	System Watts	Luminaire Efficacy	Fluorescent Equivalent	IES Files	Photometric Report
8'	4K	840	3331 LM	33.1 W	100.6 LPW	2-F32T8	LA-T2735	 Click Here
	8K		6310 LM	68.1 W	92.7 LPW	4-F32T8	LA-T2736	
	12K		9236 LM	89 W	103.8 LPW	6-F32T8	LA-T2737	
	16K		12486 LM	67 W	132.8 LPW	8-F32T8	LA-T2813	

Note:
 System data above are based on 120V input voltage.
 Actual performance may differ as a result of end-user environment and application.
 Specifications subject to change without notice



ACCESSORIES

V4
 •4" Leg Height V-Hook

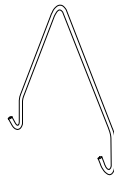

CMC-STW100
 •Chain mount coupling with Lift-Up tab for V-Hook or S-Hook
 •Only for 4' and 8' fixtures

SPECIFICATIONS

- **TYPE** LED strip with diffuser.
- **CONSTRUCTION** 22 ga. cold rolled steel housing. End plates are fastened to housing by rivets to assure rigidity.
- **FINISH** Baked white polyester finish, minimum reflectance 86%. End plates baked white powder coated finish, painted after fabrication. (Custom colors available.)
- **OPTICAL** Frosted white acrylic lens, two per 8' unit.
- **LED SYSTEM** High efficiency drivers coupled with long-life LEDs, service life greater than 50,000 hours (L70).
- **WIRING** Universal voltage 120v thru 277v.
- **WARRANTY** 5-Year Limited Warranty.
- **LISTING** U. L. Listed. Suitable for damp locations.

DesignLights Consortium® (DLC) qualified product. Not all versions of this product may be DLC qualified. Please check the DLC Qualified Products List at www.designlights.org/QL to confirm which versions are qualified.



Los Angeles Lighting Mfg. Co. El Monte / California

TEL: 626-454-8300 FAX: 626-454-8399 www.lalighting.com

LED lighting facts

3-STW100-2K-4L-1DRDM-UNV-1/835

- 2000 Lumen System
- L70 performance at 193,000 hours



LOS ANGELES LIGHTING

LED lighting facts
A Program of the U.S. DOE

Light Output (Lumens)	1424
Watts	17.18
Lumens per Watt (Efficacy)	82.89

Color Accuracy Color Rendering Index (CRI)	84
---	----

Light Color
Correlated Color Temperature (CCT) **3500 (Bright White)**

Warm White | Bright White | Daylight
2700K 3000K 4500K 6500K

LED Lumen Maintenance Projection at 36,000 Hours at 25°C Ambient*	93.44%
---	--------

All results, except LED Lumen Maintenance, are according to IESNA LM-79-2008: Approved Method for the Electrical and Photometric Testing of Solid-State Lighting. The U.S. Department of Energy (DOE) verifies product test data and results.

* Based on TM-21 projections for the light source.

Registration Number: -H7ENYV (11/10/2015)
Model Number: 3-STW100-2K-4L-1DRDM-UNV-1/835
Type: Luminaire - Linear

3-STW100-2K-4L-1DRDM-UNV-1/840

- 2000 Lumen System
- L70 performance at 193,000 hours



LOS ANGELES LIGHTING

LED lighting facts
A Program of the U.S. DOE

Light Output (Lumens)	1597
Watts	16.97
Lumens per Watt (Efficacy)	94.11

Color Accuracy Color Rendering Index (CRI)	84
---	----

Light Color
Correlated Color Temperature (CCT) **4000 (Bright White)**

Warm White | Bright White | Daylight
2700K 3000K 4500K 6500K

Warranty**	Yes
------------	-----

All results, except LED Lumen Maintenance, are according to IESNA LM-79-2008: Approved Method for the Electrical and Photometric Testing of Solid-State Lighting. The U.S. Department of Energy (DOE) verifies product test data and results.

** See www.lightingfacts.com/products for details.

Registration Number: -SK6CRM (11/10/2015)
Model Number: 3-STW100-2K-4L-1DRDM-UNV-1/840
Type: Luminaire - Linear

3-STW100-2K-4L-1DRDM-UNV-1/850

- 2000 Lumen System
- L70 performance at 193,000 hours



LOS ANGELES LIGHTING

LED lighting facts
A Program of the U.S. DOE

Light Output (Lumens)	1633
Watts	17.38
Lumens per Watt (Efficacy)	93.96

Color Accuracy Color Rendering Index (CRI)	83
---	----

Light Color
Correlated Color Temperature (CCT) **5000 (Daylight)**

Warm White | Bright White | Daylight
2700K 3000K 4500K 6500K

Warranty**	Yes
------------	-----

All results, except LED Lumen Maintenance, are according to IESNA LM-79-2008: Approved Method for the Electrical and Photometric Testing of Solid-State Lighting. The U.S. Department of Energy (DOE) verifies product test data and results.

** See www.lightingfacts.com/products for details.

Registration Number: -TG1LSI (11/10/2015)
Model Number: 3-STW100-2K-4L-1DRDM-UNV-1/850
Type: Luminaire - Linear

3-STW100-4K-4L-1DRDM-UNV-1/835

- 4000 Lumen System
- L70 performance at 193,000 hours



LOS ANGELES LIGHTING MFG. CO.

LED lighting facts
A Program of the U.S. DOE

Light Output (Lumens)	2795
Watts	33.88
Lumens per Watt (Efficacy)	82.5

Color Accuracy Color Rendering Index (CRI)	85
---	----

Light Color
Correlated Color Temperature (CCT) **3500 (Bright White)**

Warm White | Bright White | Daylight
2700K 3000K 4500K 6500K

All results are according to IESNA LM-79-2008: Approved Method for the Electrical and Photometric Testing of Solid-State Lighting. The U.S. Department of Energy (DOE) verifies product test data and results.

Visit www.lightingfacts.com for the *Label Reference Guide*.

Registration Number: -1HRZCP (12/23/2015)
Model Number: 3-STW100-4K-4L-1DRDM-UNV-1/835
Type: Luminaire - Linear



LED lighting facts

3-STW100-4K-4L-1DRDM-UNV-1/840

- 4000 Lumen System
- L70 performance at 193,000 hours



LOS ANGELES LIGHTING MFG. CO.

LED lighting facts
A Program of the U.S. DOE

Light Output (Lumens)	3004
Watts	34.21
Lumens per Watt (Efficacy)	87.81

Color Accuracy Color Rendering Index (CRI)	84
--	----

Light Color
Correlated Color Temperature (CCT) **4000 (Bright White)**

2700K 3000K 4500K 6500K

Warm White Bright White Daylight

All results are according to IESNA LM-79-2008: *Approved Method for the Electrical and Photometric Testing of Solid-State Lighting*. The U.S. Department of Energy (DOE) verifies product test data and results.

Visit www.lightingfacts.com for the *Label Reference Guide*.

Registration Number: -ZCBOD2 (12/23/2015)
Model Number: 3-STW100-4K-4L-1DRDM-UNV-1/840
Type: Luminaire - Linear

3-STW100-4K-4L-1DRDM-UNV-1/850

- 4000 Lumen System
- L70 performance at 193,000 hours



LOS ANGELES LIGHTING MFG. CO.

LED lighting facts
A Program of the U.S. DOE

Light Output (Lumens)	3293
Watts	35.39
Lumens per Watt (Efficacy)	93.05

Color Accuracy Color Rendering Index (CRI)	83
--	----

Light Color
Correlated Color Temperature (CCT) **5000 (Daylight)**

2700K 3000K 4500K 6500K

Warm White Bright White Daylight

All results are according to IESNA LM-79-2008: *Approved Method for the Electrical and Photometric Testing of Solid-State Lighting*. The U.S. Department of Energy (DOE) verifies product test data and results.

Visit www.lightingfacts.com for the *Label Reference Guide*.

Registration Number: -HFU2JD (12/23/2015)
Model Number: 3-STW100-4K-4L-1DRDM-UNV-1/850
Type: Luminaire - Linear

This Space is intentionally left blank.



PHOTOMETRIC DATA - 3-STW100 SERIES

3-STW100-1K-2L-1DRDM(ULT)-UNV-1/840(SAM)

TEST NO.=LA-T2738
 LED TYPE= 24 LED MODULE
 NO. OF MODULE=1
 SYSTEM WATT (W)=9.5
 CRI=>80
 L70(Hrs.)=50,000
 PHOTOMETRY TYPE=C

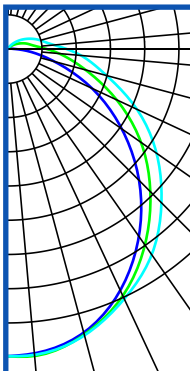
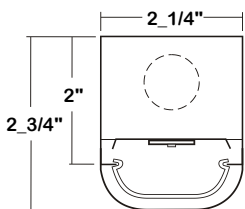

CANDLEPOWER			
ANGLE	END	45	CROSS
0	248	248	248
5	246	249	248
15	237	238	239
25	215	220	222
35	184	193	203
45	150	163	175
55	112	131	147
65	75	97	115
75	39	65	82
85	15	42	59
90	6	31	48
95	3	24	37
105	1	16	27
115	0	11	20
125	0	6	13
135	0	3	7
145	0	0	2
155	0	0	0
165	0	0	0
175	0	0	0
180	0	0	0

ZONAL LUMEN SUMMARY			
DEGREES	LUMENS	% LAMP	% FIXTURE
0-30	193	17.9	23.5
0-40	314	29.2	38.3
0-60	557	51.7	67.9
0-90	759	70.5	92.5
90-120	53	4.9	6.4
90-150	61	5.7	7.5
90-180	61	5.7	7.5
0-180	820	76.1	100.0

Luminaire Output= 820 lumens
 Luminaire Efficacy= 86.3 LPW

SPACING CRITERION	
ALONG	ACROSS
1.19	1.27

3-STW100-2K-2L-1DRDM(ULT)-UNV-1/840(SAM)

TEST NO.=LA-T2739
 LED TYPE= 32 LED MODULE
 NO. OF MODULE=1
 SYSTEM WATT (W)=18.5
 CRI=>80
 L70(Hrs.)=50,000
 PHOTOMETRY TYPE=C

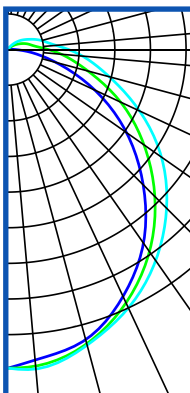
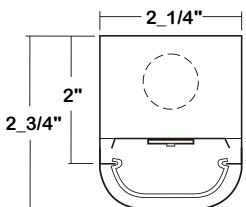

CANDLEPOWER			
ANGLE	END	45	CROSS
0	473	473	473
5	462	472	476
15	446	452	454
25	404	415	423
35	351	366	382
45	284	308	333
55	215	247	278
65	142	185	216
75	74	123	156
85	27	80	111
90	11	60	90
95	6	45	72
105	3	31	52
115	1	21	36
125	0	12	24
135	0	5	13
145	0	1	5
155	0	0	0
165	0	0	0
175	0	0	0
180	0	0	0

ZONAL LUMEN SUMMARY			
DEGREES	LUMENS	% LAMP	% FIXTURE
0-30	364	17.9	23.5
0-40	595	29.1	38.3
0-60	1055	51.7	67.9
0-90	1437	70.4	92.5
90-120	100	4.9	6.4
90-150	116	5.7	7.5
90-180	116	5.7	7.5
0-180	1553	76.1	100.0

Luminaire Output= 1553 lumens
 Luminaire Efficacy = 83.9 LPW

SPACING CRITERION	
ALONG	ACROSS
1.23	1.26

3-STW100-3K-2L-1DRDM(ULT)-UNV-1/840(SAM)

TEST NO.=LA-T2740
 LED TYPE= 48 LED MODULE
 NO. OF MODULE=1
 SYSTEM WATT (W)=27.9
 CRI=>80
 L70(Hrs.)=50,000
 PHOTOMETRY TYPE=C

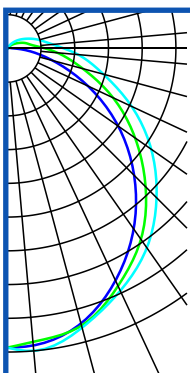
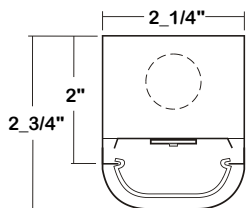

CANDLEPOWER			
ANGLE	END	45	CROSS
0	705	705	705
5	703	695	716
15	671	677	682
25	604	618	630
35	520	550	574
45	423	461	498
55	319	368	414
65	210	275	323
75	111	184	235
85	41	119	168
90	16	89	134
95	9	67	108
105	4	47	77
115	1	30	54
125	0	17	36
135	0	7	20
145	0	1	7
155	0	0	0
165	0	0	0
175	0	0	0
180	0	0	0

ZONAL LUMEN SUMMARY			
DEGREES	LUMENS	% LAMP	% FIXTURE
0-30	545	17.9	23.5
0-40	889	29.2	38.3
0-60	1576	51.7	67.9
0-90	2148	70.4	92.5
90-120	149	4.9	6.4
90-150	173	5.7	7.5
90-180	173	5.7	7.5
0-180	2320	76.1	100.0

Luminaire Output= 2320 lumens
 Luminaire Efficacy = 83.2 LPW

SPACING CRITERION	
ALONG	ACROSS
1.18	1.27

3-STW100-4K-2L-1DRDM(ULT)-UNV-1/840(SAM)

TEST NO.=LA-T2814
 LED TYPE= 72 LED MODULE
 NO. OF MODULE=1
 SYSTEM WATT (W)=35.9
 CRI=>80
 L70(Hrs.)=50,000
 PHOTOMETRY TYPE=C

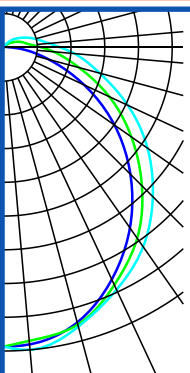
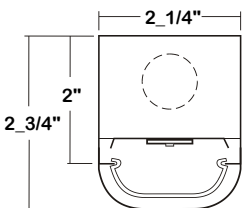

CANDLEPOWER			
ANGLE	END	45	CROSS
0	936	936	936
5	926	929	934
15	893	895	889
25	802	820	832
35	695	728	753
45	561	612	660
55	424	489	547
65	280	364	429
75	147	244	313
85	55	157	222
90	22	119	177
95	12	89	143
115	1	40	72
125	0	23	48
135	0	10	27
145	0	2	9
155	0	0	0
165	0	0	0
175	0	0	0
180	0	0	0

ZONAL LUMEN SUMMARY			
DEGREES	LUMENS	% LAMP	% FIXTURE
0-30	721	17.7	23.4
0-40	1176	29.0	38.2
0-60	2087	51.4	67.8
0-90	2845	70.1	92.5
90-120	198	4.8	6.4
90-150	230	5.6	7.4
90-180	230	5.6	7.4
0-180	3075	75.8	100.0

Luminaire Output= 3075 lumens
 Luminaire Efficacy = 85.7 LPW

SPACING CRITERION	
ALONG	ACROSS
1.19	1.26



PHOTOMETRIC DATA - 3-STW100 SERIES

3-STW100-2K-4L-1DRDM-UNV-1/835

TEST NO.= LA-T2803
 LED TYPE= 24 LED MODULE
 NO. OF MODULE=2
 SYSTEM WATT (W)=17.18
 CRI=>80
 L70(Hrs.)=50,000
 PHOTOMETRY TYPE=C

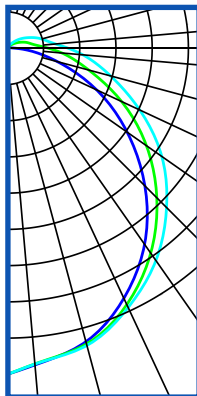
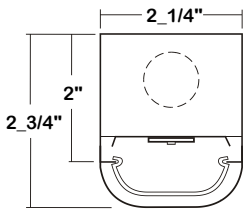
CANDLEPOWER			
ANGLE	END	45	CROSS
0	407	405	405
5	405	403	404
15	390	389	392
25	361	363	371
35	320	327	341
45	268	285	303
55	211	236	259
65	148	184	211
75	84	131	161
85	26	81	111
90	1	59	89
95	1	52	81
105	1	39	66
115	1	29	51
125	1	14	38
135	1	1	17
145	1	1	1
155	1	1	1
165	2	1	1
175	2	2	1
180	2	2	1

ZONAL LUMEN SUMMARY		
DEGREES	LUMENS	% FIXTURE
0-30	316.9	21.3
0-40	523.3	35.1
0-60	954.8	64.1
0-90	1353	90.9
90-180	136.2	9.1
0-180	1424	100.0

Luminaire Output= 1424 lumens
 Luminaire Efficacy = 82.89 LPW
 L70 Performance = 193,000 hrs

SPACING CRITERION	
ALONG	ACROSS
-	-

3-STW100-2K-4L-1DRDM-UNV-1/840

TEST NO.= LA-T2733
 LED TYPE= 24 LED MODULE
 NO. OF MODULE=2
 SYSTEM WATT (W)=16.97
 CRI=>80
 L70(Hrs.)=50,000
 PHOTOMETRY TYPE=C

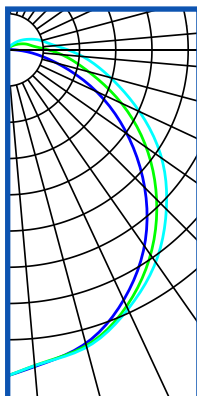
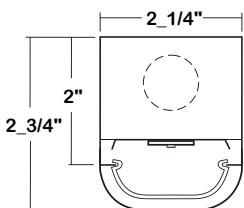
CANDLEPOWER			
ANGLE	END	45	CROSS
0	487	487	487
5	482	478	477
15	458	462	462
25	420	425	433
35	361	377	392
45	294	317	340
55	222	256	284
65	148	190	221
75	78	127	161
85	29	82	114
90	12	62	91
95	6	47	73
105	3	32	53
115	1	21	37
125	0	12	25
135	0	5	13
145	0	1	5
155	0	0	0
165	0	0	0
175	0	0	0
180	0	0	0

ZONAL LUMEN SUMMARY			
DEGREES	LUMENS	% LAMP	% FIXTURE
0-30	373	18.0	23.3
0-40	610	29.4	38.2
0-60	1084	52.2	67.8
0-90	1478	71.2	92.5
90-120	102	4.9	6.4
90-150	118	5.7	7.4
90-180	118	5.7	7.4
0-180	1597	76.9	100.0

Luminaire Output= 1597 lumens
 Luminaire Efficacy = 94.11 LPW
 L70 Performance = 193,000 hrs

SPACING CRITERION	
ALONG	ACROSS
1.19	1.26

3-STW100-2K-4L-1DRDM-UNV-1/850

TEST NO.= LA-T2805
 LED TYPE= 24 LED MODULE
 NO. OF MODULE=2
 SYSTEM WATT (W)=17.38
 CRI=>80
 L70(Hrs.)=50,000
 PHOTOMETRY TYPE=C

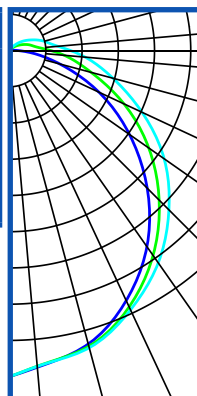
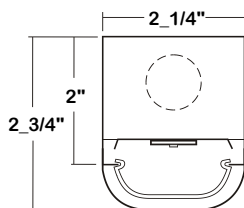
CANDLEPOWER			
ANGLE	END	45	CROSS
0	492	492	492
5	495	495	499
15	467	471	475
25	428	434	441
35	370	385	398
45	300	325	348
55	227	260	289
65	153	194	224
75	79	130	164
85	30	84	117
90	12	62	94
95	6	48	75
105	3	33	54
115	1	21	39
125	0	12	25
135	0	5	14
145	0	1	5
155	0	0	0
165	0	0	0
175	0	0	0
180	0	0	0

ZONAL LUMEN SUMMARY			
DEGREES	LUMENS	% LAMP	% FIXTURE
0-30	381	18.0	23.3
0-40	623	29.3	38.1
0-60	1107	52.1	67.8
0-90	1510	71.1	92.5
90-120	105	4.9	6.4
90-150	121	5.7	7.4
90-180	121	5.7	7.4
0-180	1633	76.9	100.0

Luminaire Output= 1633 lumens
 Luminaire Efficacy = 93.96 LPW
 L70 Performance = 193,000 hrs

SPACING CRITERION	
ALONG	ACROSS
1.20	1.26

3-STW100-4K-4L-1DRDM-UNV-1/835

TEST NO.= LA-T2806
 LED TYPE= 32 LED MODULE
 NO. OF MODULE=2
 SYSTEM WATT (W)=34.55
 CRI=>80
 L70(Hrs.)=50,000
 PHOTOMETRY TYPE=C

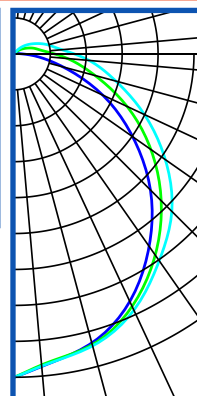
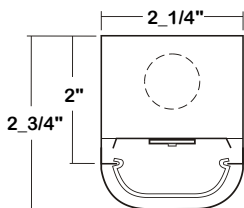
CANDLEPOWER			
ANGLE	END	45	CROSS
0	867	867	867
5	866	858	862
15	827	818	825
25	751	749	765
35	649	657	688
45	524	556	602
55	395	448	505
65	268	340	455
75	149	236	300
85	47	146	204
90	3	106	161
95	1	90	142
105	1	64	108
115	0	42	79
125	0	18	53
135	0	8	22
145	0	2	7
155	0	0	2
165	0	0	0
175	0	0	0
180	0	0	0

ZONAL LUMEN SUMMARY		
DEGREES	LUMENS	% FIXTURE
0-30	662	23.1
0-40	1079	37.6
0-60	1915	66.8
0-90	2646	25.5
90-180	220	7.7
0-180	2866	100.0

Luminaire Output= 2866 lumens
 Luminaire Efficacy = 82.95 LPW
 L70 Performance = 193,000 hrs

SPACING CRITERION	
ALONG	ACROSS
-	-



PHOTOMETRIC DATA - 3-STW100 SERIES

3-STW100-4K-4L-1DRDM-UNV-1/840

TEST NO.= LA-T2807
 LED TYPE= 32 LED MODULE
 NO. OF MODULE=2
 SYSTEM WATT (W)=34.21
 CRI=>80
 L70(Hrs.)=50,000
 PHOTOMETRY TYPE=C

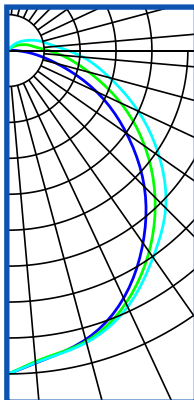
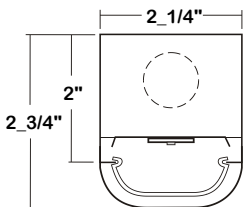

CANDLEPOWER			
ANGLE	END	45	CROSS
0	974	974	974
5	945	941	944
15	901	907	911
25	823	839	852
35	708	740	761
45	580	625	671
55	435	502	555
65	294	375	432
75	152	252	317
85	57	161	226
90	24	121	180
95	13	92	144
105	6	64	105
115	2	41	74
125	0	23	48
135	0	9	27
145	0	2	9
155	0	0	0
165	0	0	0
175	0	0	0
180	0	0	0

ZONAL LUMEN SUMMARY			
DEGREES	LUMENS	% LAMP	% FIXTURE
0-30	735	18.0	23.4
0-40	1198	29.4	38.1
0-60	2130	52.2	67.8
0-90	2907	71.3	92.5
90-120	202	5.0	6.4
90-150	234	5.7	7.5
90-180	234	5.7	7.5
0-180	3141	77.0	100.0

Luminaire Output= 3141 lumens
 Luminaire Efficacy = 83.8 LPW

SPACING CRITERION	
ALONG	ACROSS
1.17	1.23

3-STW100-4K-4L-1DRDM-UNV-1/850

TEST NO.= LA-T2808
 LED TYPE= 32 LED MODULE
 NO. OF MODULE=2
 SYSTEM WATT (W)=35.39
 CRI=>80
 L70(Hrs.)=50,000
 PHOTOMETRY TYPE=C

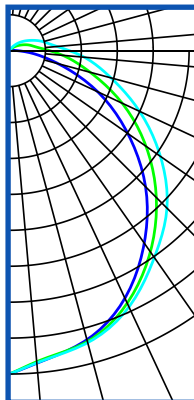
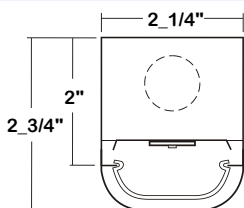

CANDLEPOWER			
ANGLE	END	45	CROSS
0	1142	1142	1142
5	1120	1128	1118
15	1091	1090	1095
25	1018	1025	1025
35	924	927	926
45	793	795	801
55	640	647	655
65	467	473	411
75	278	152	25
85	87	21	21
90	4	4	3
95	0	1	0
105	0	0	0
115	0	0	0
125	0	0	0
135	0	0	0
145	0	0	0
155	0	0	0
165	0	0	0
175	0	0	0
180	0	0	0

ZONAL LUMEN SUMMARY			
DEGREES	LUMENS	% LAMP	% FIXTURE
0-30	890	22.83	26.8
0-40	1472	37.7	44.3
0-60	2669	68.3	80.4
0-90	3314	84.9	99.9
90-120	2	0.0	0.0
90-150	2	0.0	0.0
90-180	2	0.0	0.0
0-180	3293	84.9	100.0

Luminaire Output= 3293 lumens
 Luminaire Efficacy = 93.05 LPW

SPACING CRITERION	
ALONG	ACROSS
1.26	1.26

3-STW100-6K-4L-1DRDM(ULT)-UNV-1S/840(SAM)

TEST NO.=LA-T2680
 LED TYPE= 48 LED MODULE
 NO. OF MODULE=2
 SYSTEM WATT (W)=52.5
 CRI=>80
 L70(Hrs.)=50,000
 PHOTOMETRY TYPE=C

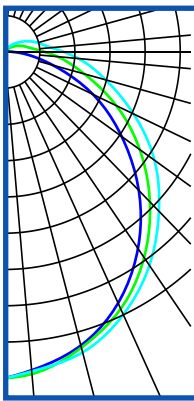
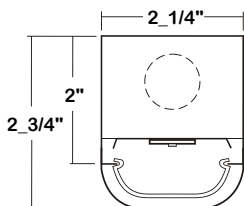

CANDLEPOWER			
ANGLE	END	45	CROSS
0	1423	1423	1423
5	1394	1410	1399
15	1326	1335	1357
25	1209	1237	1264
35	1047	1095	1137
45	854	925	983
55	644	743	824
65	439	555	641
75	226	372	472
85	84	240	334
90	36	180	266
95	18	136	212
105	9	93	154
115	2	62	110
125	0	35	70
135	0	15	40
145	0	3	14
155	0	0	0
165	0	0	0
175	0	0	0
180	0	0	0

ZONAL LUMEN SUMMARY			
DEGREES	LUMENS	% LAMP	% FIXTURE
0-30	1086	18.0	23.4
0-40	1773	29.3	38.1
0-60	3149	52.1	67.7
0-90	4302	71.2	92.5
90-120	298	4.9	6.4
90-150	346	5.7	7.4
90-180	346	5.7	7.5
0-180	4648	76.9	100.0

Luminaire Output= 4648 lumens
 Luminaire Efficacy = 88.5 LPW

SPACING CRITERION	
ALONG	ACROSS
1.18	1.25

3-STW100-8K-4L-1DRDM(ULT)-UNV-1S/840(SAM)

TEST NO.=LA-T2815
 LED TYPE= 72 LED MODULE
 NO. OF MODULE=2
 SYSTEM WATT (W)=66.4
 CRI=>80
 L70(Hrs.)=50,000
 PHOTOMETRY TYPE=C

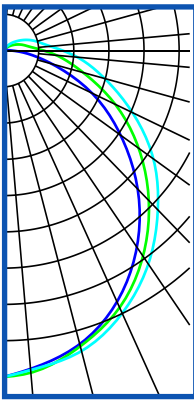
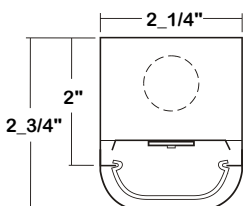

CANDLEPOWER			
ANGLE	END	45	CROSS
0	1894	1894	1894
5	1872	1879	1876
15	1795	1779	1814
25	1626	1650	1664
35	1404	1457	1507
45	1143	1239	1318
55	866	996	1093
65	578	741	861
75	302	497	627
85	112	321	450
90	46	243	354
95	25	181	285
115	3	82	145
125	0	46	95
135	0	19	53
145	0	3	18
155	0	0	0
165	0	0	0
175	0	0	0
180	0	0	0

ZONAL LUMEN SUMMARY			
DEGREES	LUMENS	% LAMP	% FIXTURE
0-30	1452	17.9	23.3
0-40	2367	29.2	38.1
0-60	4209	51.9	67.7
0-90	5750	70.9	92.5
90-120	400	4.9	6.44
90-150	463	5.7	7.4
90-180	463	5.7	7.4
0-180	6213	76.5	100.0

Luminaire Output= 6213 lumens
 Luminaire Efficacy = 93.6 LPW

SPACING CRITERION	
ALONG	ACROSS
1.19	1.25



PHOTOMETRIC DATA - 3-STW100 SERIES

3-STW100-4K-8L-1DRDM(ULT)-UNV-1SP/840(SAM)

TEST NO.=LA-T2735
 LED TYPE= 24 LED MODULE
 NO. OF MODULE=4
 SYSTEM WATT (W)=33.1
 CRI=>80
 L70(Hrs.)=50,000
 PHOTOMETRY TYPE=C

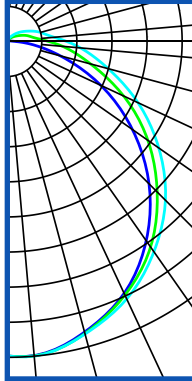
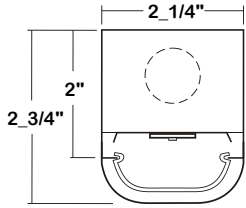

CANDLEPOWER			
ANGLE	END	45	CROSS
0	981	981	981
5	984	985	985
15	939	943	945
25	867	873	886
35	759	783	801
45	628	664	700
55	479	538	579
65	325	403	452
75	173	272	328
85	63	175	231
90	27	131	187
95	14	98	149
105	6	68	109
115	2	43	76
125	0	25	51
135	0	10	28
145	0	2	9
155	0	0	0
165	0	0	0
175	0	0	0
180	0	0	0

ZONAL LUMEN SUMMARY			
DEGREES	LUMENS	% LAMP	% FIXTURE
0-30	766	17.8	23.0
0-40	1257	29.2	37.7
0-60	2250	52.2	67.5
0-90	3083	71.6	92.6
90-120	214	5.0	6.4
90-150	248	5.8	7.4
90-180	248	5.8	7.4
0-180	3331	77.3	100.0

Luminaire Output= 3331 lumens
 Luminaire Efficacy = 100.6 LPW

SPACING CRITERION	
ALONG	ACROSS
1.23	1.27

3-STW100-8K-8L-1DRDM(ULT)-UNV-1S/840(SAM)

TEST NO.=LA-T2736
 LED TYPE= 32 LED MODULE
 NO. OF MODULE=2
 SYSTEM WATT (W)=68.1
 CRI=>80
 L70(Hrs.)=50,000
 PHOTOMETRY TYPE=C

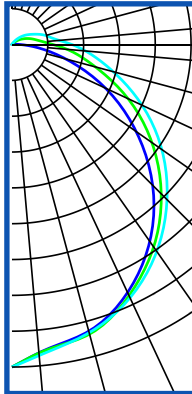
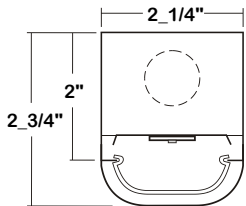

CANDLEPOWER			
ANGLE	END	45	CROSS
0	1927	1927	1927
5	1849	1850	1865
15	1774	1791	1783
25	1635	1655	1670
35	1436	1477	1509
45	1189	1262	1310
55	906	1021	1093
65	617	766	858
75	333	516	627
85	121	331	441
90	51	246	359
95	26	188	283
105	12	128	209
115	3	83	146
125	0	46	98
135	0	19	54
145	0	4	18
155	0	0	0
165	0	0	0
175	0	0	0
180	0	0	0

ZONAL LUMEN SUMMARY			
DEGREES	LUMENS	% LAMP	% FIXTURE
0-30	1449	17.8	23.0
0-40	2375	29.1	37.6
0-60	4254	52.1	67.4
0-90	5839	71.6	92.5
90-120	406	5.0	6.4
90-150	470	5.8	7.5
90-180	470	5.8	7.5
0-180	6310	77.3	100.0

Luminaire Output= 6310 lumens
 Luminaire Efficacy = 92.7 LPW

SPACING CRITERION	
ALONG	ACROSS
1.19	1.23

3-STW100-12K-8L-1DRDM(ULT)-UNV-1S/840(SAM)

TEST NO.=LA-T2737
 LED TYPE= 72 LED MODULE
 NO. OF MODULE=4
 SYSTEM WATT (W)= 89
 CRI=>80
 L70(Hrs.)=50,000
 PHOTOMETRY TYPE=C

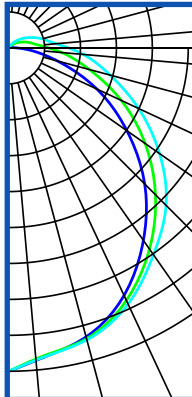
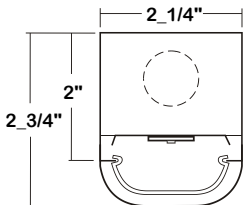

CANDLEPOWER			
ANGLE	END	45	CROSS
0	2692	2692	2692
5	2742	2721	2707
15	2623	2610	2623
25	2400	2419	2452
35	2103	2167	2208
45	1742	1837	1926
55	1331	1490	1604
65	910	1115	1251
75	478	757	918
85	184	486	647
90	77	364	522
95	38	273	414
105	19	189	302
115	1	123	212
125	0	70	142
135	0	28	78
145	0	5	25
155	0	0	0
165	0	0	0
175	0	0	0
180	0	0	0

ZONAL LUMEN SUMMARY			
DEGREES	LUMENS	% LAMP	% FIXTURE
0-30	2123	17.8	23.0
0-40	3481	29.1	37.7
0-60	6229	52.1	67.4
0-90	8547	71.6	92.5
90-120	594	5.0	6.4
90-150	688	5.8	7.5
90-180	688	5.8	7.5
0-180	9236	77.3	100.0

Luminaire Output= 9236 lumens
 Luminaire Efficacy = 103.8 LPW

SPACING CRITERION	
ALONG	ACROSS
1.24	1.27

3-STW100-16K-8L-2DRDM(ULT)-UNV-1S/840(SAM)

TEST NO.=LA-T2813
 LED TYPE= 72 LED MODULE
 NO. OF MODULE=4
 SYSTEM WATT (W)= 67
 CRI=>80
 L70(Hrs.)=50,000
 PHOTOMETRY TYPE=C

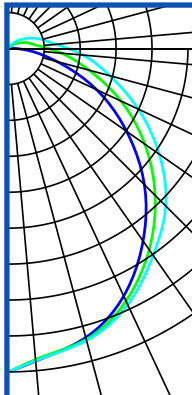
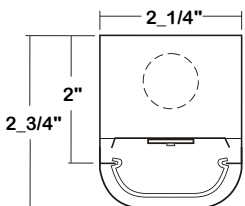

CANDLEPOWER			
ANGLE	END	45	CROSS
0	3699	3699	3699
5	3644	3667	3704
15	3538	3534	3508
25	3237	3278	3306
35	2840	2988	3001
45	2347	2488	2616
55	1799	2016	2171
65	1212	1511	1704
75	648	1018	1236
85	243	664	874
90	101	489	711
95	53	364	560
115	6	165	289
125	0	94	190
135	0	39	105
145	0	7	39
155	0	0	1
165	0	0	0
175	0	0	0
180	0	0	0

ZONAL LUMEN SUMMARY			
DEGREES	LUMENS	% LAMP	% FIXTURE
0-30	2867	17.6	22.9
0-40	4702	29.0	37.6
0-60	8422	51.9	67.4
0-90	11554	71.2	92.5
90-120	804	4.9	6.4
90-150	932	5.7	7.4
90-180	932	5.7	7.4
0-180	12486	77.0	100.0

Luminaire Output= 12486 lumens
 Luminaire Efficacy = 132.8 LPW

SPACING CRITERION	
ALONG	ACROSS
1.21	1.26

