

FINELITE

High Performance 4" Aperture (HP-4) - Recessed



Date

Project

Type

Comments

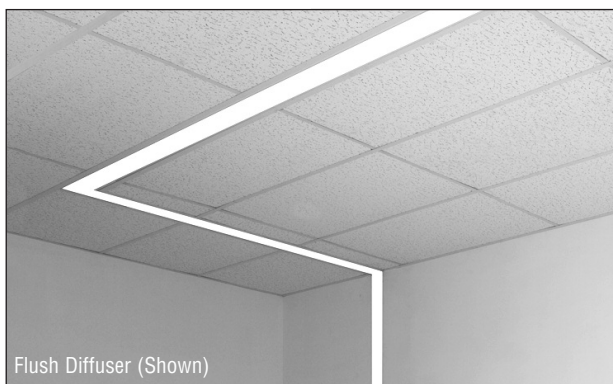

Note: See Page 2 for all aesthetic options

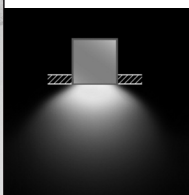

Flush Diffuser (Shown)

DESCRIPTION

High Performance 4" Aperture Recessed (HP-4 R) is a patented, linear LED luminaire. HP-4 R is the first recessed linear LED luminaire to feature On-Grid™ mounting for standard lengths, making installation quick and easy.

[GET A QUOTE >](#)

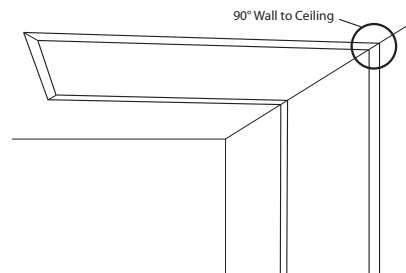
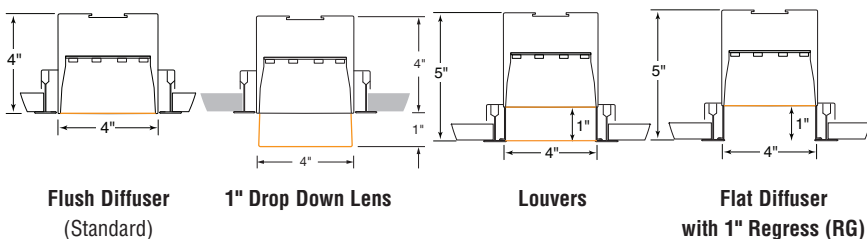

AESTHETIC SOLUTIONS

Offering multiple diffuser options with Flush, 1" Drop Down Lens, Louvers, and Regressed Diffusers for a desired aesthetic.

MITERED ANGLES

Illuminated 90° corners and wall-to-ceiling configuration are seamless without socket shadows. Custom angles are available (90° minimum on inside corners). Contact factory.

ORDERING GUIDE: Sample Number: HP-4 R - 32' - S - 835 - F - 120V - C1 - FE - SC - OBO



Finelite **HP-4 R** _____
HP-4 R RG _____
 Length (Minimum 2', increments accurate to 1/16th" (± 1/32"), standard) _____
 Light Output (**S** - Standard, **B** - Boosted Standard, **H** - High, **V** - Very High) _____
 LED CRI/CCT (**830** - 80 CRI min, 3000K, **835** - 80 CRI min, 3500K, _____
840 - 80 CRI min, 4000K, **930** - 90 CRI min, 3000K, _____
935 - 90 CRI min, 3500K, **940** - 90 CRI min, 4000K _____
 Downlight Option (**F** 1 - Flush (standard), **DL** 1 - 1" Drop Down Lens, **RG-D** 2 - Flat Diffuser with 1" Regressed, _____
RG-WCB 2,3 - White Cross Blade Baffle 4, **RG-LHE** 2,3 - Hollowed Ellipse Louver, **RG-LHC** 2,3 - Hex Louver) _____
 Voltage (**120V**, **277V**, **347V**) _____
 Circuiting (**SC** 5 - Single Circuit) _____
 Mounting (**C1** - 1" T-Bar, **C2** - 9/16" T-Bar, **C3** - screw slot, **C3F** - flush screw slot, _____
VF - Visible Flange, **C2T** - 9/16" tegular, **C1T** - 1" tegular, **SF** - Spackle Flange, _____
TZ6 (C1, C2, C2T, C3, C3T) - Tech Zone 6") _____
 Endcap (**FE** - Flat Endcap, **DE** 6 - 1" Drop Down Lens Illuminated Endcap) _____
 Integrated Sensor 7 (**OBO** - Occupancy Sensor, **OBD** - Daylight) _____

¹ Available for HP-4 Recessed only (HP-4 R)

² Available for HP-4 Recessed Regressed only (HP-4 R RG)

³ Available in 1" increments

⁴ Currently not advisable for drywall

⁵ Contact factory for switching options

⁶ Available for 1" Drop Down Lens (DL) downlight option only

⁷ Available with Flush (F), White Cross Blade Baffle (WCB), and Regressed (RG) downlight diffusers

Protected by one or more US Patents: 8915613; D702,391; D702,390; D700,732

A brand of **legrand**

Finelite, Inc. • 30500 Whipple Road • Union City, CA 94587-1530 • (510) 441-1100 • Fax: (510) 441-1510 • www.finelite.com

FINELITE

High Performance 4" Aperture (HP-4) - Recessed

AESTHETIC OPTIONS

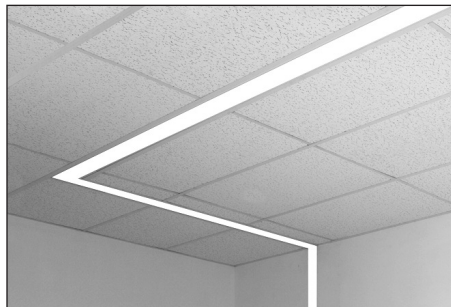

Flat Diffuser (F)



1" Drop Down Lens (DL)



Flat Diffuser with 1" Regressed (RG-D)



White Cross Blade Baffle (RG-WCB)*

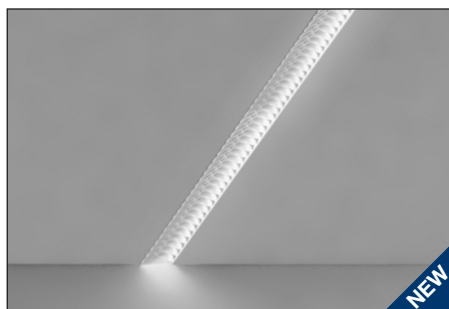

Hollowed Ellipse Louver (RG-LHE)

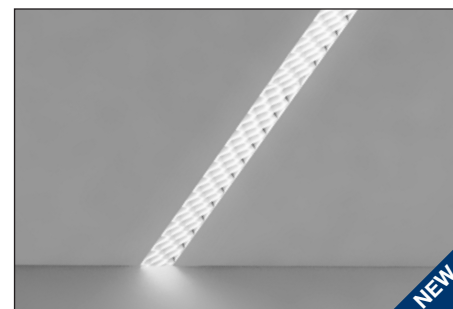

Hex Louver (RG-LHC)

* White Cross Blade Baffle (WCB) currently not advisable for drywall

Protected by one or more US Patents: 8915613; D702,391; D702,390; D700,732

A brand of 

Finelite, Inc. • 30500 Whipple Road • Union City, CA 94587-1530 • (510) 441-1100 • Fax: (510) 441-1510 • www.finelite.com

Due to continuing product improvements, Finelite reserves the right to change specifications without notice. Please visit www.finelite.com for most current data.

Page 2

FINELITE

High Performance 4" Aperture (HP-4) - Recessed

PHOTOMETRY

DOWNLIGHT: FLUSH DIFFUSER

HP-4-R-V-835

Very High Output - 4' Luminaire

Efficacy: 101 lumens per watt

Total luminaire output: 3726 Lumens (932 lumens/foot)

37 Watts (9.3 watts/foot)

Peak Candela Value: 1442 @ 0°

CCT: 3500K

CRI: 80

ITL LM79 Report 85128

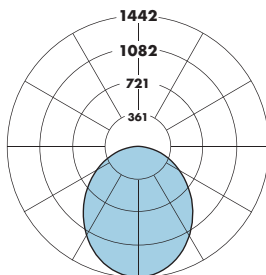

CANDELA DISTRIBUTION SUMMARY

	0.0	22.5	45	67.5	90	Flux
0	1442	1442	1442	1442	1442	
5	1434	1434	1433	1433	1434	136
15	1369	1360	1365	1364	1359	384
25	1241	1226	1232	1225	1219	566
35	1064	1053	1055	1043	1037	657
45	864	853	851	840	834	655
55	650	644	640	631	626	571
65	441	436	433	428	425	428
75	238	237	238	237	236	252
85	70	69	70	72	71	78
90	0	0	0	0	0	

Total Light Output, 3500K, 80 CRI (Lumens) - 4' Luminaire

S*	B*	H*	V**
1525	1917	2898	3726

Light Output, 3500K, 80 CRI (Lumens Per Foot)

S*	B*	H*	V**
381	479	725	932

Power (Watts Per Foot)

S*	B*	H*	V**
3.6	4.6	7.1	9.3

Efficacy, 3500K, 80 CRI (Lumens Per Watt)

S*	B*	H*	V**
105	104	102	101

S - Standard Output, B - Boosted Standard Output, H - High Output, V - Very High Output

* Family Correlation based on 4' luminaire 3500K Very High Output (V) test - 120V.

** Based on ITL report: 85128

Lumen Adjustment Factors - 80 CRI

3000K	0.985
3500K	1.000
4000K	1.032

Lumen Adjustment Factors - 90 CRI

3000K	0.746
3500K	0.760
4000K	0.789

Apply a lumen adjustment factor to calculate lumens for the desired CCT and CRI.

SAMPLE LUMEN ADJUSTMENT CALCULATION

High Output (H), 4000K, 90 CRI

Lumen Adjustment Factor = 0.789

$$\text{Total Light Output} = 2898 \text{ lm} \times 0.789 = 2287 \text{ lm}$$

$$\text{Total Light Output per Foot} = 725 \text{ lm/ft} \times 0.789 = 572 \text{ lm/ft}$$

$$\text{watts/foot} = 7.1 \text{ W/ft}$$

$$\text{Efficacy} = \frac{572 \frac{\text{lm}}{\text{ft}}}{7.1 \frac{\text{W}}{\text{ft}}} = 80 \text{ lm/W}$$



FINELITE

High Performance 4" Aperture (HP-4) - Recessed

PHOTOMETRY

DOWNLIGHT: 1" DROP DOWN LENS

HP-4-D-V-835-DL

Very High Output - 4' Luminair

Efficacy: 111 lumens per watt

Total Luminaire Output: 4097 Lumens (1024 lumens/foot)
36.9 Watts (9.2 watts/foot)

Peak Candela Value: 1251 @ 0°

CCT: 3500K

CRI: 80

ITL LM79 Report 90629

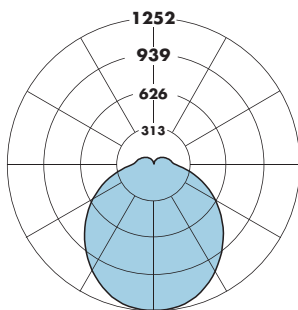

CANDELA DISTRIBUTION

	0.0	22.5	45.0	67.5	90.0	Flux
0	1251	1251	1251	1251	1251	
5	1243	1244	1247	1249	1250	119
15	1187	1188	1204	1210	1210	338
25	1077	1082	1106	1116	1117	507
35	924	940	973	986	987	603
45	752	779	818	836	841	623
55	569	604	651	677	683	572
65	382	425	477	510	520	462
75	199	249	307	345	358	312
85	50	104	165	206	219	170
90	10	61	120	160	173	
95	8	57	111	147	159	109
105	6	48	96	127	138	91
115	5	39	82	109	118	72
125	4	30	66	89	97	53
135	3	21	50	69	76	35
145	2	12	32	50	55	19
155	1	5	17	30	34	8
165	1	1	6	11	15	2
175	0	0	0	0	0	0
180	0	0	0	0	0	0

Total Light Output, 3500K, 80 CRI (Lumens) - 4' Luminare

S*	B*	H*	V**
1677	2108	3187	4097

Light Output, 3500K, 80 CRI (Lumens Per Foot)

S*	B*	H*	V**
419	527	797	1024

Power (Watts Per Foot)

S*	B*	H*	V**
3.6	4.6	7.1	9.2

Efficacy, 3500K, 80 CRI (Lumens Per Watt)

S*	B*	H*	V**
116	115	113	111

Lumen Adjustment Factors - 80 CRI

3000K	0.985
3500K	1.000
4000K	1.032

Lumen Adjustment Factors - 90 CRI

3000K	0.746
3500K	0.760
4000K	0.789

Apply a lumen adjustment factor to calculate lumens for the desired CCT and CRI.

SAMPLE LUMEN ADJUSTMENT CALCULATION

High Output (H), 4000K, 90 CRI

Lumen Adjustment Factor = 0.789

$$\text{Total Light Output} = 3187 \text{ lm} \times 0.789 = 2515 \text{ lm}$$

$$\text{Total Light Output per Foot} = 797 \text{ lm/ft} \times 0.789 = 629 \text{ lm/ft}$$

$$\text{watts/foot} = 7.1 \text{ W/ft}$$

$$\text{Efficacy} = \frac{629 \frac{\text{lm}}{\text{ft}}}{7.1 \frac{\text{W}}{\text{ft}}} = 89 \text{ lm/W}$$

S - Standard Output, B - Boosted Standard Output, H - High Output, V - Very High Output

* Family Correlation based on 4' luminare 3500K Very High Output (V) test - 120V.

** Based on ITL report: 90629

FINELITE

High Performance 4" Aperture (HP-4) - Recessed

PHOTOMETRY

DOWNLIGHT: REGRESSED DIFFUSER

HP-4-R-RG-V-835

Very High Output - 4' Luminaire

Efficacy: 94 lumens per watt

Total luminaire output: 3477 Lumens (869 lumens/foot)

38.0 Watts (9.5 watts/foot)

Peak Candela Value: 1512 @ 0°

CCT: 3500K

CRI: 80

ITL LM79 Report 85129

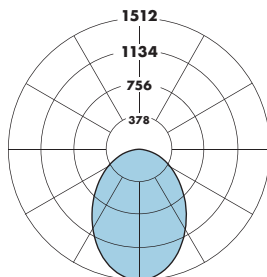

CANDELA DISTRIBUTION SUMMARY

	0.0	22.5	45	67.5	90	Flux
0	1512	1512	1512	1512	1512	
5	1504	1502	1500	1497	1497	142
15	1435	1415	1401	1387	1375	394
25	1298	1260	1232	1202	1186	568
35	1116	1068	1024	981	964	643
45	905	852	797	749	731	620
55	681	630	570	523	507	518
65	458	410	352	312	297	360
75	246	205	159	130	121	183
85	67	41	38	36	37	48
90	0	0	0	0	0	

Total Light Output, 3500K, 80 CRI (Lumens) - 4' Luminaire

S*	B*	H*	V**
1423	1789	2704	3477

Light Output, 3500K, 80 CRI (Lumens Per Foot)

S*	B*	H*	V**
356	447	676	869

Power (Watts Per Foot)

S*	B*	H*	V**
3.6	4.6	7.1	9.3

Efficacy, 3500K, 80 CRI (Lumens Per Watt)

S*	B*	H*	V**
98	97	95	94

S - Standard Output, B - Boosted Standard Output, H - High Output, V - Very High Output

* Family Correlation based on 4' luminaire 3500K 80 CRI Very High Output (V) test - 120V.

** Based on ITL report: 85129

Lumen Adjustment Factors - 80 CRI

3000K	0.985
3500K	1.000
4000K	1.032

Lumen Adjustment Factors - 90 CRI

3000K	0.746
3500K	0.760
4000K	0.789

Apply a lumen adjustment factor to calculate lumens for the desired CCT and CRI.

SAMPLE LUMEN ADJUSTMENT CALCULATION

High Output (H), 4000K, 90 CRI

Lumen Adjustment Factor = 0.789

$$\text{Total Light Output} = 2704 \text{ lm} \times 0.789 = 2133 \text{ lm}$$

$$\text{Total Light Output per Foot} = 676 \text{ lm/ft} \times 0.789 = 533 \text{ lm/ft}$$

$$\text{watts/foot} = 7.1 \text{ W/ft}$$

$$\text{Efficacy} = \frac{533 \frac{\text{lm}}{\text{ft}}}{7.1 \frac{\text{W}}{\text{ft}}} = 75.1 \text{ lm/W}$$



FINELITE

High Performance 4" Aperture (HP-4) - Recessed

PHOTOMETRY

DOWNLIGHT: WHITE CROSS BLADE BAFFLE

HP-4-D-RG-V-835-RG-WCB

Very High Output - 4' Luminaire

Efficacy: 81 lumens per watt

Total luminaire output: 3001 Lumens (750 lumens/foot)

36.9 Watts (9.2 watts/foot)

Peak Candela Value: 1636 @ 0°

CCT: 3500K

CRI: 80

ITL LM79 Report 90672

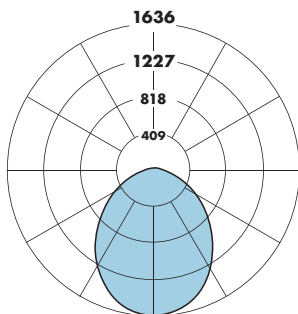

CANDELA DISTRIBUTION						
	0.0	22.5	45.0	67.5	90.0	Flux
0	1636	1636	1636	1636	1636	
5	1597	1601	1611	1623	1627	152
15	1385	1397	1449	1505	1533	408
25	1102	1121	1193	1286	1347	554
35	796	822	911	1028	1116	580
45	491	526	632	765	868	504
55	332	339	380	514	611	383
65	210	214	232	290	356	253
75	111	112	118	131	150	131
85	30	30	30	31	34	35
90	0	0	0	0	0	

Total Light Output, 3500K, 80 CRI (Lumens) - 4' Luminaire			
S*	B*	H*	V**
1228	1544	2334	3001

Light Output, 3500K, 80 CRI (Lumens Per Foot)			
S*	B*	H*	V**
307	386	584	750

Power (Watts Per Foot)			
S*	B*	H*	V**
3.6	4.6	7.1	9.2

Efficacy, 3500K, 80 CRI (Lumens Per Watt)			
S*	B*	H*	V**
85	84	82	81

S - Standard Output, B - Boosted Standard Output, H - High Output, V - Very High Output

* Family Correlation based on 4' luminaire 3500K Very High Output (V) test - 120V.

** Based on ITL report: 90672

Lumen Adjustment Factors - 80 CRI	
3000K	0.985
3500K	1.000
4000K	1.032

Lumen Adjustment Factors - 90 CRI	
3000K	0.746
3500K	0.760
4000K	0.789

Apply a lumen adjustment factor to calculate lumens for the desired CCT and CRI.

SAMPLE LUMEN ADJUSTMENT CALCULATION

High Output (H), 4000K, 90 CRI

Lumen Adjustment Factor = 0.789

$$\text{Total Light Output} = 2334 \text{ lm} \times 0.789 = 1842 \text{ lm}$$

$$\text{Total Light Output per Foot} = 584 \text{ lm/ft} \times 0.789 = 461 \text{ lm/ft}$$

$$\text{watts/foot} = 7.1 \text{ W/ft}$$

$$\text{Efficacy} = \frac{461 \frac{\text{lm}}{\text{ft}}}{7.1 \frac{\text{W}}{\text{ft}}} = 65 \text{ lm/W}$$

FINELITE

High Performance 4" Aperture (HP-4) - Recessed

Threaded Rod Option

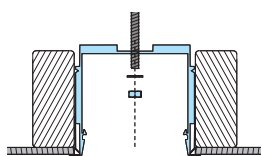

MOUNTING LOCATION FOR SECURING TO STRUCTURE

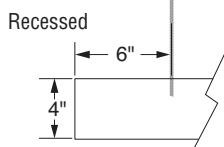

Screw Mount Option

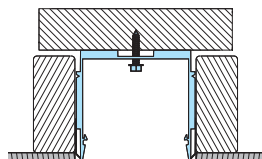

Regressed

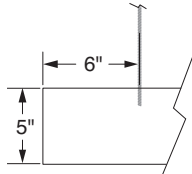

HARD CEILING MOUNTING OPTIONS

Two mounting options: threaded rod and screw mounting options. Mounting locations are located on each end of the luminaire. Mounting location is 6" away from each end of luminaire.

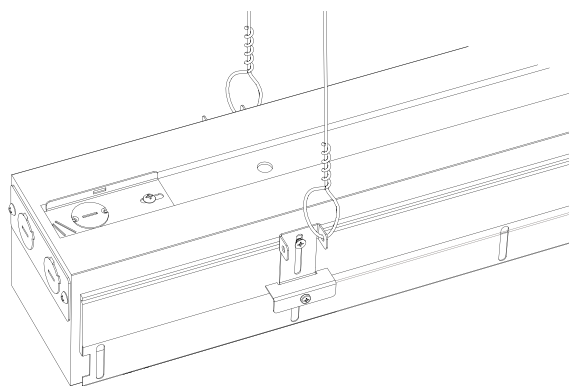

T-BAR INSTALLATION:

HP-4 R for T-Bar installations comes standard with a splice plate at the end of the luminaire. Mounting brackets (supplied) secure the luminaire to T-Bar and provide support to structure location. All even foot length (2, 4, 6, ...) luminaire runs are reduced in length by an appropriate amount to fit within typical 2x2 and 2x4 T-Bar grid systems. For uncommon T-Bar systems please consult factory.

GRID LENGTH DETAIL - 4' example

1" T-Bar

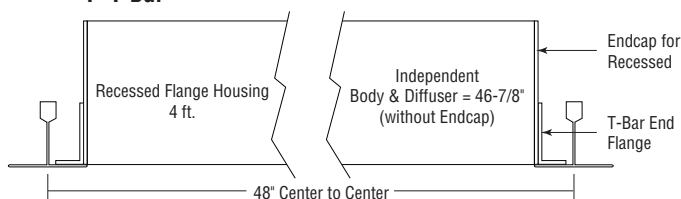

9/16" T-Bar

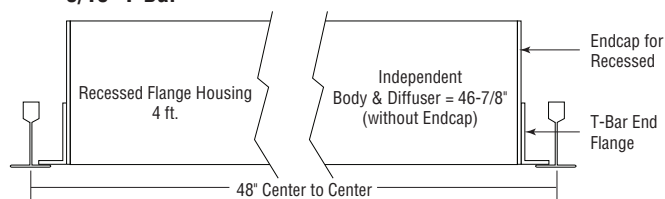

9/16" Screw Slot

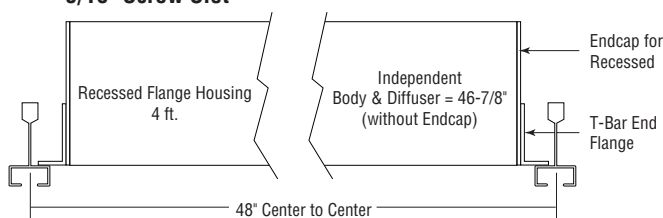

HARD CEILING LENGTH DETAIL - 4' example

Spackle Flange

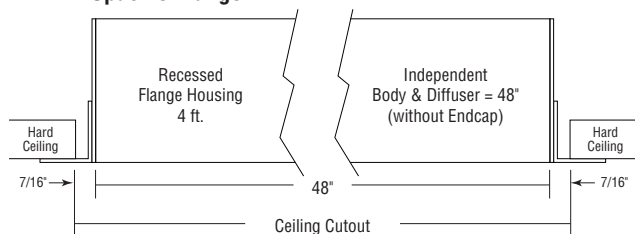

Visible Flange

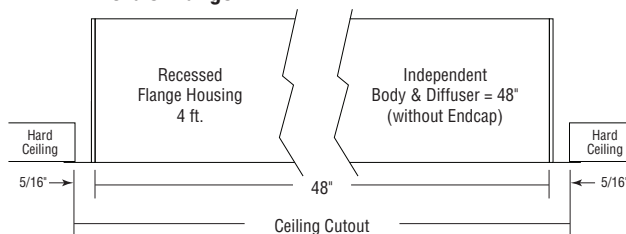

FINELITE

High Performance 4" Aperture (HP-4) - Recessed

RECESSED MOUNTING TYPES: T-BAR

Rough-In Dimensions

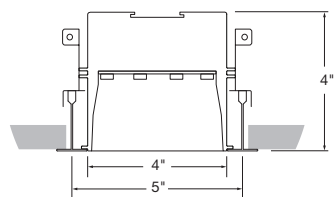

1" T-Bar (C1)

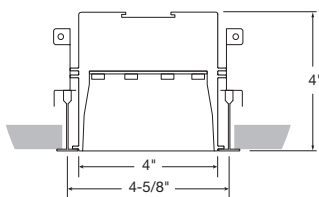

9/16" T-Bar (C2)

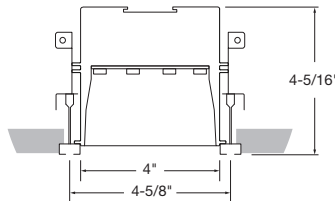

Standard Screw Slot (C3)

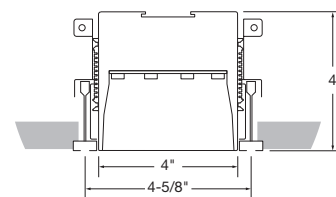

Flush Screw Slot (C3F)

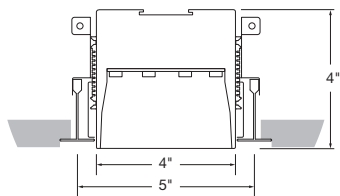

1" Tegular (C1T)

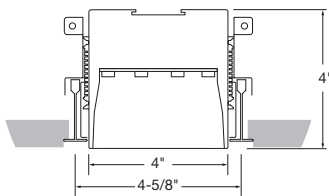

9/16" Tegular (C2T)

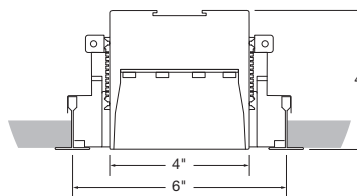

Tech Zone 6" (TZ6)
1" T-Bar (C1)

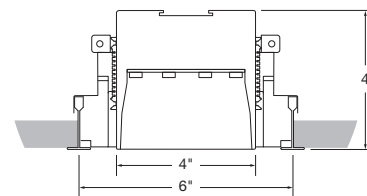

Tech Zone 6" (TZ6)
9/16" T-Bar (C2)

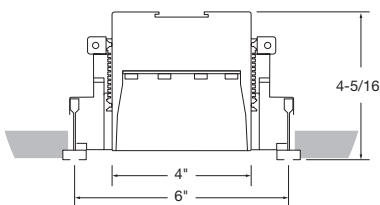

Tech Zone 6" (TZ6)
Standard Screw Slot (C3)

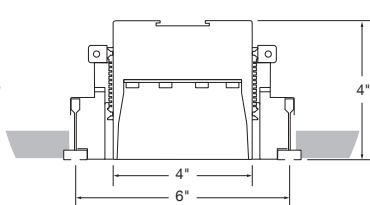

Tech Zone 6" (TZ6)
Flush Screw Slot (C3F)

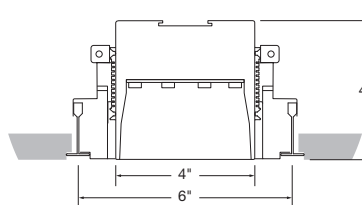

Tech Zone 6" (TZ6)
9/16" Tegular (C2T)

RECESSED MOUNTING TYPES: CUTOUT DIMENSIONS

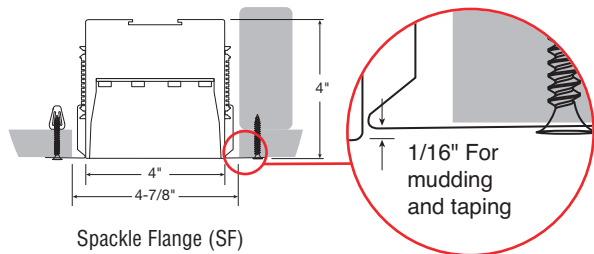

Spackle Flange (SF)

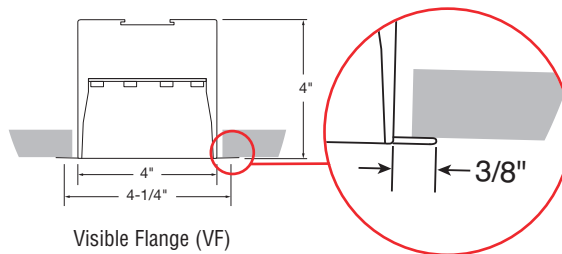

Visible Flange (VF)

HOUSING

Version 1

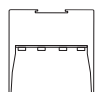

Ceiling Option
VF

Version 2



Ceiling Options
C1T, C2T, C3F, SF, TZ6

Version 3



Ceiling Options
C1, C2, C3

* Note: +/- 1/16"

Protected by one or more US Patents: 8915613; D702,391; D702,390; D700,732

A brand of Legrand

Finelite, Inc. • 30500 Whipple Road • Union City, CA 94587-1530 • (510) 441-1100 • Fax: (510) 441-1510 • www.finelite.com

Due to continuing product improvements, Finelite reserves the right to change specifications without notice. Please visit www.finelite.com for most current data.

FINELITE

High Performance 4" Aperture (HP-4) - Recessed

REGRESSED MOUNTING TYPES: T-BAR

Rough-In Dimensions

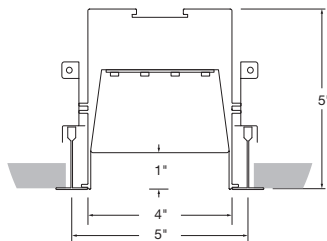

1" T-Bar (C1)

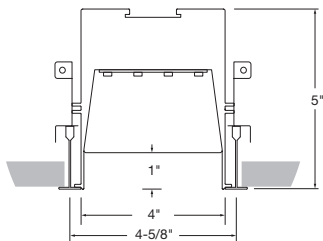

9/16" T-Bar (C2)

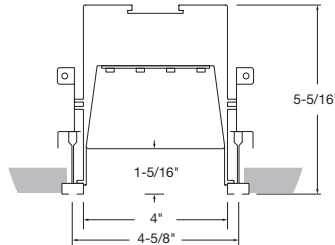

Standard Screw Slot (C3)

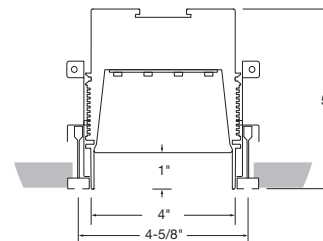

Flush Screw Slot (C3F)

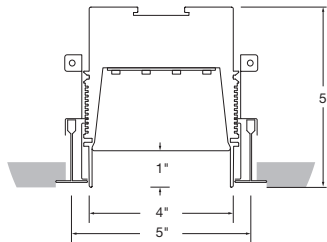

1" Tegular (C1T)

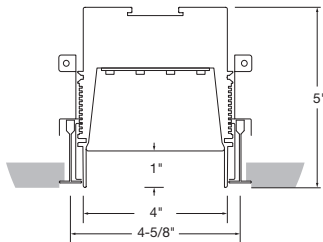

9/16" Tegular (C2T)

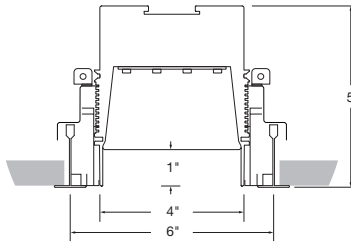

Tech Zone 6" (TZ6)
1" T-Bar (C1)

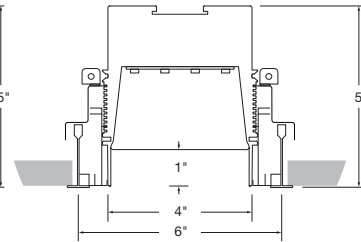

Tech Zone 6" (TZ6)
9/16" T-Bar (C2)

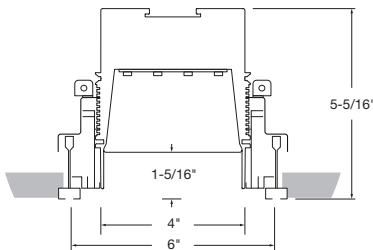

Tech Zone 6" (TZ6)
Standard Screw Slot (C3)

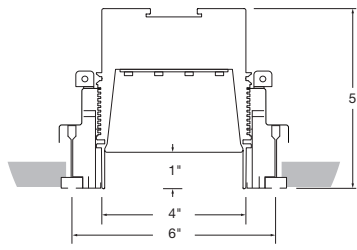

Tech Zone 6" (TZ6)
Flush Screw Slot (C3F)

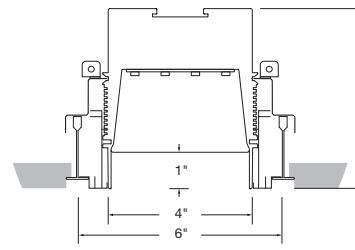

Tech Zone 6" (TZ6)
9/16" Tegular (C2T)

REGRESSED MOUNTING TYPES: CUTOUT DIMENSIONS

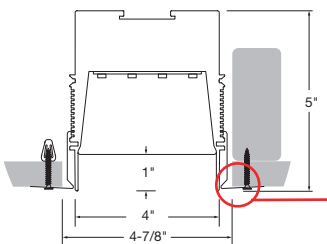

Spackle Flange (SF)

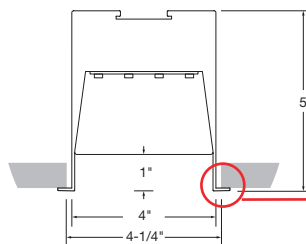
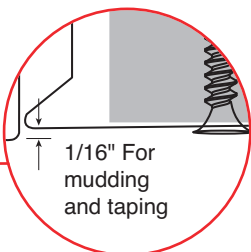

Visible Flange (VF)

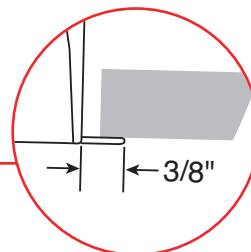

REGRESSED LENS

Regressed lens version is 5" tall with a lens that is regressed 1" from ceiling line.

HOUSING

Version 1

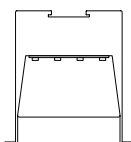

Ceiling Options
VF

Version 2

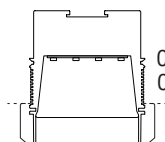

Ceiling Options
C1T, C2T, C3F,
SF, TZ6

Version 3

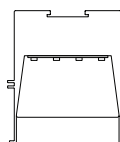

Ceiling Options
C1, C2, C3

* Note: +/- 1/16"

Protected by one or more US Patents: 8915613; D702,391; D702,390; D700,732

A brand of Legrand

Finelite, Inc. • 30500 Whipple Road • Union City, CA 94587-1530 • (510) 441-1100 • Fax: (510) 441-1510 • www.finelite.com



FINELITE

High Performance 4" Aperture (HP-4) - Recessed

SPECIFICATIONS

CONSTRUCTION: Precision-cut 6061-T6 extruded aluminum body. Internal joiner system, plug-together wiring, standard. Housing is powder coated.

ENDCAPS: Flat endcaps at each end of run add 1/16" to overall length. Drop Down Lens Illuminated Endcap (DE) includes diffuse element to continue luminance of drop lens.

MITERED CORNERS¹: Illuminated 90° corners in a single plane, available with Top Glow™, Flush upright diffuser, and/or Flush downlight diffuser, Bottom Glow Diffuser, 1" Drop Down Lens, Regressed Diffuser, or White Cross Blade Baffle. Contact factory for custom angles. 90 degree corners not available with Hollowed Ellipse Louver (LHE) or Hex Louver (LHC).

REFLECTORS: Die-formed 20-gauge cold-rolled steel reflectors are finished in 96 LG high reflectance matte white powder coat paint.

DOWNLIGHT DIFFUSER: 12' maximum diffuser length. Flush frost white snap-in diffuser standard, 73% transmissive, 99% diffusion. Internal secondary diffusers at corners ensure visually seamless, uniform, continuous illumination. Available with Flush (F), 1" Drop Down Lens (DL), White Cross Blade Baffle (WCB)², Hollowed Ellipse Louver (LHE), Hex Louver (LHC), and Regressed downlight diffusers (RG). 1" Drop Down Lens made of highly efficient acrylic.

LIGHT OUTPUT: Four lumen packages available, Standard (S), Boosted Standard (B), High (H), and Very High (V). A separate chart summarizes lumen distribution and wattage. Light engines are replaceable.

LUMEN MAINTENANCE: 90% of initial light output (L90) at 100,000+ hours; 70% of initial light output (L70) at 200,000+ hours.

DRIVER: Replaceable 120V/277V and 347V Constant Current Reduction dimming driver standard. Can be wired dimming or non-dimming. 0-10V dimming controls with a range of 10%- 100%. Dimming to 1% available; consult factory. Driver is fully accessible from below the ceiling. Power Factor: ≥ 0.9. Total Harmonic Distortion (THD) <20%. Expected driver lifetime: 100,000 hours. Dali driver also available; Contact factory.

LUTRON DRIVER OPTIONS: LUTES1 (Hi-lume 1% EcoSystem with Soft-On, Fade to Black dimming (LDE1 series)); LUTES5 (5-Series 5% EcoSystem (LDE5 Series)), LUT2W (Hi-lume 1% 2-wire, 120V forward phase dimming (LTEA series)); Contact factory for availability of discontinued Lutron drivers, L3DA-3-wire and L3DA EcoSystem.

ELECTRICAL: Optional emergency to generator/inverter wiring, internal generator transfer switch, nightlight wiring, step-dimming driver, backup battery. Chicago Plenum option. Factory-choice low-profile backup battery available. 8' minimum luminaire length for low profile battery pack. Bodine BSL722 battery pack also available; 4' minimum luminaire length. Backup battery delivers 1854 lumens. Half of a 4' section will be illuminated in emergency mode.

INTEGRATED SENSORS: Integrated PIR (Passive Infrared) occupancy and/or daylight sensors available with Flush downlight diffuser and White Cross Blade Baffle. Refer to Occupancy Sensor and Daylight Sensor tech sheets for more info.

MOUNTING: Standard bracket design works with most lay-in ceiling types. Brackets secure luminaire to the ceiling grid from above. Tie-in T-Bar brackets connect the luminaire to the T-Bar for securing to structure. Consult local codes for tie-wire recommendations.

FINISHES: Finelite Signal White powder coat standard.

FEED: Standard with one 18-gauge/5-conductor single-circuit feed. 14-gauge feed used when luminaire current exceeds 5 amps. Optional 6' flex conduit whips available.

LENGTHS: Any length, 2' minimum, in increments down to 1/16" (± 1/32"). 12' maximum section length. Hollowed Ellipse Louver (LHE), Hex Louver (LHC), and White Cross Blade Baffle (WCB) are available in 1' increments.

LABELS: Fixture and electrical components are ETL-listed conforming to UL 1598 in the U.S.A. and CAN/CSA C22.2 No. 250.0 in Canada. In accordance with NEC Code 410.130 (G), this luminaire contains an internal driver disconnect. Damp Location. Finelite products use electronic components that are RoHS compliant, and the mechanical components of the luminaire have been verified to not knowingly contain any restricted substances listed per RoHS Directive 2011/65/EU.

WEIGHT: 2.8 lb/ft.

DLC QUALIFIED: Configurations of this product are listed on the DLC Qualified Products List (QPL). www.designlights.org/search

WARRANTY: 10-year performance-based warranty on all standard components. Optional accessories such as emergency battery packs are covered by their individual manufacturer warranties.

¹ White Cross Blade Baffle (WCB) is not available with custom angles. Available in 90 degrees only

² White Cross Blade Baffle (WCB) currently not advisable for drywall