

indirect

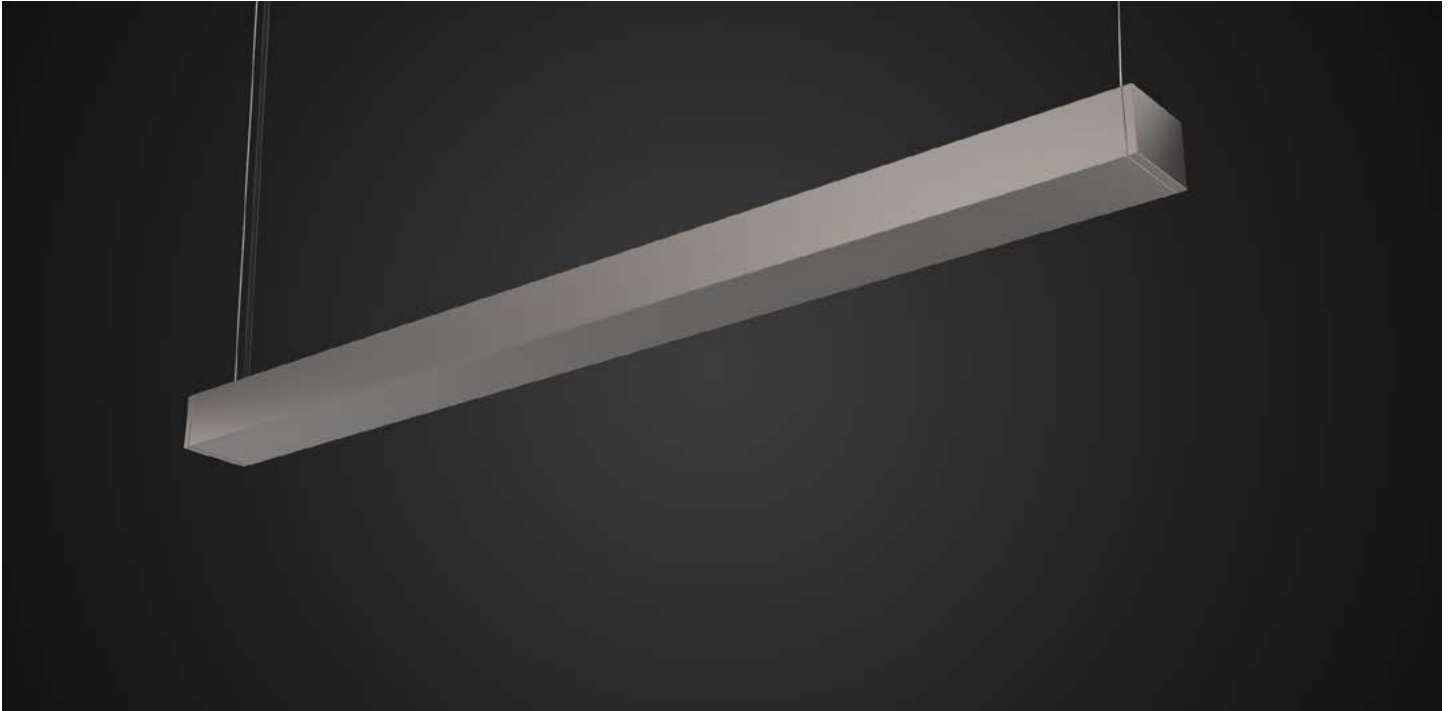

suspended

2-1/2": LED/T5  
3-1/2": T8

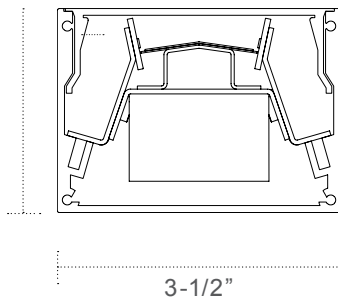

accolade 1 Lumen Guide  
LH-Dust Cover

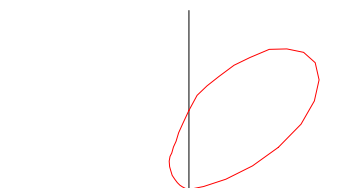
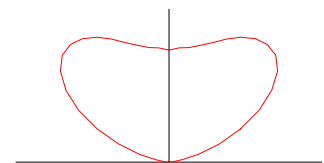
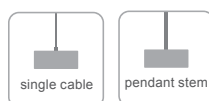
**ASYMMETRIC****Output:** 691 lm/ft**Peak Candela:** 1608cd**Nominal Wattage:** 10W/ft**Efficacy:** 73lm/W**SYMMETRIC****Output:** 1,513 lm/ft**Peak Candela:** 2095cd**Nominal Wattage:** 20W/ft**Efficacy:** 80lm/W**Available Light Platforms:****Available Mounting:**

**Linear Dimensions:**

All "elements" length dimensions are nominal, used for general length identification purposes. Actual lengths may vary by several inches. Lengths to 12' are individual fixtures and do not connect. Lengths beginning with "R" designate standard, nominal rows comprised of 4' and/or 8' sections.

For nominal lengths other than the standards available here, rows longer than 36', exact lengths, patterns, span mount, etc. see the "integrations" specification sheet.

**Output/Lamping:****LED:**

5yr warranty. L70 >60,000hr LED life. Tested to LM-79 and LM-80. Built with **high-performance Nichia® LED's**. Heat sync designed to ensure proper performance. LED boards are replaceable. Board position/quantity to be determined by factory.

**Driver:**

*Constant Current LED Systems:*

Inherent dimming  
Power Factor > 90%  
90°C case rating  
Inherent short-circuit protection  
<20% total harmonic distortion  
Extreme low-temperature performance to -40°C  
Sound rating A  
UL/CSA Listed Class 2 rating  
IP66 rated  
Universal 120-277V

**CRI:**

80CRI is standard; 90+ is available upon request.

**Standard Color Temp:**

**30 = 3000 K**

**35 = 3500 K**

**40 = 4000 K**

Consult factory for special order color temperatures.

*All specifications are subject to change.*

**Light Loss Factors:**

LH - BASELINE

LS - 50%

5000K - 105%

4000K - BASELINE

3500K - 97%

3000K - 93%

2700K - 87%

80+CRI - BASELINE

90+CRI - 80%

**T5/T5HO:**

Single, dual or staggered lamps in cross section. Program start is factory standard.

**T8:**

Single lamp in cross section. 3-1/2" x 3-1/2" housing is required. Instant start is factory standard: choose low <0.8BF; standard 0.8-1.0BF; high >1.0BF. Specify if program start or custom ballast factor is required.

**Construction:**

60% recycled aluminum extruded housing. Precision milled endcaps.

**Mounting:****Single Cable.**

4', 1mm stainless steel aircraft cable w/ fully adjustable grippers and locking device. 5' plastic-coated, silver-braided, flexible cord. Satin white, square canopy is standard. [View installation instructions.](#)

**Pendant/Stem.**

3/8" stem and round canopy, painted white. Indicate pendant length. If specified for earthquake zone, a-light will provide swivel canopies.

**Finish:**

Electrostatically applied powder coat finish. For custom color requests please contact factory.

**Listing:**

UL/CUL. Damp Location.

**Wet Label:**

Use accolade1 Integrations for Wet Label. Indirect Wet Label requires collaboration with our [Design Assist Department](#).

**Multi-circuit:**

For custom configuration use D1 integrations

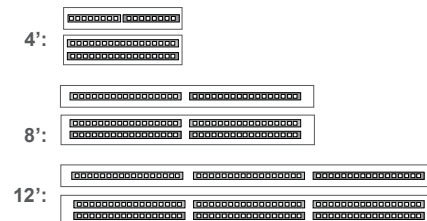
**Family Luminaires:**

D3 suspended/ceiling/wall, D4 wall, D5 recessed

**Companion Luminaires:**

ACL1 suspended, ACL2 suspended/ceiling/wall, ACL4 wall, G1 suspended, G4 wall

Series: **D1****Linear Dimension:**

Nominal 4'	<b>4</b>
Nominal 8'	<b>8</b>
Nominal 12'	<b>12</b>
Nominal 16'	<b>R16</b>
Nominal 20'	<b>R20</b>
Nominal 24'	<b>R24</b>
Nominal 28'	<b>R28</b>
Nominal 32'	<b>R32</b>
Nominal 36'	<b>R36</b>

**Output:**

LED standard output	<b>LS</b>
LED high output	<b>LH</b>

**Color Temp:**

3000k	<b>30</b>
3500k	<b>35</b>
4000k	<b>40</b>

**Voltage:**

universal 120V - 277V	<b>U</b>
347V	<b>3</b>

**Distribution:**

Symmetric two board batwing	<b>M</b>
Symmetric one board	<b>G</b>
asymmetric	<b>N</b>

**Optics:**

open/no lens	<b>O</b>
rigid diffuse dust cover	<b>D</b>

**Mounting:**

single aircraft cable	<b>S</b>	
pendant / rigid stem	<b>P</b>	
pendant / rigid stem (earthquake zone)	<b>PV</b>	indicate stem length (1.00 - 36.00) contact factory for lengths over 36.00

**Finish:**

a-lightanium™	<b>T</b>
satin white	<b>W</b>
satin black	<b>B</b>

**Options:**

Standard 0-10 dimming	<b>D</b>	
emergency - battery	<b>E1</b>	(1) IOTA ISL CP-12 located at one end of the luminaire. For custom configuration, or multiple em sections, see D1 integrations
external fusing	<b>F</b>	
multi-circuit	<b>M</b>	Standard multi-circuiting: see page 2 for standards
new york city code	<b>N</b>	
occupancy sensor	<b>O</b>	Standard on/off occupancy sensor: Wattstopper FS-205 with minimal 1" diameter
photocell/daylight sensor	<b>P</b>	Standard fixture-integrated dimming photosensor: Wattstopper FS-301

Series: **D1****Linear Dimension:**

nominal 4'	<b>4</b>
nominal 8'	<b>8</b>
nominal 12'	<b>12</b>
Nominal 16'	<b>R16</b>
Nominal 20'	<b>R20</b>
Nominal 24'	<b>R24</b>
Nominal 28'	<b>R28</b>
Nominal 32'	<b>R32</b>
Nominal 36'	<b>R36</b>

**Lamping:**

T5 single lamp	<b>S</b>	
T5HO single lamp	<b>H</b>	
T5 dual lamp	<b>D</b>	
T5HO dual lamp	<b>O</b>	
T5 staggered	<b>2</b>	Staggered lamping not available on lengths less than 8ft. 8ft length uses 3-3ft lamps. 12ft uses 2-3ft and 2-4ft lamps.
T5HO staggered	<b>4</b>	
T8 single lamp low output	<b>T8L</b>	T8 requires larger housing: 3-1/2"x 3-1/2"
T8 single lamp standard output	<b>T8S</b>	
T8 single lamp high output	<b>T8H</b>	

**Voltage:**

universal 120V - 277V	<b>U</b>
120V	<b>1</b>
277V	<b>2</b>
347V	<b>3</b>

**Distribution:**

symmetric	<b>M</b>
asymmetric w/ sawtooth	<b>T</b>
asymmetric w/o sawtooth	<b>N</b>

**Optics:**

open/no lens	<b>O</b>
clear dust cover	<b>D</b>

**Mounting:**

single aircraft cable	<b>S</b>	
pendant / rigid stem	<b>P</b> __	indicate stem length (1.00 - 36.00) contact factory for lengths over 36.00
pendant / rigid stem (earthquake zone)	<b>PV</b> __	

**Finish:**

a-lightanium™	<b>T</b>
satin white	<b>W</b>
satin black	<b>B</b>

**Options:**

Standard 0-10 dimming	<b>D</b>	
Emergency - battery	<b>E1</b>	(1) em located at one end of the luminaire. For custom configuration, or multiple em sections, see D1 integrations 0-10 dimming required
external fusing	<b>F</b>	
multi-circuit	<b>M</b>	Standard multi-circuiting: see page 2 for standards
new york city code	<b>N</b>	
occupancy sensor	<b>O</b>	Standard on/off occupancy sensor: Wattstopper FS-205 with minimal 1" diameter
photocell/daylight sensor	<b>P</b>	Standard fixture-integrated dimming Photosensor: Wattstopper FS-301