

T-BAR INSTALLATION INSTRUCTIONS:

12100-20 / 23 / 40 / 44 / 66

APPLICATION: General/Perimeter Lighting



STOP! - READ THIS FIRST! - IMPORTANT SAFETY INSTRUCTIONS!

- For information on how to recycle LED/Fluorescent electronic products, please visit www.epa.gov.
- Do not install damaged products. This fixture is properly packed to prevent damage during transit.
- All wiring connections should be capped with UL approved and recognized wire connectors.
- Do not touch LED diodes or any connecting clips.
- Do not exceed maximum wattage marked on fixture label.

Carefully read the instructions pertaining to your fixture thoroughly. IF YOU HAVE ANY QUESTIONS REGARDING THE PROPER INSTALLATION OR LOCAL CODES, CONSULT A QUALIFIED ELECTRICIAN.	To reduce risk of injury or damage, mount only to a structurally sound surface.
Both cord set and hard-wired fixture are intended for connection to a grounded, three-wire source of supply.	Install and wire the fixture in locations in accordance with state and local codes.
Do not install outdoors or in applications beyond the intended use.	To avoid shock hazard, do not work with live electrical wires.
Ensure fixture is properly grounded before testing.	This fixture is intended for dry applications only.



WARNING: THIS PRODUCT MUST BE INSTALLED IN ACCORDANCE WITH THE APPLICABLE INSTALLATION CODE BY AN ELECTRICIAN AND A PERSON FAMILIAR WITH THE CONSTRUCTION AND OPERATIONS OF THE PRODUCT AND THE HAZARDS INVOLVED.



WARNING: RISK OF FIRE; MINIMUM OF 90°C SUPPLY CONDUCTOR SHOULD BE USED. CONSULT A QUALIFIED ELECTRICIAN TO ENSURE CORRECT BRANCH CIRCUIT CONDUCTOR.



WARNING: TO AVOID ELECTRIC SHOCK HAZARD, DISCONNECT THE POWER AT THE PANEL BOARD (CIRCUIT BREAKER BOX) BEFORE BEGINNING INSTALLATION.



WARNING: TO AVOID FIRE HAZARD RISK, WHEN INSTALLING HARD WIRED UNITS, BE AWARE IF SUPPLY WIRES ARE LOCATED WITHIN THREE INCHES OF BALLAST. IF SO, USE WIRE RATED FOR AT LEAST 90°C (194°F). IF UNSURE, CONSULT A QUALIFIED ELECTRICIAN BEFORE INSTALLING.

RECESSED T-BAR INSTALLATION

The T-bar variant of the Continuum Series™ is built to easily install and integrate into the standard grid ceilings in modern interior spaces. The luminaire's flange conveniently hides any imperfections in cuts to the tile, creating a clean, seamless look.

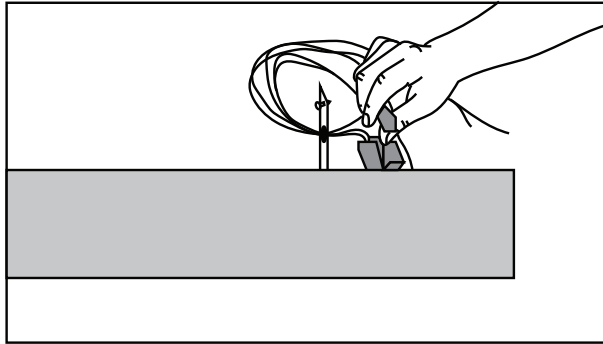

Step 1: Shut off power. Remove ceiling tile from desired light fixture location. Remove knockout plate. Remove pigtail.

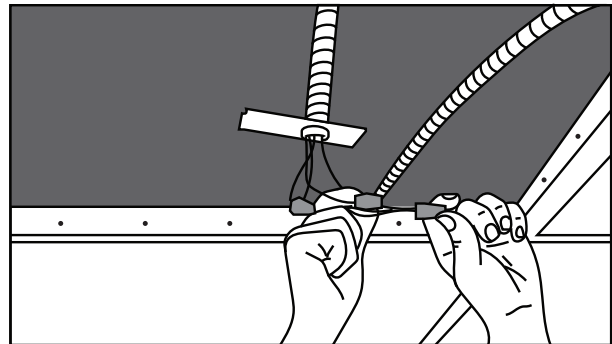

Step 2: Mount knockout plate to flex conduit. Connect pigtail to conduit wires.

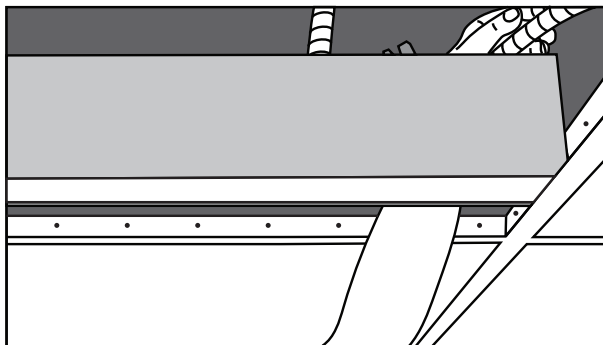

Step 3: Lay luminaire in grid at desired position. Secure fixture to structure above using structural wire (by others) via holes in the end plates.

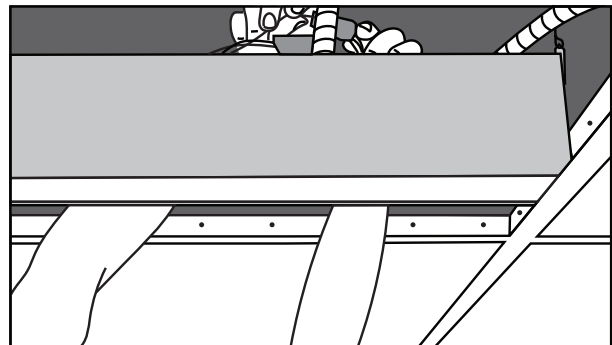

Step 4: Connect pigtail disconnects to luminaire disconnects. Insert wires into housing. Insert knockout plate and fasten using screw provided.

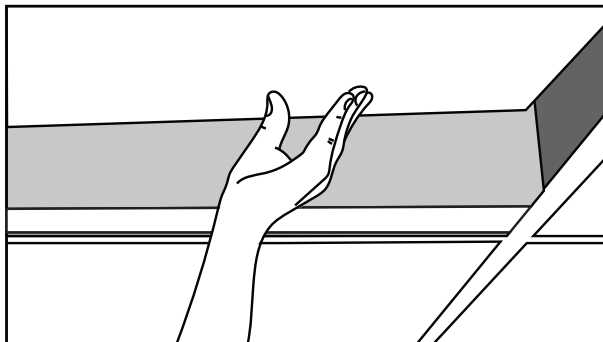

Step 5: Cut tile to fit beside luminaire and install on both sides of the luminaire.

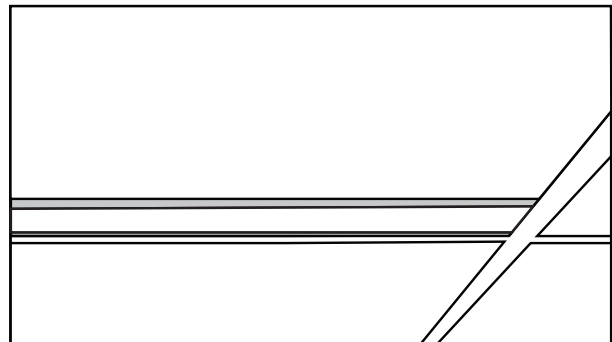

Step 6: Power can now be turned on.