



DynaMax Structural Aluminum Suspension System

This fully accessible and flexible system allows you to support heavy point loads to provide a solution for various ceiling applications and requirements.

KEY SELECTION ATTRIBUTES

- Ideal combination of a finished ceiling system with a structural solution
- Easy integration into a conventional grid system using AXTBC clip and DynaMax® boss channels
- Integrates seamlessly with select Armstrong® ceiling panels for a complete ceiling system solution
- Supports up to a 1,200 lb. point load rating using 3/8"–16 threaded rod at 48" x 48" connection points
- Suspension system has continuous threaded boss channel, allowing 3/8"–16 threaded rod to be installed to the suspension system at any location
- Available in 24" x 24", 24" x 48" and 48" x 48" suspension system layouts
- CNC override feature creates a tight fit minimizing air leakage between plenum and occupied space
- Fully accessible system allows for future expansion and upgrades
- Non-progressive installation gives the ability to remove or replace a section of the system without the need to dismantle those components around it
- Cross tees not bearing any load are removable for plenum access without compromising the structural integrity of the system
- 10-Year Limited Warranty; 30-Year Limited System Warranty
- X-Brackets provide attachment points for 48" x 48" suspension from building structure
- Now available with MetalWorks™ ceiling panels
- For custom layout information and technical guidelines, contact TechLine customer support at 877 276-7876

For Data Center Applications

- Provides a suspension platform or attachment for data center cable trays, equipment, partitions and hot and cold aisle containment barriers
- Finished ceiling system offers a containment barrier to protect servers from debris from building structure to below the ceiling plane
- Controls airflow by eliminating penetrations
- Grid provides increased temperature and pressure management, reduced leakage, and enables the best hot and cold air containment at the ceiling plane when compared to other ceiling types
- Available with Ultima® AirAssure® panels with factory-gasketed edges to provide even greater temperature and pressure management
- Lighting, diffuser, and containment options are available from our Data Center lighting and MEP partners

TYPICAL APPLICATIONS

- Data Centers
- Laboratories
- Hospitals
- Industrial Warehouses/
Distribution Centers
- Retail/Convenience Store

COLORS

Standard



White (WH)



Available in any color!

White is standard color for main beams and cross tees. All brackets and hardware are unfinished. Custom colors and finishes are available for main beams, cross tees, perimeter molding, and ceiling panels. Contact Armstrong Customer Service 877 276-7876



DYNAMAX®

Structural Aluminum Suspension System



RECYCLED
CONTENT

LEED V5

Ecomedes Data

UP TO
50%

COMMON MATERIALS FRAMEWORK

Human Health	Declare Label	Climate Health	EPD
	HPD	Ecosystem Health	EPD
	3 rd Party CDPH	Circular Economy	✓

Well Building Standard™ (WELL)
Living Building Challenge® (LBC)

VISUAL SELECTION

	Item No.	Description	Dimensions (Inches) L x W x H	PCS/ CTN	LF/ CTN
DynaMax® Structural Aluminum Data Center Suspension System	DM4301	Main Beam	144 x 2 x 2-3/8"	4	48
	DM4320	2' Cross Tee	24 x 2 x 2-3/8"	12	24
	DM4340	4' Cross Tee	48 x 2 x 2-3/8"	12	48
	DM4800	Perimeter Molding	144 x 2-1/8 x 2-1/2"	4	48
DynaMax® Structural Aluminum Data Center Suspension System – Factory-Gasketed	DM4301GS	Main Beam	144 x 2 x 2-3/8"	4	48
	DM4320GS	2' Cross Tee	24 x 2 x 2-3/8"	12	24
	DM4340GS	4' Cross Tee	48 x 2 x 2-3/8"	12	48
	DM4800GS	Perimeter Molding	144 x 2-1/8 x 2-1/2"	4	48

PACKAGING

NOTE: Contact local engineer for job-specific load and/or seismic requirements.

ACCESSORIES

DMXB – X-Bracket
Used to connect all cross tees together for rigid connection

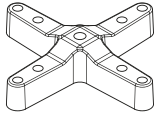

DMXB – 24 PCS

DMTB – T-Bracket –
Used to connect main beams and cross tees to the perimeter extrusion

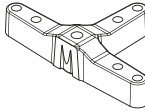

DMTB – 36 PCS

DMLB – L-Bracket –
Used to connect perimeter extrusion corners together

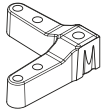

DMLB – 12 PCS

DMIB – I-Bracket –
Used to splice together main beam ends

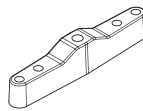

DMIB – 24 PCS

DMHWK – Hardware Kit –
Turnbuckles and threaded rods are used to connect the X-brackets to the threaded rod to create a structural support for the grid

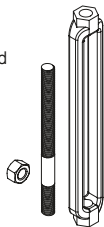

DMHWK – 12 PCS

DMBSP – DynaMax Main Beam Splice Plate –
Used with DMIB I-Bracket to splice together main beams that butt up against one another

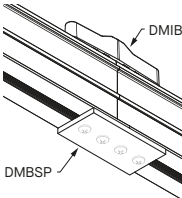

DMBSP – 24 PCS

OPTIONAL ACCESSORIES

DMHDC – Hold-down Clip –
Attaches to the suspension system to hold Lay-in panels in place

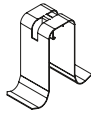

DMHDC – 100 PCS

NON-STRUCTURAL CEILING ADAPTER ACCESSORIES

AXTBC – Axiom® T-Bar Connector Clip –
Provides positive mechanical lock with factory-installed screw. Screw-fastened connection to suspension members that intersect the trim channel.

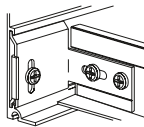

AXTBC – 1 PC

AX4SPliceB – Axiom Splice Plate with Set Screws –
Join straight sections of light cove together

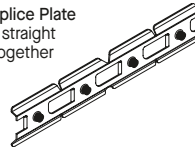

AX4SPliceB – 1 PC

DETAILS

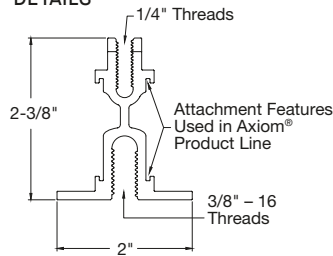

DynaMax Main Beam

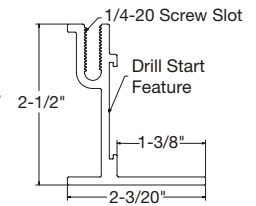

DM4800 Perimeter Molding

LOAD DATA FOR DYNAMAX SUSPENSION SYSTEMS

Member Span and Spacing (IN.)	48"
Maximum Allowable Uniform Area Load (LBS/SF)	75
Mid-Span Point Load @ L/360 Deflection (LBS)	320
Mid-Span Point Load @ L/240 Deflection (LBS)	480
Maximum Static Point Load (LBS)	1200
Turnbuckle Maximum Load to Structure (LBS)	1200

DYNAMAX®
Structural Aluminum Suspension System

SUSTAIN
High Performance
Sustainable Ceiling Systems

Declare.

RECYCLED
CONTENT

UP TO
50%

LEED V5

COMMON MATERIALS FRAMEWORK

Human Health **Declare Label**
HPD
3rd Party CDPH

Ecomedes Data

Climate Health **EPD**
Ecosystem Health **EPD**
Circular Economy **✓**

Well Building Standard™ (WELL)
Living Building Challenge® (LBC)

DYNAMAX® SUSPENSION SYSTEM INSTALLATION OVERVIEW

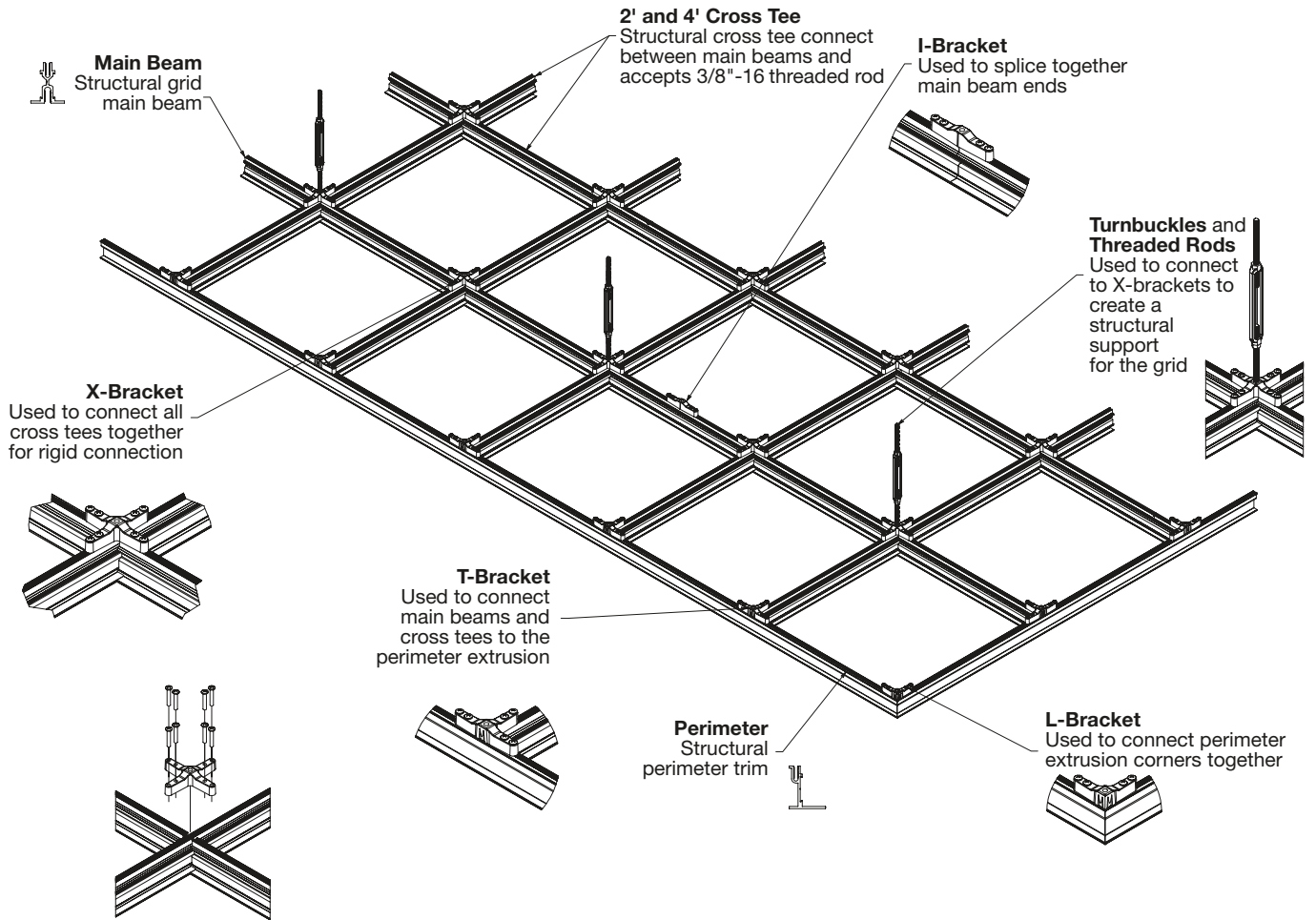

SUSPENSION SYSTEMS – DATA CENTERS

DYNAMAX®

Structural Aluminum Suspension System



RECYCLED
CONTENT

LEED V5

Ecomedes Data

UP TO
50%

COMMON MATERIALS FRAMEWORK

Human Health	Declare Label	Climate Health	EPD
	HPD	Ecosystem Health	EPD
	3rd Party CDPH	Circular Economy	✓

Well Building Standard® (WELL)
Living Building Challenge® (LBC)

LIGHTING PARTNERS Lighting and diffuser solutions are available through partner companies.



For compatible lighting details, visit axislighting.com



TRAYFIT™ 2' x 2'

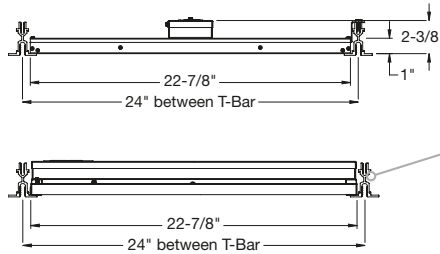

TRAYFIT™ 2' x 4'

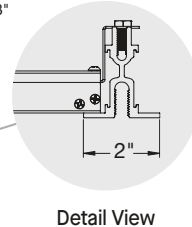
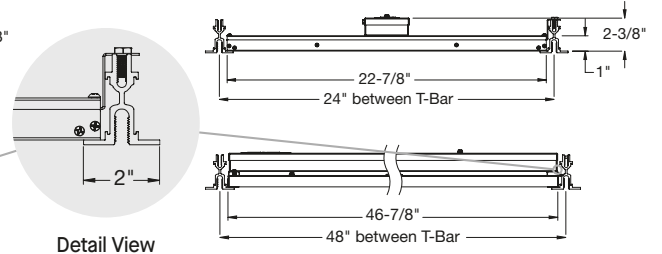

For compatible lighting details, visit hew.com/products/PTDC



PTDC – Shallow Plenum LED Troffer for DynaMax® System

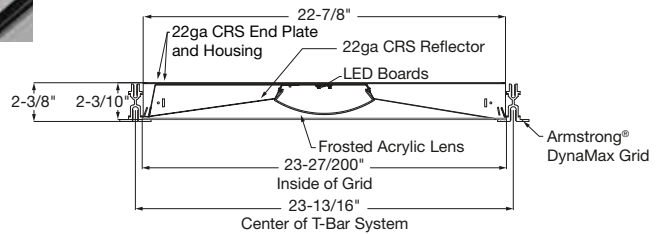
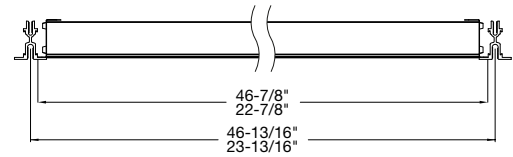

For compatible lighting details, visit vode.com/dynamax



ZipTwo® Data Center Solutions

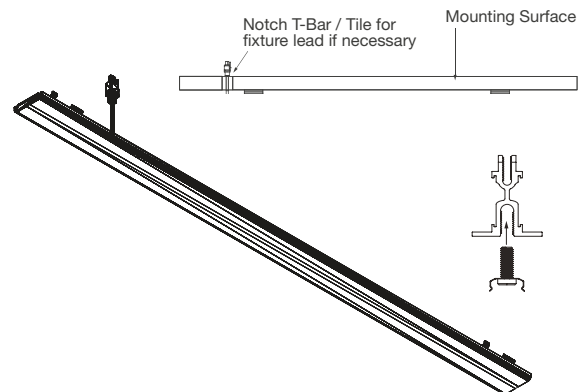

SUSPENSION SYSTEMS – DATA CENTERS

DYNAMAX®
Structural Aluminum Suspension System



RECYCLED CONTENT

UP TO
50%

LEED V5

COMMON MATERIALS FRAMEWORK

Human Health **Declare Label**
HPD
3rd Party CDPH

Ecomedes Data

Climate Health **EPD**
Ecosystem Health **EPD**
Circular Economy **✓**

Well Building Standard™ (WELL)
Living Building Challenge® (LBC)

LIGHTING PARTNERS (CONTINUED)



For compatible lighting details, visit jlc-tech.com

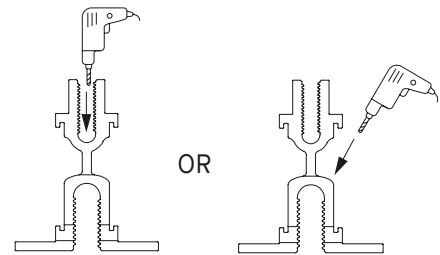
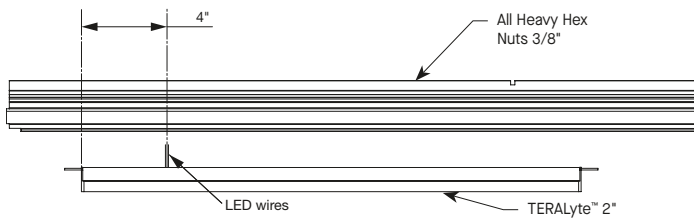
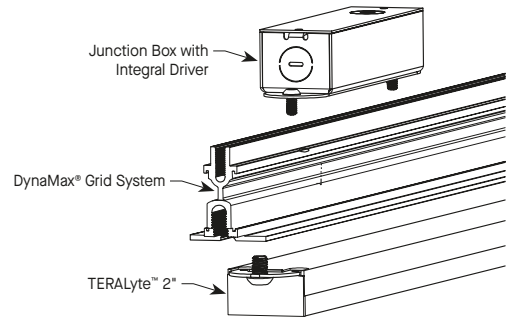

MEP PARTNER



For compatible diffuser details, visit priceindustries.com/diffusers

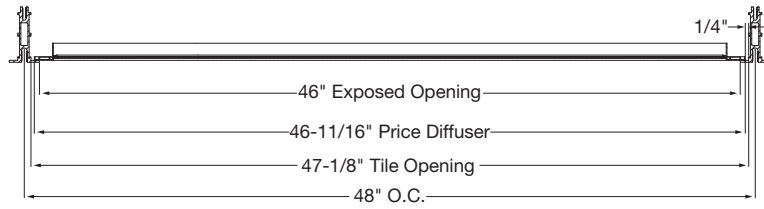
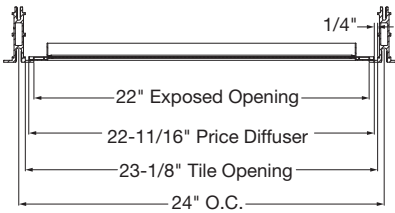

Eggcrate Air Device – Price® Model 80



Perforated Air Device – Price® Model 10

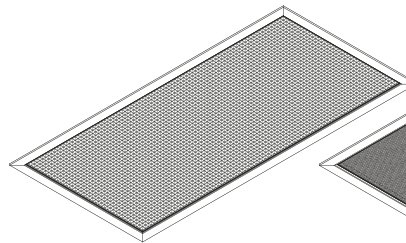

Eggcrate Air Device – Price® Model 80

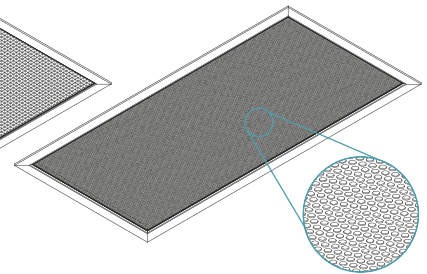

Perforated Air Device – Price® Model 10



DYNAMAX®
Structural Aluminum Suspension System



Declare.

RECYCLED
CONTENT

UP TO
50%

LEED V5

Ecomedes Data

COMMON MATERIALS FRAMEWORK

Human Health	Declare Label	Climate Health	EPD
	HPD	Ecosystem Health	EPD
	3 rd Party CDPH	Circular Economy	✓

Well Building Standard™ (WELL)
Living Building Challenge® (LBC)

TEMPERATURE AND PRESSURE CONTROL ADVANTAGES

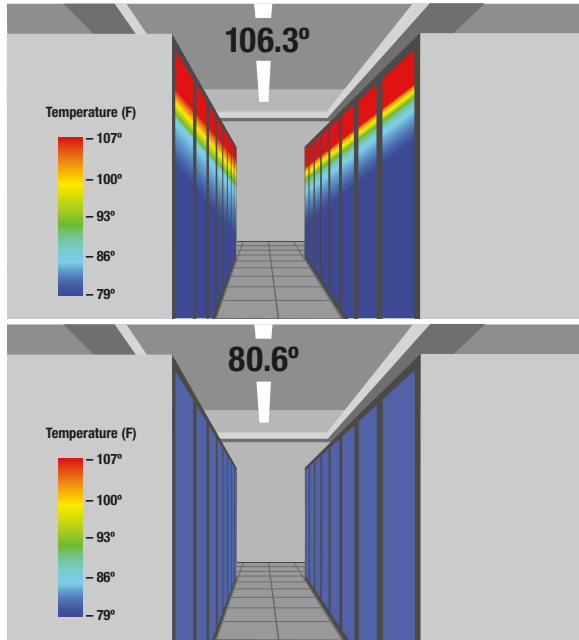

DynaMax structural grid systems provide increased pressure management, reduced leakage, and enables the best hot and cold air containment at the ceiling plane when compared to other ceiling types.

Unlike drilled hole or slotted strut ceilings, the integration of DynaMax grid and Armstrong® Ceiling Panels keeps ceiling planes closed for improved pressure and temperature control where it matters most, such as data center halls.

A 2021 Computational Fluid Dynamics (CFD) simulation showed that, on average, the top of data center cabinet equipment is approx. 26°F warmer when a slotted strut ceiling (top left) is in place and approx. 6°F warmer with drilled hole ceiling (not shown) than with the DynaMax structural grid systems (bottom left).



new Ceiling Panels for DYNAMAX®
Square Lay-in



Declare.

RECYCLED CONTENT

UP TO
87%

LEED V5

Ecomedes Data

COMMON MATERIALS FRAMEWORK

Human Health	Declare Label	Climate Health	EPD
	HPD	Ecosystem Health	EPD
	3rd Party CDPH	Circular Economy	✓
OCCUPANT EXPERIENCE		Acoustics	✓

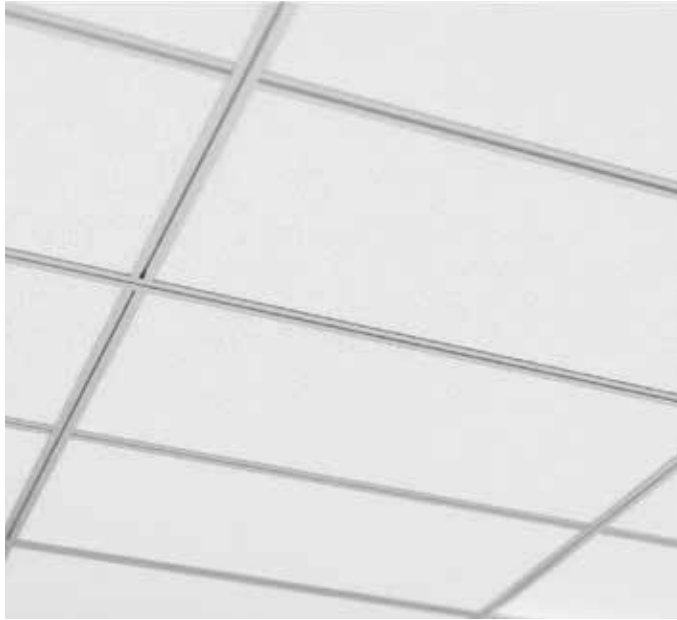

DataZone™ panels with DynaMax® suspension system

Ceiling panels for DynaMax are specifically designed for performance, reliability, and sustainability in data center and critical application environments.

KEY SELECTION ATTRIBUTES

DataZone™ and Ultima® AirAssure® for DynaMax®

- DataZone and Ultima AirAssure panels are part of the Sustain® portfolio, and meet the most stringent industry sustainability compliance standards today
- Get total noise control and floor plan versatility with Total Acoustics® ceiling panels: NRC + CAC = Total Acoustics performance
- Smooth, clean, durable finish
- Mold- and mildew-resistant surface
- 30-Year Limited System Warranty against visible sag, mold, and mildew
- Made in the U.S.A. of domestic and global content
- Build America, Buy America (BABA) Act compliant

Ultima® AirAssure® for DynaMax®

- Factory gasketed Ultima® AirAssure® panels for DynaMax®, DynaMax® LT, and DynaMax® Plus grid reduces air leakage and contributes to annual energy savings

MetalWorks™ for DynaMax®

- CleanAssure™ family of products – includes disinfectable panels, suspension systems, and trim
- Perforated panel option available to enhance acoustical performance and design aesthetics
- Outstanding NRC with acoustical fleece or infill panel (0.70 – 0.85)
- Provides additional options when bidding data centers and structural applications
- Factory-fit ceiling panels eliminate the need to field modify panels in all standard suspension layouts

Ceiling panels are specially sized and engineered for the DynaMax® suspension systems and must be used with these systems. These panels do not fit in other suspension systems.

COLORS Due to printing limitations, shade may vary from actual product.

Painted

DataZone™ for DynaMax®



White (WH) Black (BK)

Ultima® AirAssure® for DynaMax®

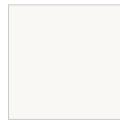

White (WH)

MetalWorks™ for DynaMax®



Whitelume (WHA) Custom Colors Available*

PERFORATION OPTIONS

(1:2 scale shown)

MetalWorks only

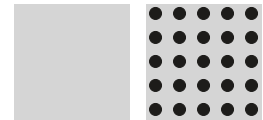

M1 (Unperforated) M19

For custom options contact ASQuote, ASQuote@armstrongceilings.com

* MetalWorks color options

DETAILS

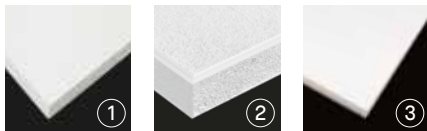

1. DataZone™ for DynaMax®
2. Ultima® AirAssure® for DynaMax®
3. MetalWorks™ for DynaMax®



new Ceiling Panels for DYNAMAX®
Square Lay-in



RECYCLED CONTENT

LEED V5

Ecomedes Data

UP TO
87%

COMMON MATERIALS FRAMEWORK

Human Health	Declare Label	Climate Health	EPD
	HPD	Ecosystem Health	EPD
	3rd Party CDPH	Circular Economy	✓
OCCUPANT EXPERIENCE		Acoustics	✓

Declare.

VISUAL SELECTION

Edge Profile	Item No.	Dimensions (Inches)
DataZone™ for DYNAMAX®	new 1508	23-1/4 × 23-1/4 × 3/4"
Square Lay-in 	new 1508BK	23-1/4 × 23-1/4 × 3/4"
	new 1509	23-1/4 × 47-1/4 × 3/4"
	new 1509BK	23-1/4 × 47-1/4 × 3/4"
	new 1566	23-1/4 × 23-1/4 × 3/4"
	new 1566BK	23-1/4 × 23-1/4 × 3/4"
	new 1567	23-1/4 × 47-1/4 × 3/4"
	new 1567BK	23-1/4 × 47-1/4 × 3/4"
	new 1568	47-1/4 × 47-1/4 × 1"
ULTIMA® AirAssure® for DYNAMAX	1599	23-1/4 × 23-1/4 × 3/4"
Square Lay-in 	1638	23-1/4 × 47-1/4 × 3/4"
METALWORKS™ for DYNAMAX® Square Lay-in M1 (Unperforated) M19	6345W24L48M1WHA	23" × 47"
	6345W48L48M1WHA	47" × 47"
	6345W24L48M19WHA	23" × 47"
	6345W48L48M19WHA	47" × 47"

PERFORMANCE Dots represent high level of performance.

Sound Absorption	Sound Blocking	Total Acoustics ¹	Fire Performance	Light Reflect*	Bio-Block	Humi-Guard+	Certified Low VOC Emissions	Durability	Recycled Content	Recycle Program	30-Yr Warranty
0.75	35	BETTER	Class A	0.82	*	*	*	Std	*	*	*
0.75	35	BETTER	Class A	N/A	*	*	*	Std	*	*	*
0.75	35	BETTER	Class A	0.82	*	*	*	Std	*	*	*
0.75	35	BETTER	Class A	N/A	*	*	*	Std	*	*	*
0.90	N/A	N/A	Class A	0.82	*	*	*	Std	*	*	*
0.90	N/A	N/A	Class A	N/A	*	*	*	Std	*	*	*
0.90	N/A	N/A	Class A	0.82	*	*	*	Std	*	*	*
0.90	N/A	N/A	Class A	N/A	*	*	*	Std	*	*	*
0.90	N/A	N/A	Class A	0.82	*	*	*	Std	*	*	*
0.75	35	BETTER	Class A	0.88	*	*	*	*	*	*	*
0.75	35	BETTER	Class A	0.88	*	*	*	*	*	*	*
N/A	N/A	N/A	Class A	0.75	*	N/A	*	*	*	N/A	N/A
N/A	N/A	N/A	Class A	0.75	*	N/A	*	*	*	N/A	N/A
See chart below for acoustical information.			Class A	0.75	*	N/A	*	*	*	N/A	N/A
			Class A	0.75	*	N/A	*	*	*	N/A	N/A

Ceiling panels are specially sized and engineered for DynaMax suspension systems and must be used with the systems. These panels do not fit in other suspension systems.

* Advertised values for light reflectance are applicable to white tiles only.

¹ Total Acoustics® ceiling panels have an ideal combination of sound absorption and sound blocking in one product.

GOOD (NRC 0.60-0.65; CAC 35+) **BETTER** (NRC 0.70-0.75; CAC 35+) **BEST** (NRC 0.80+; CAC 35+)

ACCESSORIES FOR METALWORKS LAY-IN CEILING PANELS

6483 – MetalWorks Lay-in Perimeter Hold-down Clip for DynaMax – Screw attaches to perimeter molding to hold the perimeter cut metalworks panels in place. Two clips required per cut panel.

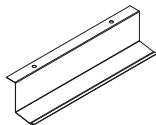

6483 – 10 PCS

8200T10 – 1" Fiberglass Infill Bag – 24 × 24 × 1" Color – Black (gloss)

8200T10 – 12 PCS

METALWORKS ACOUSTICAL INFORMATION

	Item No.	NRC with Acoustical Fleece	NRC with 1" Fiberglass Infill
	6345W24L48M19WHA	0.70	0.85
	6345W48L48M19WHA	0.70	0.85



DYNAMAX®

Structural Aluminum Suspension System



RECYCLED
CONTENT

LEED V5

Ecomedes Data

UP TO
50%

COMMON MATERIALS FRAMEWORK

Human Health **Declare Label**
HPD
3rd Party CDPH

Climate Health **EPD**
Ecosystem Health **EPD**
Circular Economy **✓**

Well Building Standard™ (WELL)
Living Building Challenge® (LBC)



DynaMax® with MetalWorks™ Lay-in Panels in Whitelume

PHYSICAL DATA FOR DYNAMAX® SUSPENSION SYSTEMS

Material Aluminum	Face Dimension 2"	End Detail Main Beam: Butt cut Cross Tee: Override
Surface Finish Baked polyester paint or powder-coated	Profile Exposed tee	Duty Classification Heavy-duty
Manufactured and tested in accordance with ASTM C635 and E3090	Cross Tee/Main Beam Interface Override	System Weight 2' x 2' – 1.25 LBS/SF 2' x 4' – 0.94 LBS/SF

PHYSICAL DATA FOR METALWORKS LAY-IN CEILING PANELS

Design Considerations
MetalWorks panels and DynaMax and DynaMax Plus grid are manufactured at separate facilities that use different paint systems. Colors i.e. White and Whitelume will coordinate but are not exact color matches.

Material
All MetalWorks panels: Aluminum – 0.064"

Warranty
One (1) year limited warranty for MetalWorks items.
Details at armstrongceilings.com/warranty

PHYSICAL DATA FOR DATAZONE™ AND ULTIMA® AIRASSURE® CEILING PANELS

Material
Wet-formed mineral fiber with DuraBrite® acoustically transparent membrane and polyethylene foam (Items 1599 and 1638)
Wet-formed mineral fiber with acoustically transparent membrane (Items 1508, 1508BK, 1509, and 1509BK)
Fiberglass with DuraBrite® acoustically transparent membrane (Items 1566, 1566BK, 1567, 1567BK, and 1568)

Surface Finish
Acoustically transparent membrane with factory-applied latex paint
DuraBrite scrim with factory-applied latex paint (Items 1599, 1638, 1566, 1566BK, 1567, 1567BK, and 1568)

Fire Performance
Class A: ASTM E84 and CAN/ULC S102 surface burning characteristics. Flame Spread Index of 25 or less. Smoke Developed Index of 50 or less (UL® labeled).

ASTM E1264 Classification
Type A, Form A2.2, Pattern E; Fire Class A (Items 1599 and 1638)
Type A, Form A2.2, Pattern G; Fire Class A (Items 1508, 1508BK, 1509, and 1509BK)
Type B, Form B2, Pattern G; Fire Class A (Items 1566, 1566BK, 1567, 1567BK, and 1568)

Humidity/Sag Resistance
HumiGuard® Plus ceiling panels are recommended for areas subject to high humidity, up to, but not including, standing water and outdoor applications.

Anti-Mold/Mildew
Ceiling tiles with BioBlock® performance resist the growth of mold and mildew on the tile surface.

VOC Emissions
Third-party certified compliant with California Department of Public Health CDPH/EHLB/Standard Method Version 1.2, 2017. This standard is the guideline for low emissions in LEED®, WELL Building Standard®, Living Building Challenge® (LBC), CalGreen Title 24, ANSI/ASHRAE/USGBC/IES Standard 189; ANSI/GBI Green Building Assessment Protocol.

High Recycled Content
Contains greater than 50% total recycled content. Total recycled content based on product composition of post-consumer and pre-consumer (post-industrial) recycled content per FTC.

Insulation Value
1508, 1508BK, 1509, 1509BK, 1599, and 1638:
R Factor – 2.2 (BTU units); R Factor – 0.39 (Watts units)
1566, 1566BK, 1567, 1567BK, and 1568:
R Factor – 4.0 (BTU units); R Factor – 0.7 (Watts units)

30-Year Performance Guarantee & Warranty
When installed with Armstrong® Suspension System.
Details at armstrongceilings.com/warranty

Weight; Square Feet/Carton
1508, 1508BK, 1509, 1509BK – 1.08 LBS/SF; 48 SF/CTN
1566 – 0.44 LBS/SF; 120 SF/CTN
1566BK – 0.44 LBS/SF; 60 SF/CTN
1567, 1567BK – 0.44 LBS/SF; 122 SF/CTN
1568 – 0.44 LBS/SF; 0.44 LBS/SF; 93 SF/CTN
1599 – 1.08 LBS/SF; 12 PCS/CTN; 44 SF/CTN
1638 – 1.08 LBS/SF; 6 PCS/CTN; 44 SF/CTN

Minimum Order Quantity
1 carton

LEED® is a registered trademark of the U.S. Green Building Council; Declare® and Living Building Challenge® (LBC) are registered trademarks of the International Living Future Institute®; WELL™ and Well Building Standard™ are trademarks of the International WELL Building Institute; Axis logo and TRAYFIT™ are trademarks of Axis Lighting Inc; H.E Williams logo is a registered trademark of H.E. Williams, Inc.; JLC-Tech logo and TERALyte™ are trademarks of JLC-Tech, LLC.; Price® is a registered trademark of Price Industries; UL is a registered trademark of UL, LLC; Vode® and ZipTwo® are registered trademarks of Vode Lighting LLC; all other trademarks used herein are the property of AWI Licensing LLC and/or its affiliates © 2026 AWI Licensing LLC

TechLine / 877 276-7876
armstrongceilings.com/datacenter
BPCS-6273-326

Armstrong®
World Industries

SUSPENSION SYSTEMS – DATA CENTERS

