

Project Name: _____ Type: _____ Quantity: _____

INTENDED USE

The Alcon Lighting Bolzano II Architectural LED Directional Up Light Fixture features naturally etched finishes capable of withstanding the test of time. The Bolzano II Directional Uplights are ideal for architectural landscape lighting applications.

FEATURES

L 5" x Dia 3.875"

Construction: 316 Grade Stainless Steel

Finish: Stainless Steel

Lens: Clear and heat resistant convex glass

Wiring: Prewired with a 3' 18-2 SPT2-W direct burial cord

Socket: Top grade ceramic bi-pin with retention clip

Gasket: Silicone "O" ring seals face plate to housing providing weather tight protection

Yoke: Stainless steel yoke with 1/2" NPT bushing for mounting spike

Mounting: 8" Stainless Steel spike 1/2" NPT threaded female hub (1/2" NPT Spike included)

Voltage: 12V

Wattage: 5W

Color Temperature: 27/30/40/50K

Lumens: 500 lm

CRI: 80+

Life: 50,000 Hrs

Warranty: 5 years Carefree for parts & components (Labor not included)

Listings: cETLus Listed, Wet Location

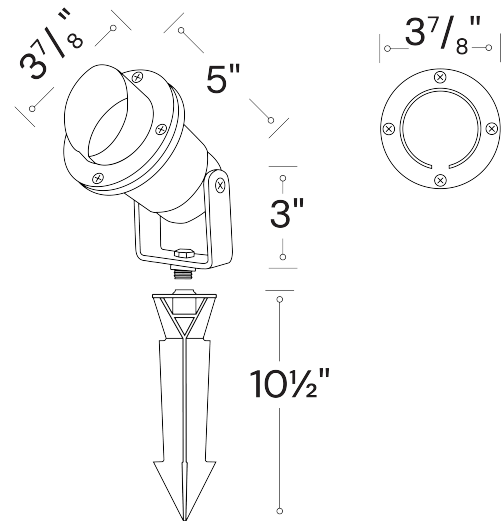

ORDERING INFORMATION Example:

| Model | Color Temp | | Mounting | |
|--------|------------|-------|----------|--------------------------------------|
| 9014-2 | 27K | 2700K | (Blank) | 1/2" NPT Spike Included |
| | 30K | 3000K | MC | Mounting Canopy |
| | 40K | 4000K | MS6 | 6" Mounting Stem |
| | 50K | 5000K | MS12 | 12" Mounting Stem |
| | | | MS18 | 18" Mounting Stem |
| | | | MS24 | 24" Mounting Stem |
| | | | MP | 18" Mounting Pedestal (Black Finish) |

COLOR TEMPERATURE GUIDE

