

## INSTALLATION INSTRUCTIONS FOR: 2.5-Inch Trimless Shallow Recessed LED Light

INSTALLATION TYPE: NON-IC HOUSING for NEW CONSTRUCTION APPLICATIONS

**WARNING:**



RISK OF FIRE AND ELECTRICAL SHOCK. FIXTURE MUST BE INSTALLED BY A QUALIFIED ELECTRICIAN ONLY IN ACCORDANCE WITH NATIONAL, LOCAL BUILDING AND ELECTRICAL CODES. DISCONNECT POWER AT ELECTRICAL PANEL BEFORE SERVICING.

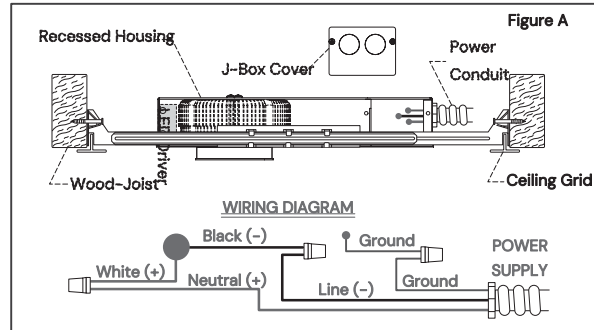

**Important:** Install and operate this luminaire in accordance with local electrical codes and regulations.

**PREPARATION:**

1. Read all instructions thoroughly before beginning installation. If you are unfamiliar with electrical wiring, hire a qualified, licensed electrician to perform the installation.

**CAUTION:**

- Maintain a minimum clearance of 3" between ceiling insulation and the sides of the housing. Do not place insulation on top of the housing.
- Maintain at least 1/2" clearance from any combustible materials such as wood joists, subflooring, or roofing.

**A) INSTALL RECESSED FRAME:**

- Mount the recessed frame to the ceiling grid or wood joists using the provided hanger bars. Adjust the hanger bars as needed to ensure the frame opening is in the desired location. (See FIG. A)

**B) ELECTRICAL CONNECTIONS:**

1. **WARNING:** Disconnect power at the circuit breaker or fuse panel before starting. Turning off the light switch alone is not sufficient to prevent electrical shock.
2. This luminaire must be connected with supply wires rated at 90°C or higher. If your home was built before 1985, consult a qualified electrician to confirm wire rating compatibility.
3. Connect the power supply to the luminaire's junction box. Use wire connectors (not included) suitable for the size and type of wires. Refer to the wiring diagram. (See FIG. A)
4. After completing all connections, neatly place the wires inside the junction box and securely replace the cover plate.

**C) CEILING CUTOUT:**

1. Install ceiling material, then mark and cut the opening. The required cutout is 3.25" in diameter or square, depending on your model. (See FIG. B)

**D) INSTALL LUMINAIRE TRIM:**

1. Compress the mounting clips on the trim and insert the fixture fully into the opening until the clips lock securely in place within the housing. (See FIG. C)

**E) FINAL INSTALLATION:**

1. Confirm all components are securely installed and connected. (See FIG. D)

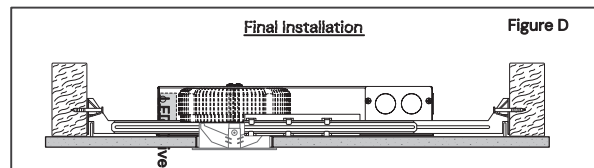
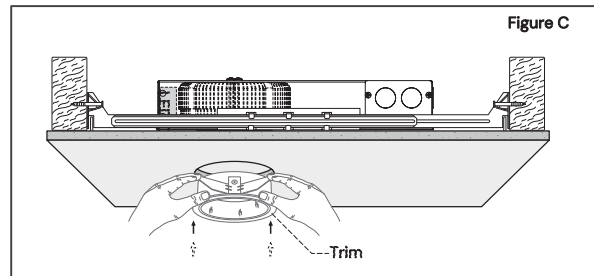
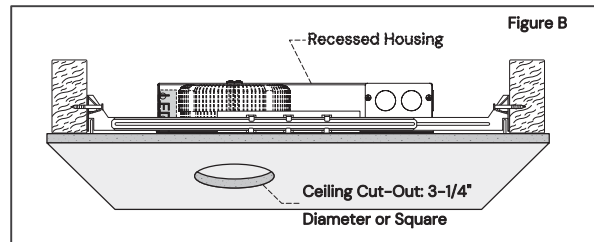

**SERVICE AFTER INSTALLATION "REPLACING LED DRIVER"**

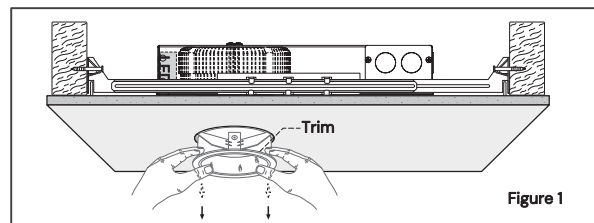

1). Remove the Luminaire Trim.

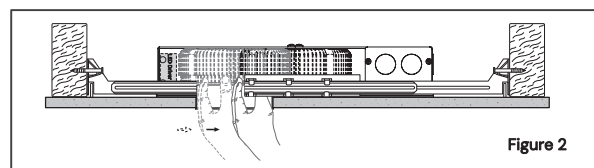

2). Push LED Module to the side to access the Driver.

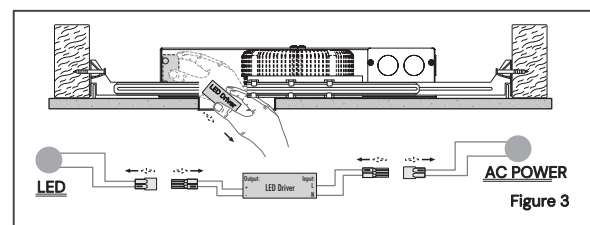

3). Disconnect the Driver from Input and Output Quick Connectors (provided).

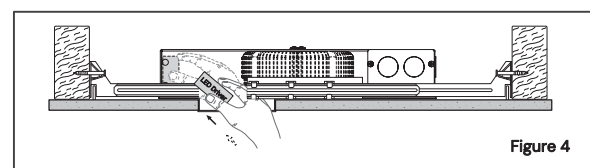

- a\_ Place Driver to the same location and make sure its width is Vertically Installed.
- b\_ Pull back LED Module to the center of opening and reinstall the Trim (see Fig. C).