

13000 SERIES – INSTALLATION INSTRUCTIONS

QUALIFIED INSTALLATION REQUIRED

This system must be installed by a licensed professional in accordance with the latest edition of the National Electrical Code (NEC) and all applicable local and state building codes. Final installation must be approved by a qualified electrical or building inspector. Improper installation may create fire or shock hazards. Disconnect power at the source before beginning installation.

SAFETY GUIDELINES

- Read all instructions carefully before starting.
- Disconnect all power before modifying or extending the track system.
- One-circuit track systems support a maximum of 20 amps (2400 watts) when permanently connected to an outlet box. Only approved track lighting fixtures may be installed.
- Do not plug tools, appliances, or extension cords into the track.
- Maintain at least 6 inches of clearance from combustible materials (e.g., curtains, wall coverings).
- Not rated for wet or damp locations.
- Install the track system at a minimum height of 5 feet above the floor.
- Do not connect the system to multiple branch circuits unless specifically designed for that purpose—consult a qualified electrician to avoid overloading the neutral, which can pose a serious fire risk.

Electrical Power Connection

- Secure flexible conduit or EMT to the knockout provided in the 13000-RH-EF or compatible housing.
- Pull power leads through the conduit and connect them to the terminal screws inside the end feeds (13000-TC-1-LE or 13000-TC-2-LE).
- All electrical connections must comply with local building and electrical codes.

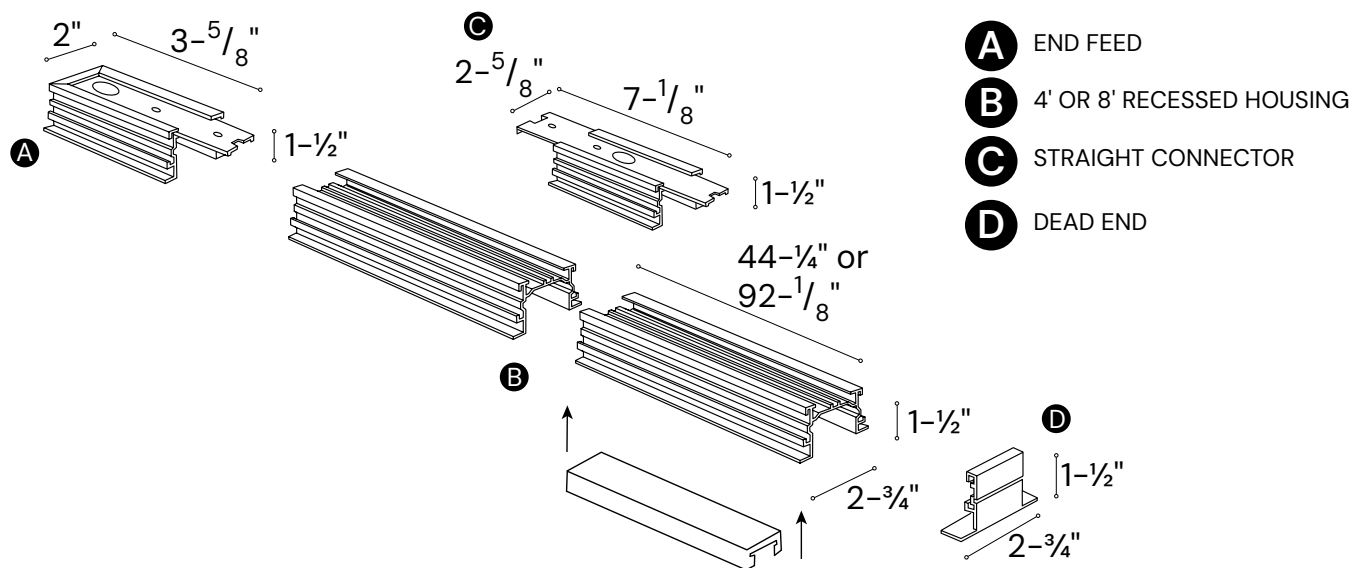

13000 SERIES – INSTALLATION INSTRUCTIONS

Installation of Recessed Track Housing

1. Cut the recessed housing (13000-RH-4 / 13000-RH-8) to the desired length. Ensure a clean, square cut for proper fit.
2. Insert the 1-1/2" mounting tabs horizontally into the internal channel at either end of the housing. Use two tabs per 4' section.
3. To join multiple housing sections, insert two 3" connecting tabs into the slots at each end. Slide half of each tab into the first housing and tighten the set screws. Then slide the second housing over the exposed tabs and secure with additional set screws.
4. Finish each run with a dead-end cap (13000-RH-DE). Insert the short ends of the two 1-3/8" brackets into the cap, then slide the longer ends into the open housing and tighten the set screws.
5. Cut a 2" wide ceiling opening to match the desired housing length.
6. Install the housing using either the supplied mounting tabs or by fastening directly to wood furring. Use 4 tabs for 4' sections and 6 for 8' sections.
7. To install mounting tabs, bend each 90° and insert into the housing channels. Attach tabs to a solid ceiling structure. For wood furring, drill through the top of the housing and secure with #10 wood screws.
 - For T-bar ceilings, suspend the housing from the structural ceiling using the tabs, ensuring the housing bottom aligns with the T-bar surface.

Note: Housing flanges must rest on top of the ceiling surface.

Installation of Track System

1. Insert the live end feed (13000-LE-1 or 13000-LE-2) into the corresponding single- or dual-circuit track (13000-TC-1 or 13000-TC-2 series). Remove the cover to access internal wiring.
2. Use the mounting holes—or drill them if needed—to secure the track to the 1-1/2" mounting tabs located along the housing's side channels.
3. To extend the run, connect additional track sections using the appropriate connectors (13000-MC-1 or 13000-MC-2). For straight runs requiring an additional feed, use the "I" connector (13000-SC-1 or 13000-SC-2) with the 13000-RH-LC connector housing.
4. Install a track end cap at the end of each continuous run.
5. Replace all covers on end feeds and connectors after wiring is complete.

L Connector

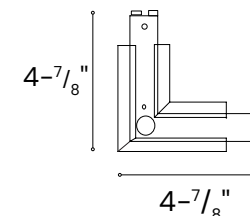
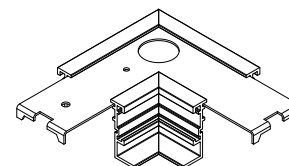

T Connector

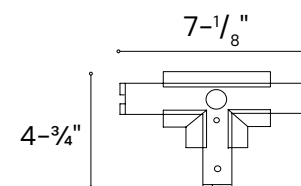
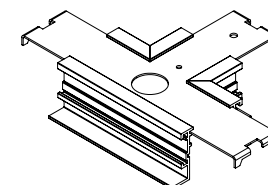

X Connector

