

Project Name:

Type:

Quantity:

## FIXTURE SPECIFICATIONS

### INTENDED USE

Finished in an antimicrobial white coat of paint with a frosted, acrylic glass lens, the pendant, wall or surface-mounted light fixture fits healthcare lighting applications. This includes examination rooms, spaces and areas designated for doctor, medical and hospital purposes. Our linear lighting product, assembled in America, includes hardware for mounting to a standard electrical junction box.

### FEATURES

**Voltage:** 120-277V, 50/60 Hz

**Mounting:** Hardware included for mounting to standard electrical junction box

**Finish:** White antimicrobial finish

**Lens:** Frosted acrylic glass

**Ambient Operating Temperature:** 22°F (-30°C) ~ 122°F (50°C)

**Life:** 60,000 Hours

**Warranty:** 5 years carefree for parts & components

(Labor not included)

**Listing:** UL listed, Assembled in the USA, ARRA compliant, Wet Location, EM5 & EM8 options are CEC compliant

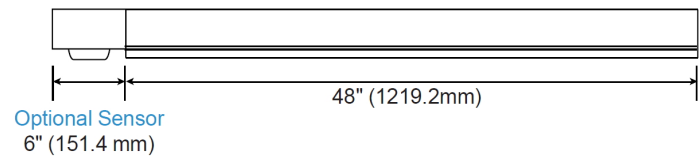
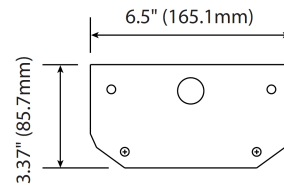

## ORDERING INFORMATION Example: (12527-S-36L-30K-010)

Model	Mounting	Wattage   Lumen	Color Temp	CRI	Dimming	Warranty	Options
<b>12517</b>	<b>S</b> Surface	<b>36L</b> 36 Watts   3985 lms	<b>27K<sup>1</sup></b> 2700K	<b>80</b> 80+ CRI	<b>010</b> 0-10V 10%-100%	<b>Blank</b> <small>Standard</small> 5 Year Warranty	<b>EM5</b> 5W EM Battery Backup
	<b>W</b> Wall	<b>40L</b> 40 Watts   4428 lms	<b>30K</b> 3000K	<b>90</b> 90+ CRI	<b>BLS</b> Bi-Level Step Dimming 50%/100%	<b>W7</b> 7 Year Warranty	<b>EM7</b> 7W EM Battery Backup
	<b>P</b> Pendant	<b>54L</b> 54 Watts   5977 lms	<b>35K</b> 3500K		<b>BLSXX</b> Bi-Level Step Dimming Replace X with Percentage from 10%-90%	<b>W10</b> 10 Year Warranty	<b>PO</b> Power Outlet with Ground
		<b>72L</b> 72 Watts   7969 lms	<b>40K</b> 4000K		<b>TLS</b> Tri-Level Step Dimming 30%/70%/100%		<b>MS</b> Motion Sensor
			<b>50K</b> 5000K		<b>TLSXX</b> Tri-Level Step Dimming Replace X and X with Percentages from 10%-90%		

<sup>1</sup>Available in 90 CRI only