

12182-5 INSTALLATION INSTRUCTIONS

! CAUTION

Install and use this luminaire in accordance with your local electrical codes and regulations.

- Read all instructions carefully before installation.
- Do not install any luminaire assembly within 6 inches of curtains or other combustible materials.

PREPARATION

1. Read and fully understand all instructions before beginning installation.
2. If you are not familiar with electrical wiring, hire a qualified, licensed electrician to install this luminaire.

ELECTRICAL CONNECTIONS

1. **WARNING:** Before making any wire connections, disconnect power by switching off the circuit breaker or removing the fuse at the fuse panel.

Note: Turning off the light switch alone does not prevent electrical shock.

2. This luminaire requires supply wire rated at 90°C (194°F).
 - Many dwellings built before 1985 may only have 60°C (140°F) supply wire.
 - If unsure, consult a qualified electrician before installation.

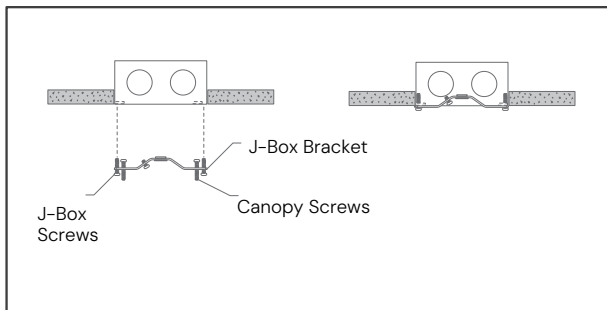

1 Install J-Box bracket

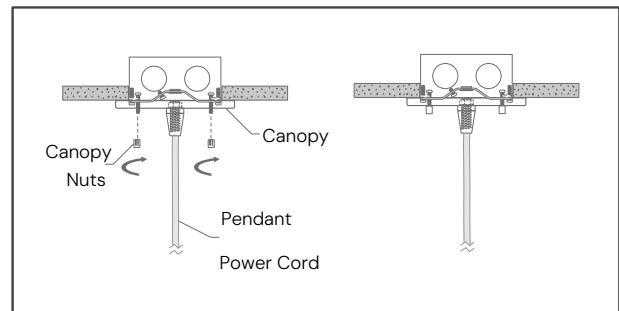

3 Install ceiling canopy

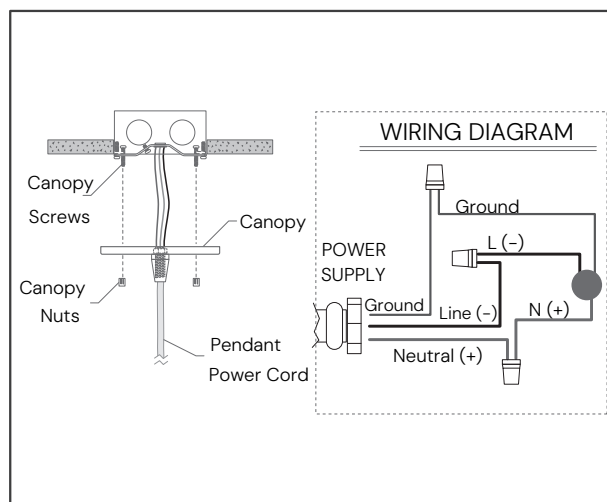

2 Make wire connections

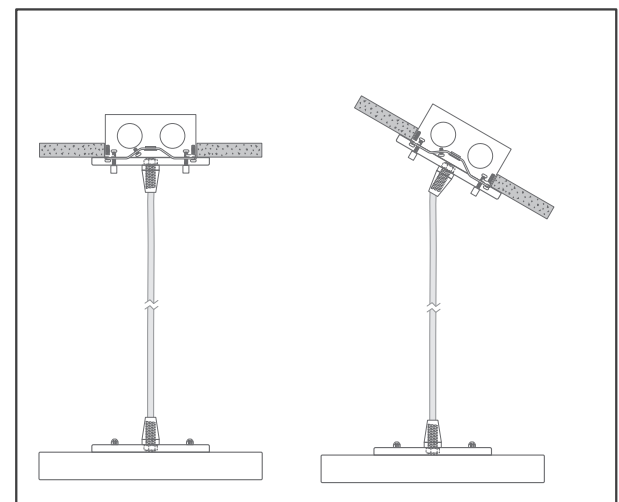

4 Final installation