

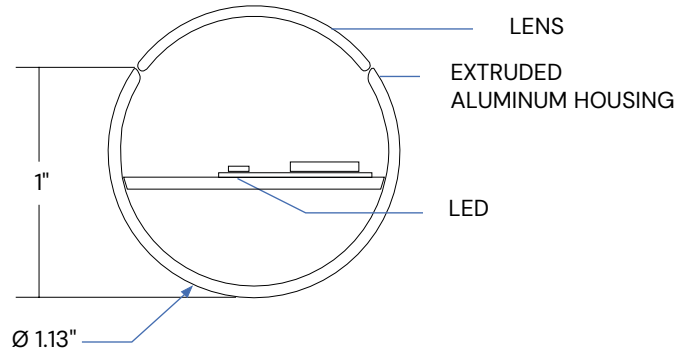

IMPROPER INSTALLATION MAY RESULT IN ELECTRIC SHOCK OR FIRE HAZARD. INSTALLATION MUST BE PERFORMED BY A QUALIFIED ELECTRICIAN IN ACCORDANCE WITH ALL APPLICABLE ELECTRICAL CODES. DISCONNECT POWER AT THE CIRCUIT BREAKER BEFORE BEGINNING.

### PRE-INSTALLATION

1. Do not look directly into the light source during installation or operation.
2. Power input is 24V DC. Confirm that the power supply is compatible before proceeding.
3. Follow all safety guidelines provided with the fixture.



### INSTALLATION STEPS

#### Step 1

Use a pencil to mark the ceiling, indicating the fixture's intended location.

#### Step 2

Cut a 1" diameter hole in the ceiling and pull the main power wires through.

#### Step 3

Insert the aircraft cable into the Griplock gripper by turning it clockwise to release. Adjust to the desired suspension length, then turn counterclockwise to lock the cable in place.

(Figure 1)

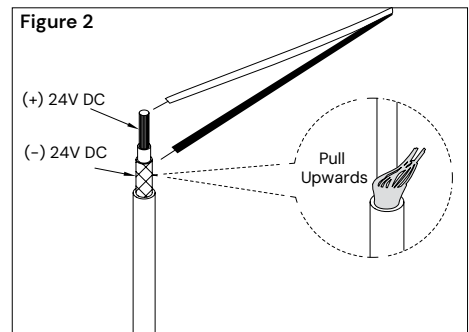
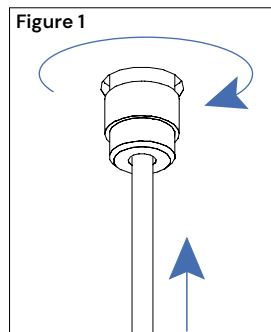

#### Step 4

Connect the power feed to the main power wires.

(Figure 2)

#### Step 5

Secure the canopy mounting bracket to the ceiling using appropriate screws.

(Figure 3)

If needed, repeat Step 3 to fine-tune cable length.

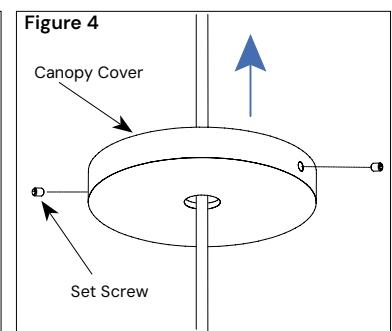
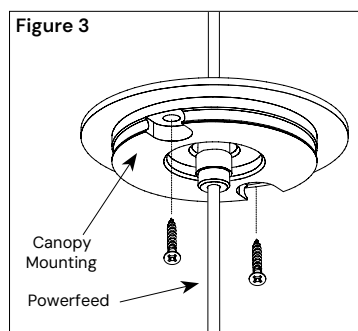

#### Step 6

Slide the cover plate up along the suspension cable and secure it using the side set screws.

(Figure 4)



IMPROPER INSTALLATION MAY RESULT IN ELECTRIC SHOCK OR FIRE HAZARD. INSTALLATION MUST BE PERFORMED BY A QUALIFIED ELECTRICIAN IN ACCORDANCE WITH ALL APPLICABLE ELECTRICAL CODES. DISCONNECT POWER AT THE CIRCUIT BREAKER BEFORE BEGINNING.

### INSTALLATION STEPS

#### Step 7: Joining Multiple Fixtures

If installing multiple luminaires, attach the fixture to your chosen connector and secure with set screws. Repeat for the opposite end. (Figure 5)

**Note:** Fixtures can be linked up to 20 ft using non-powered connectors. A powered connector is recommended every 20 ft. Refer to the spec sheet for approved connector types.

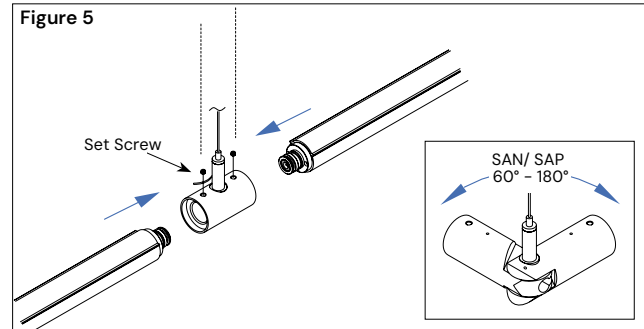

#### Step 8

Attach the end support to the fixture and secure with set screws. (Figure 6)

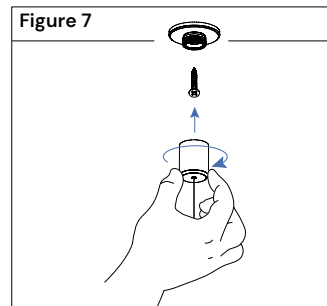
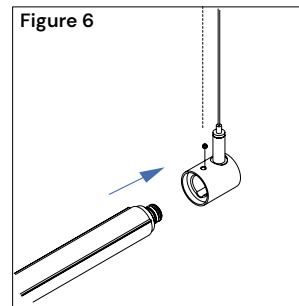

#### Step 9

Install the ceiling cable fitting using appropriate anchor screws. Rotate the cover clockwise to lock the suspension cable in place. (Figure 7)

#### Step 10

To adjust the luminaire height, press the gripper nozzle and slide the cable to the desired length. Trim any excess cable using proper tools. (Figure 8)

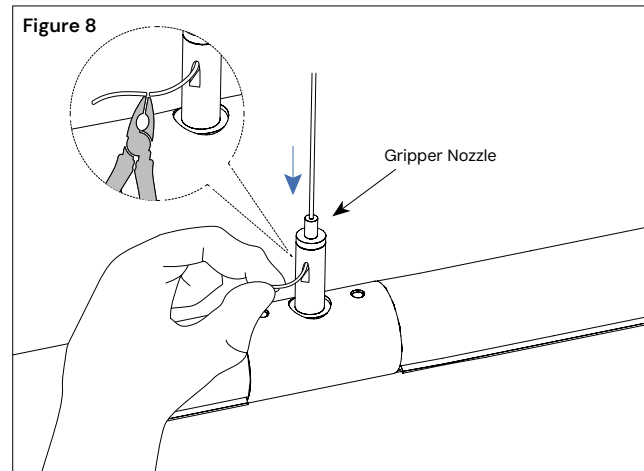

#### Step 11

Restore power and verify luminaire operation.