

12100-41-W INSTALLATION INSTRUCTIONS FOR: Wet-Location Linear Direct and Indirect LED Wall Light

Safety Precautions:

1. This product must be installed, inspected, and maintained by a qualified electrician in compliance with the NEC (National Electric Code) and all applicable local codes.
2. Always turn off electrical power before conducting any inspection, installation, or removal of the fixture.
3. Use only UL or NRTL-approved wiring for all input/output connections to ensure safety and compliance.
4. Ensure that the LEDs and drivers have cooled down before performing any maintenance, and verify that the supply voltage matches the luminaire's rated voltage.
5. Do not install in hazardous environments unless the ambient temperature remains within the fixture's rated operating range.
6. Ensure the fixture remains tightly sealed during operation to maintain optimal performance and safety.

Prepare Electrical Wiring:

Electrical Requirements:

- Ensure that the local voltage matches the fixture's working voltage range.
- Use a minimum 75°C-rated supply wire for safe operation.

Grounding Instructions:

- Ground and bond the entire system according to NEC Article 600 and local electrical codes to ensure safety and compliance.

Safety Precautions:

- Adhere to all applicable safety procedures throughout installation, operation, and maintenance.
- Wear appropriate Personal Protective Equipment (PPE), including hard hats, safety glasses, reflective vests, electrical safety gloves, fall protection gear, and safety-toe boots.



Installation Instructions:

WALL MOUNT BRACKET

*Dimensions are in inches (millimeters).

MOUNTING LENGTH INFORMATION

12100-41 Individual Run

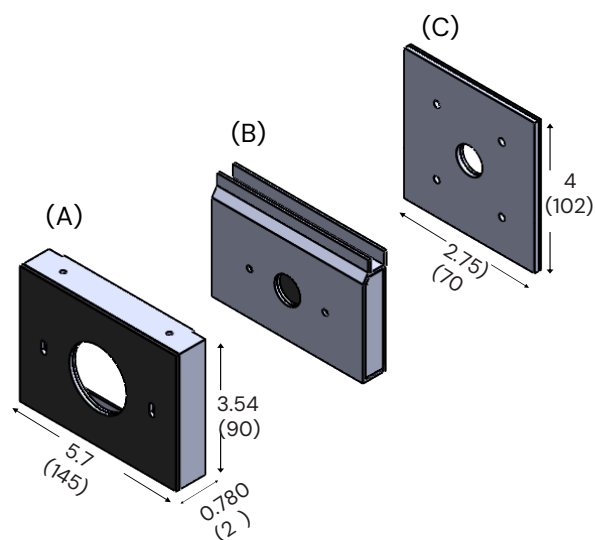

* Gaskets pre-applied.

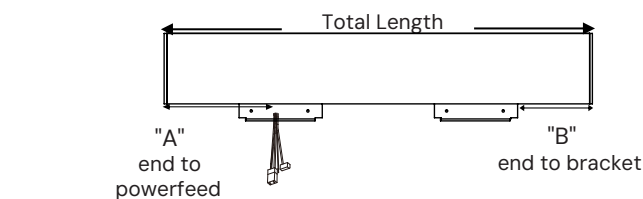

*Standard location otherwise specified.

ITEM	TOTAL LENGTH	"A"	"B"
12100-41 2FT	24-1/8"	6-5/8"	4-1/4"
12100-41 3FT	36-1/8"	10"	7-11/16"
12100-41 4FT	48-1/8"	10"	7-11/16"
12100-41 6FT	72-1/8"	10"	7-11/16"
12100-41 8FT	96-1/8"	10"	7-11/16"

12100-41 Continuous Run

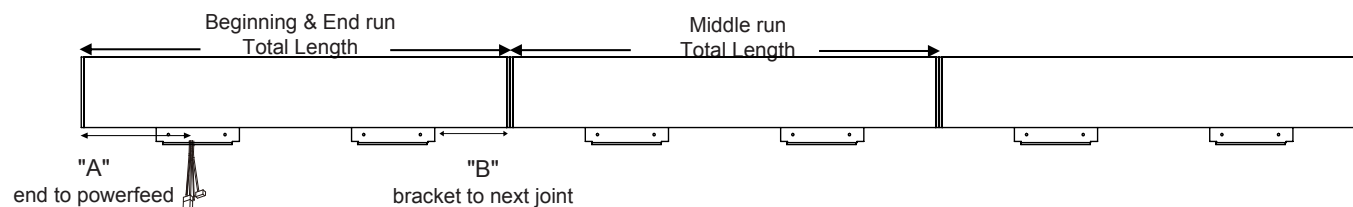

*Standard location otherwise specified.

ITEM	Beg. & End Run Total Length	Middle Run Total Length	"A"	"B"
12100-41 2FT	24-1/16"	24"	6-5/8"	4-3/16"
12100-41 3FT	36-1/16"	36"	10"	7-5/8"
12100-41 4FT	48-1/16"	48"	10"	7-5/8"
12100-41 6FT	72-1/16"	72"	10"	7-5/8"
12100-41 8FT	96-1/16"	96"	10"	7-5/8"



Individual Installation:

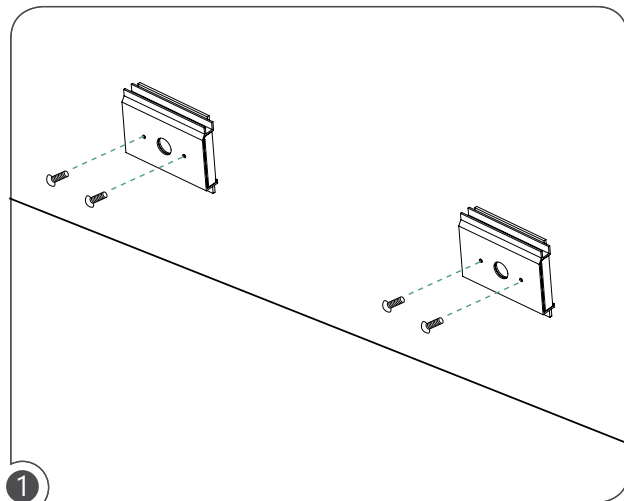

1 Fix and secure the outer wall mount bracket (B+C) on the wall, screws by others.

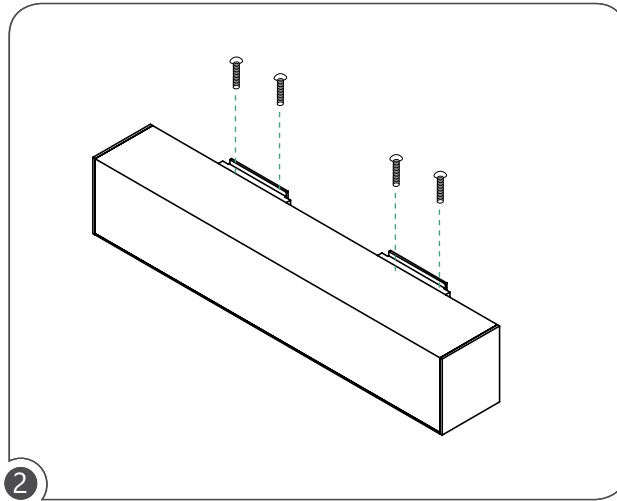

2 Place the fixture and secure against the wall. Make sure to fix inner (A) and outer (B+C) wall mount brackets tightly with screws provided.

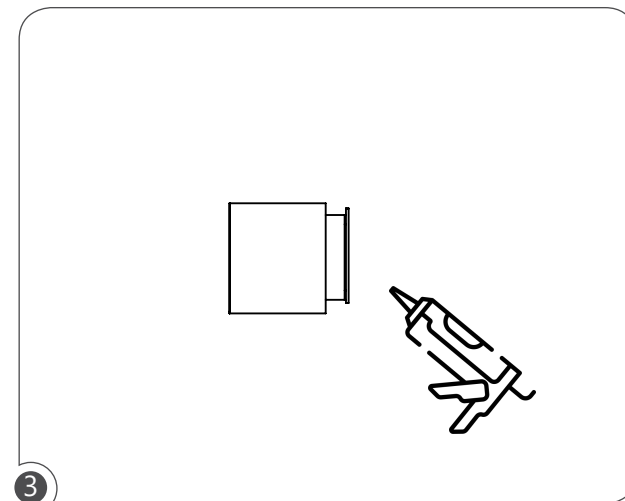

3 Additional waterproof silicone must be applied at the following areas:

- surroundings & edge of fixture and (A)
- surroundings & edge of (C) and wall

** Alcon Lighting will not take any responsibility, If you don't add silicone caulk on mounting surface.(Must apply silicone caulk to be certified under UL.)*



Continuous Run Installation

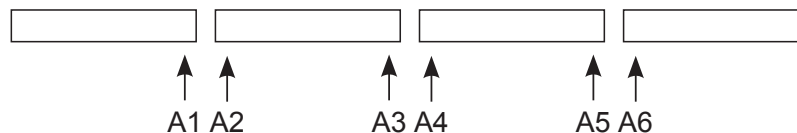

Align continuous row fixtures in numerical order under the same alphabet family.

provided (per joint):



Washer (2pcs)

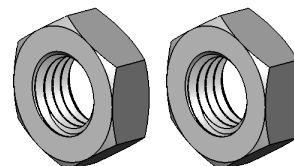

Hexagon locknuts
(2pcs)

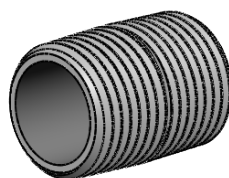

Long bolt (1pc)

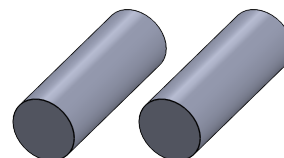

Stopper (2pcs)



Continuous Run Installation

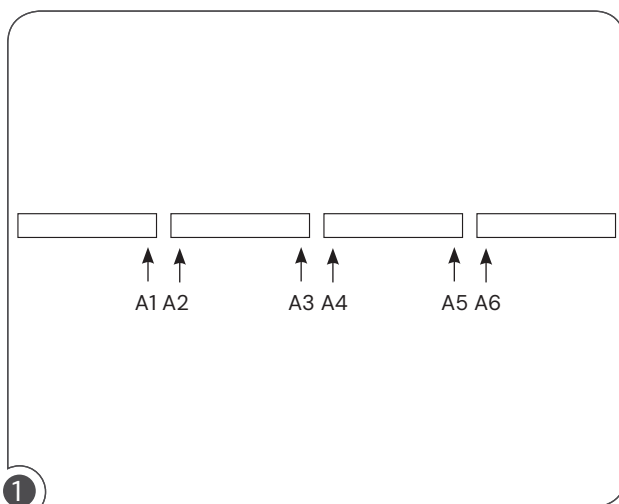

1

Align continuous row fixtures in numerical order under the same alphabet family.

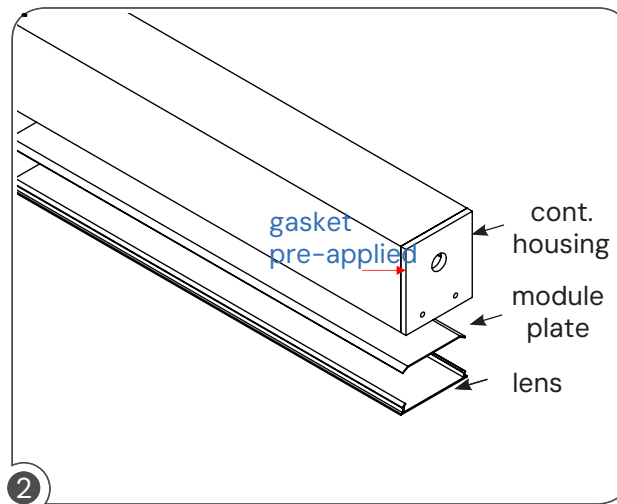

2

Remove module plate and lens from housing.

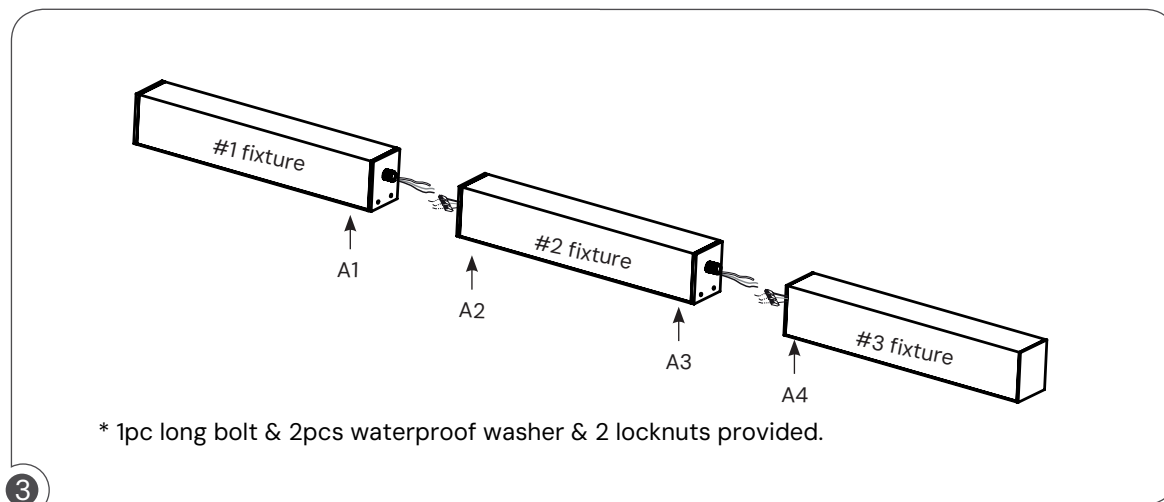

3

After first power-feed fixture has been installed on the ceiling, repeat for each subsequent fixture. Make continuous run wiring connections through the long bolt.



Continuous Run Installation

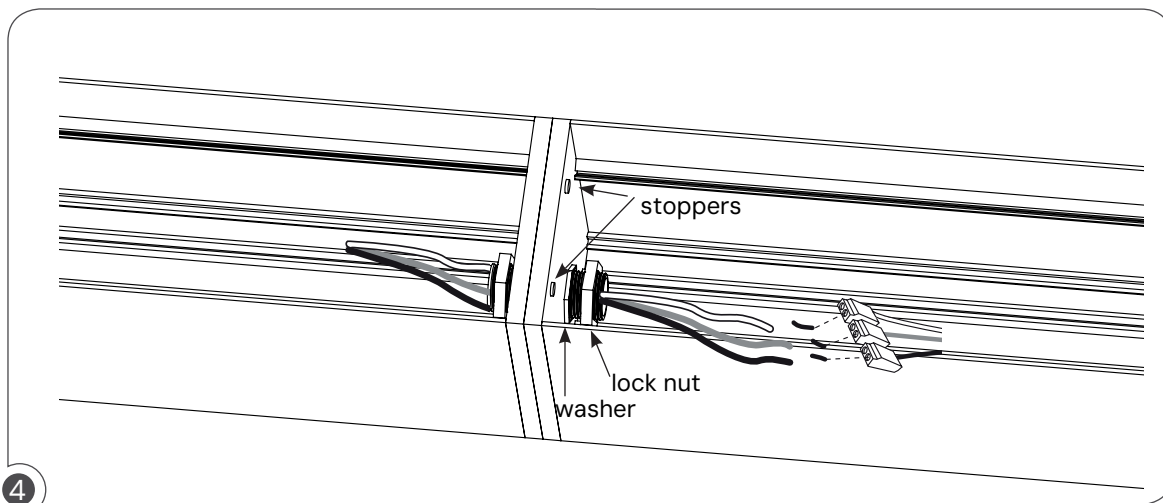

Tighten (2) washers and (2) lock nuts from each side, then insert (2) stoppers. Stoppers must be flushed to the end cap.

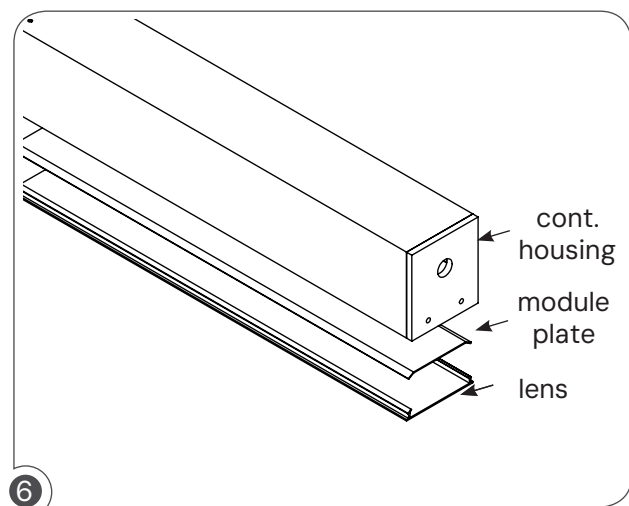

Re-install the module plate and lens to complete the installation.

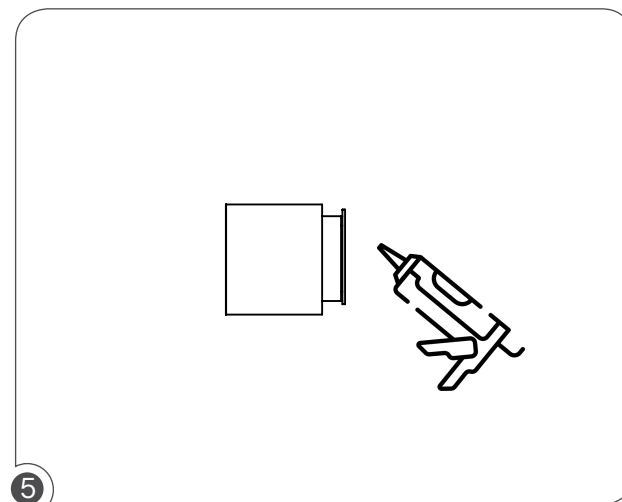

Additional waterproof silicone must be applied at the following areas:

- surroundings & edge of fixture and (A)
- surroundings & edge of (C) and wal

** Alcon Lighting will not take any responsibility, if you don't add silicone caulk on mounting surface. (Must apply silicone caulk to be certified under UL.)*