

WARNING**RISK OF FIRE OR ELECTRIC SHOCK**

The 12100-23 Series must be installed by a qualified electrician in accordance with applicable federal, state, and local laws and codes. Installation requires knowledge of luminaire electrical systems and installer should be familiar with the operation of this product. If not qualified, do not attempt installation; contact a qualified electrician. Manufacturer assumes no responsibility for the improper installation of this luminaire. When installing the fixture, drilling may damage luminaire wiring and electrical parts. Check for wiring and components in enclosure before drilling.

WARNING

To prevent wiring damage or abrasion, do not expose wiring to edges of sheet metal or other sharp objects. When installing this kit, drilling may damage luminaire wiring and electrical parts. Check for wiring and components in enclosure before drilling.

CAUTION**RISK OF PERSONAL INJURY**

- Wear gloves or proper handling protection to prevent cuts or abrasions when handling and maintaining this product. This equipment may have sharp edges. To reduce the risk of death, personal injury or property damage from fire, electric shock, falling parts, cuts/abrasions, and other hazards read all warning and instructions included with and on the fixture box and all fixture labels.
- Avoid direct eye exposure to the light source while it is on.

WARNING**RISK OF PERSONAL INJURY, FIRE OR ELECTRIC SHOCK**

- Turn OFF power before installation.
- Do not handle energized fixture when hands are wet, when standing on wet or damp surfaces, or in water

NOTICE

- Do not install any part of the luminaire less than 5 feet above the floor or closer than 5 inches from any window treatments, i.e., curtains, blinds or any similar combustible type materials.
- Check to make sure that all fixture connections have been properly made and the fixture is grounded to avoid potential electrical shocks.
- Use only UL approved wire input/output connections. Minimum size 18 AWG if there are any continuous runs.
- If the fixtures are connected in a continuous run, do not exceed allowable number of fixtures in series/power in continuous runs.

Wood/Trimless Dry Wall Ceiling Recessed Installation

1

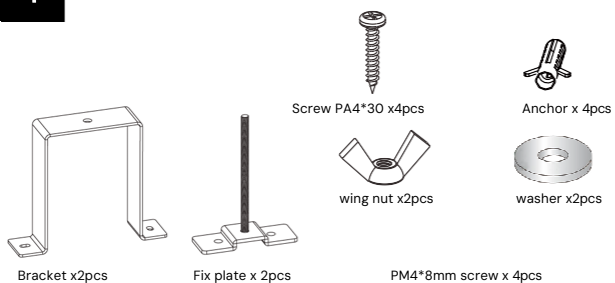

2

Drywall requires thickness > 35mm

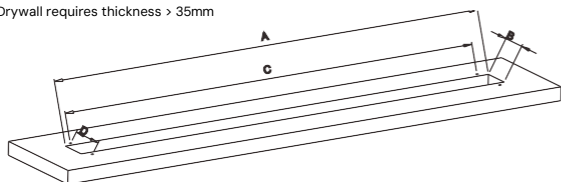

Suggest hole size						
No.	Fixture	Fixture size (MM)	A(MM)	B(MM)	C(MM)	D(MM)
1	2FT	606*70*80	608	72	564	98
2	4FT	1206*70*80	1208	72	1164	98
3	6FT	1806*70*80	1808	72	1764	98
4	8FT	2406*70*80	2408	72	2364	98

Rectangular holes reserved on the ceiling according to the requires (A*B) Drill 4 holes on drywall for the bracket according to the "C" and "D" size

3

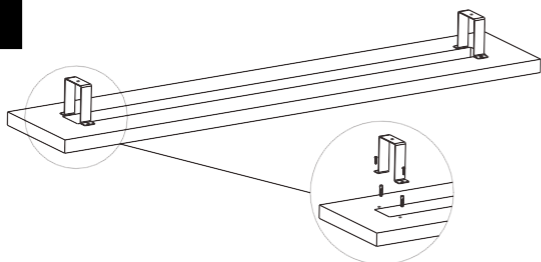

Lockes the brackets on site using the wall anchor and PA4 screws

4

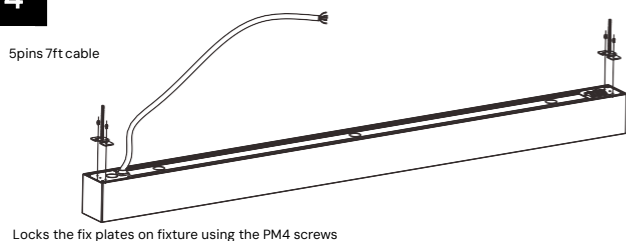

5

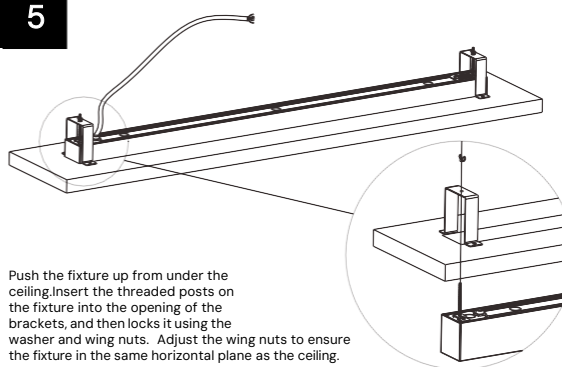

6

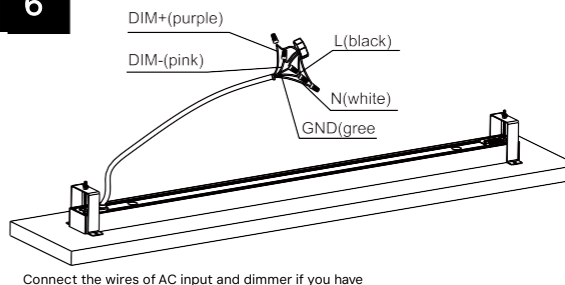

7

