

12100-20-and-12100-40-INSTALLATION INSTRUCTIONS FOR PENDANT STEM

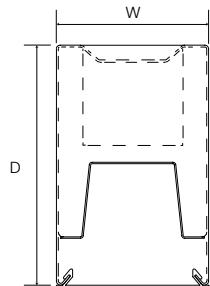

Specifications: 12100-20

Width: 2.5 (64)

Depth: 4 (101)

All dimensions are in inches (millimeters).

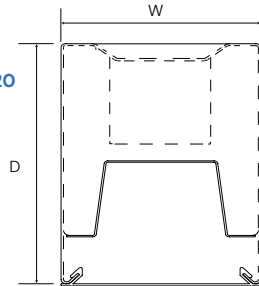

Specifications: 12100-40

Width: 4 (101)

Depth: 4 (101)

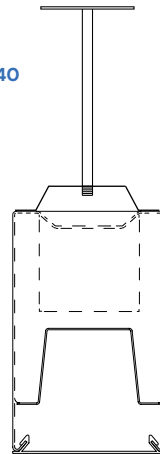

Stem

PART LIST

- | | | |
|------------------|-------------------|--------------------|
| A: Stem | G: Stem bracket | M: Wire connectors |
| B: Threaded stud | H: Bracket screws | N: Screws |
| C: Canopy | I: Wire Nuts | |
| D: J-box bracket | J: Trim ring | |
| E: Screws | K: Power cable | |
| F: J-box | L: Bushing | |

WARNING:



RISK OF FIRE AND ELECTRICAL SHOCK. FIXTURE MUST BE INSTALLED BY A QUALIFIED ELECTRICIAN ONLY IN ACCORDANCE WITH NATIONAL, LOCAL BUILDING AND ELECTRICAL CODES. DISCONNECT POWER AT ELECTRICAL PANEL BEFORE SERVICING.

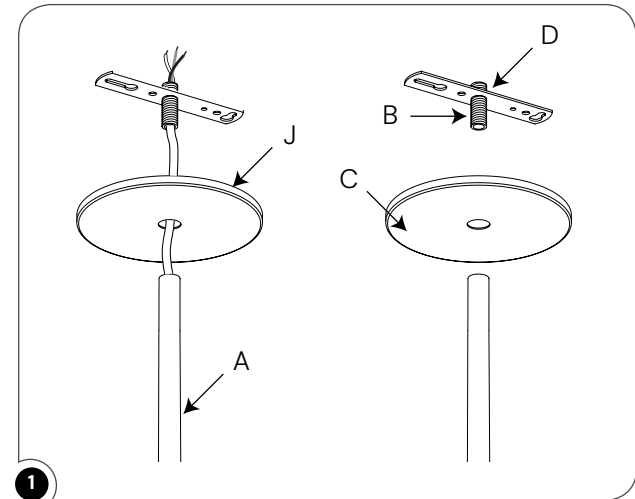

Run power cable through stem(A). Slide the trim ring(J) and then the canopy(C) onto the stem and leave loose. Screw the j-box bracket(D) with the threaded stud(B) onto the stem.

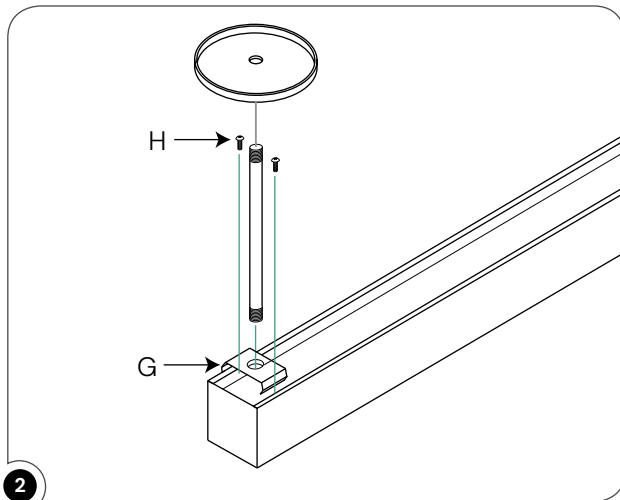

Screw stem bracket(G) to housing with Bracket screws(H). Then Screw the stems onto the stem bracket with mounting nut at each end of the fixture.

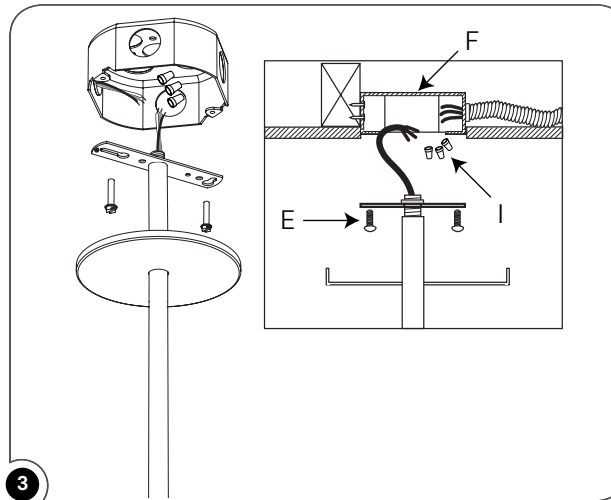

Align the power side of fixture to the j-box(F) and rise to ceiling and secure with screws(E) the j-box bracket to the junction box. Make electrical connection with wire nuts(I). Slide the canopy and secure in place with the trim ring.

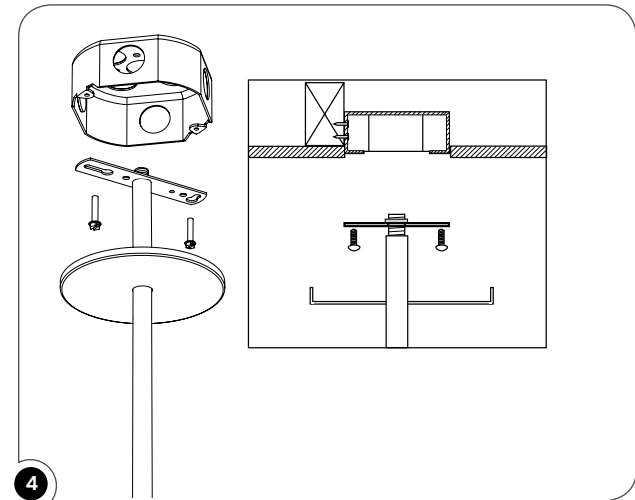

Align the non power side, raise the fixture to the ceiling and secure with screws the j-box bracket to the junction box. Slide the canopy and secure in place with the trim ring.

12100-20-and-12100-40-INSTALLATION INSTRUCTIONS FOR PENDANT STEM

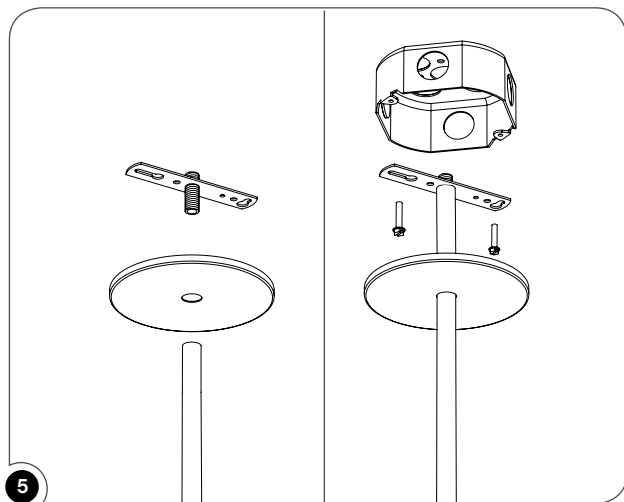

For continuous row, After first fixture is placed follow step 1 through 4 for the next fixture.

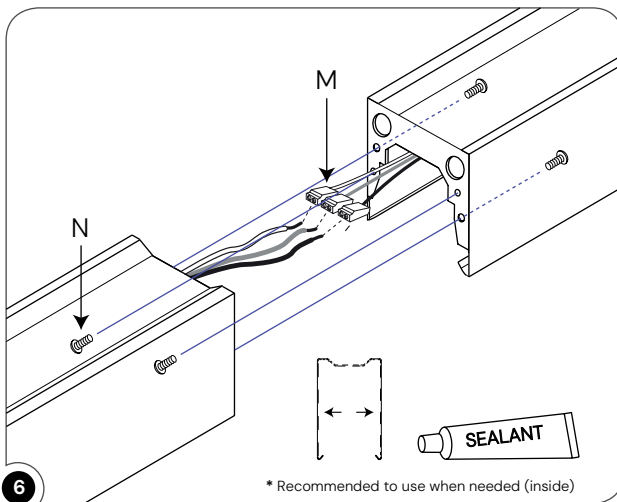

Remove end caps align fixtures make wire connection using wire connectors(M) and screw fixtures together from inside using screws x4(N).

* Recommended distance of stems for continuous row.

