



Project Name:

Type:

Quantity:

FIXTURE SPECIFICATIONS

INTENDED USE

Our recessed, trimless, two-inch direct LED downlights includes a ring designed to be plastered over for the flush, smooth, trimless look. With a high-Color Rendering Index and varying design and architectural specifications, the fixture is made to last for 50,000 hours. The product, with multifaceted specular reflector, is perfect for retail, hospitality, commercial and certain residential settings. Housed in diecast metal. This lighting fixture is made to be secured to existing sheet rock or paneled ceilings up to three inches in thickness. Dimming features included.

PRODUCT FAMILY

- 14121-DIR** Trimless Round Direct
- 14121-ADJ** Trimless Round Adjustable
- 14121-WW** Trimless Round Wall Wash
- 14121-PL** Trimless Round Pull Down
- 14131-DIR** Trimless Round Direct "Shallow"
- 14131-WW** Trimless Round Wall Wash "Shallow"

FEATURES

**Construction:** Die-cast aluminum housing designed to secure to existing sheet rock or panel ceilings up to 3" thick  
**Diameter:** 2.5"  
**Trim Ring:** Reflector and trim secure to sheet rock or housing frame with drywall screws secured to trim ring  
**Optics:** Chip-on-board LED  
**Reflector:** Multifaceted specular reflector  
**Voltage:** 120-277 UNV  
**Dimming:** Universal dimming @ 120/277V and TRIAC @ 120V. Universal dimming compatible with most 2-wire TRIAC, 3-wire ELV, and 5-wire 0-10V dimmers.  
**CRI:** 90  
**Life:** 50,000 hours (L70)  
**Warranty:** 5 years carefree for parts and components (labor not included). A reduced LED lamp life and a warranty void will result in installations where temperatures exceed 35°C  
**Listings:** cETLu listed to UL1598 & UL8750, Title 24 / JA8 compliant certified, NYC approved: Calendar #41937. CCEA (City of Chicago Environmental Air) Certified: Conforms to CCEA-200 with section 18-27-300.22 and special requirements section 14-20-210C-4. Suitable for damp.



Direct Down



Adjustable (25°/40°)



Wall Wash

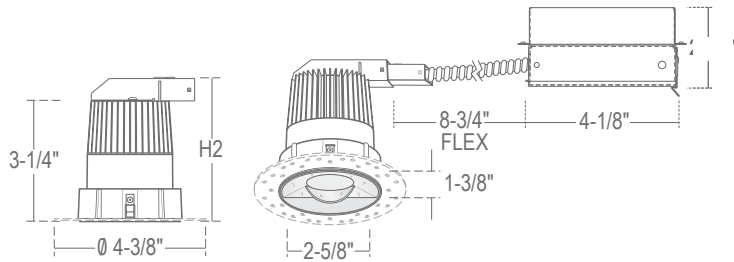

**L7:** H2: 3-7/8"

**-L12:** H2: 5-1/8"

Ceiling Cut-Out: 3-1/16" Max  
Ceiling Thickness: 3-00" Max

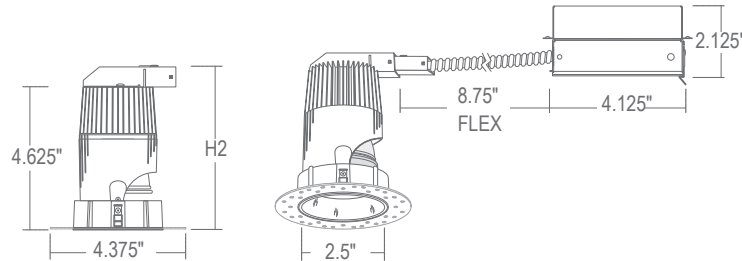

**L10:** H2: 5.25"

**L14:** H2: 6.5"

Ceiling Cut-Out: 3-1/16" Max  
Ceiling Thickness: 3-00" Max



ORDERING INFORMATION Example: (14121-DIR-L10-B25-27K-MW-UNI-NC-WL)

Model	Trim	Lumens	Beam Spread	Color Temp	Finish	Dimming	Housing	Options
<b>14121</b> Trimless Round	<b>DIR</b> Direct Down	<b>L10</b> 1000 lumens	<b>B10</b> 10° Narrow <sup>2</sup>	<b>27K</b> 2700K	<b>MW</b> Matte White	<b>TRI</b> Standard TRIAC Dimming (120V)	<b>RM</b> Remodel - No Housing Required	<b>EM</b> Emergency Backup
	<b>ADJ25</b> 25° Adjustable	<b>L14<sup>4,5</sup></b> 1400 lumens	<b>B25</b> 25° Spot	<b>30K</b> Standard 3000K	<b>PB</b> Polished Black	<b>UNI</b> Universal (120V - 277V)	<b>NC</b> New Construction Non-IC Rated	<b>HEX<sup>3</sup></b> Black Hex Cell Louver
	<b>ADJ40</b> 40° Adjustable	<b>L24<sup>4,5</sup></b> 2400 lumens	<b>B35</b> 35° Flood	<b>35K</b> 3500K	<b>PC<sup>3</sup></b> Polished Clear	<b>O10</b> 0-10V (120V - 277V)	<b>IC</b> New Construction IC Rated	
	<b>WW<sup>1</sup></b> Wall Wash	<b>L7</b> 750 lumens	<b>B60</b> 60° Wide Flood	<b>40K</b> 4000K	<b>PG<sup>3</sup></b> Polished Graphite		<b>FR</b> New Construction Fire Rated	
		<b>L12<sup>6</sup></b> 1200 lumens	<b>Blank</b> Specify for WW Trim		<b>MG<sup>3</sup></b> Matte Gold			
					<b>SH</b> Satin Haze			

<sup>1</sup> Choose BLANK for Beam Spread  
<sup>2</sup> B10 is not field changeable  
<sup>3</sup> Not available for Wall Wash  
<sup>4</sup> IC rated housing not available  
<sup>5</sup> Fire Rated housing not available  
<sup>6</sup> Fire Rated housing and IC rated housing not available

**HOUSING DIMENSIONS**

**New Construction IC Rated**

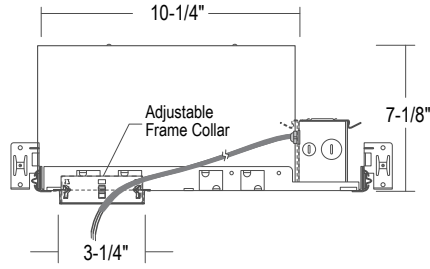
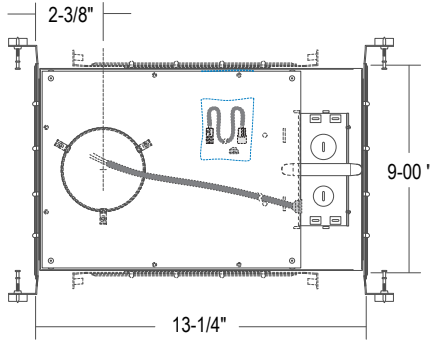

Ceiling Cut-Out: 3-1/4" Diameter  
 Ceiling Thickness (with Frame): 1" Max

**New Construction Non-IC Rated**

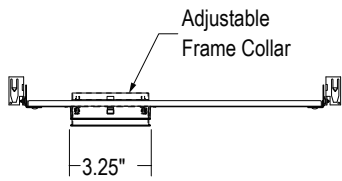

Ceiling Cut-Out: 3.25"

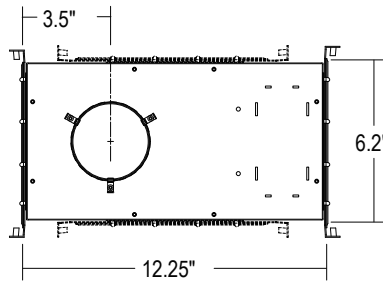

**New Construction Fire Rated**

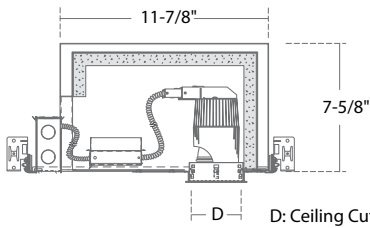

D: Ceiling Cut-out 3-1/4"

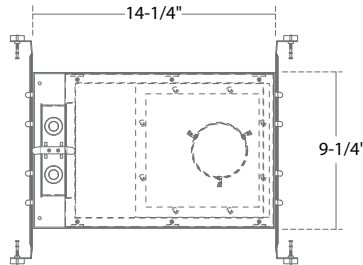

14121-DIR-L10-B10-30K-SB-UNI

1000lm - 10° - 3000K

CANDELA TABULATION

FOOTCANDLE DISTRIBUTION

System Power: 15.0W  
 Test Date: 7/26/2018  
 Beam Angle 50%: 15.7°  
 Field Angle 10%: 29.6°  
 Color Temperature: CRI: 3000K  
 90  
 Lumens Delivered: CBCP: 926.7  
 Power Factor: 8071  
 >0.90

MULTIPLIERS	
Lumens	
1000lm(L09):	1.00
1400lm (L14):	1.43
CRI	
80CRI (Blank):	1.17
90CRI (-C90):	1.00
97CRI (-C97):	0.90
CCT	
4000K :	1.03
3500K :	1.02
3000K :	1.00
2700K :	0.96
2500K :	0.81
1700K :	0.55

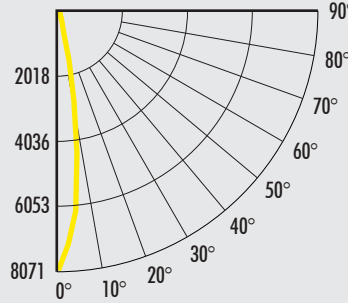

Height	Beam Diameter	FC
15.0'	4.1'	35.9
20.0'	5.5'	20.2
25.0'	6.9'	12.9
30.0'	8.3'	9.0
35.0'	9.7'	6.6

14121-DIR-L10-B25-30K-SB-UNI

1000lm - 25° - 3000K

CANDELA TABULATION

FOOTCANDLE DISTRIBUTION

System Power: 15.1W  
 Test Date: 1/20/2017  
 Beam Angle 50%: 29.2°  
 Field Angle 10%: 47.9°  
 Color Temperature: CRI : 3163K  
 R9 Value: 93.2  
 71.9  
 Lumens Delivered: CBCP: 1040lm  
 Power Factor: 4047cd  
 >0.90

MULTIPLIERS	
Lumens	
1000lm(L09):	1.00
1400lm (L14):	1.35
CRI	
80CRI (Blank):	1.17
90CRI (-C90):	1.00
97CRI (-C97):	0.90
CCT	
4000K :	1.03
3500K :	1.02
3000K :	1.00
2700K :	0.96
2500K :	0.79
1700K :	0.54

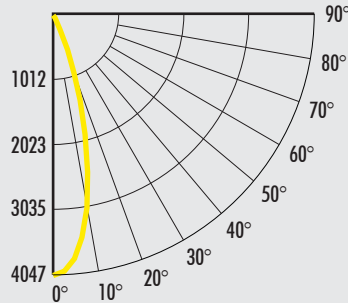

Height	Beam Diameter	FC
15.0'	7.8'	18.0
20.0'	10.4'	10.1
25.0'	13.0'	6.5
30.0'	15.6'	4.5
35.0'	18.2'	3.3

14121-DIR-L10-B35-30K-SB-UNI

1000lm - 35° - 3000K

CANDELA TABULATION

FOOTCANDLE DISTRIBUTION

System Power: 15.0W  
 Test Date: 1/20/2017  
 Beam Angle 50%: 37.9°  
 Field Angle 10%: 55.0°  
 Color Temperature: CRI : 3170K  
 R9 Value: 92  
 66.6  
 Lumens Delivered: CBCP: 1079  
 Power Factor: 2882  
 >0.90

MULTIPLIERS	
Lumens	
1000lm (L09) :	1.00
1400lm (L14) :	1.30
CRI	
80CRI (Blank):	1.17
90CRI (-C90):	1.00
97CRI (-C97):	0.90
CCT	
4000K :	1.03
3500K :	1.02
3000K :	1.00
2700K :	0.96
2500K :	0.79
1700K :	0.54

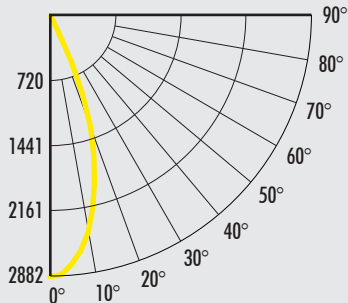

Height	Beam Diameter	FC
15.0'	10.3'	12.8
20.0'	13.7'	7.2
25.0'	17.2'	4.6
30.0'	20.6'	3.2
35.0'	24.0'	2.4

14121-DIR-L10-B60-30K-SB-UNI

1000lm - 60° - 3000K

CANDELA TABULATION

FOOTCANDLE DISTRIBUTION

System Power: 15.4W  
 Test Date: 10/17/2017  
 Beam Angle 50%: 57.1°  
 Field Angle 10%: 88.1°  
 Color Temperature: CRI : 3070K  
 R9 Value: 94.7  
 71.8  
 Lumens Delivered: CBCP: 717  
 Power Factor: 771  
 0.97

MULTIPLIERS	
Lumens	
1000lm (L09) :	1.00
1400lm (L14) :	1.95
CRI	
80CRI (Blank):	1.17
90CRI (-C90):	1.00
97CRI (-C97):	0.90
CCT	
4000K :	1.03
3500K :	1.02
3000K :	1.00
2700K :	0.96
2500K :	0.79
1700K :	0.54

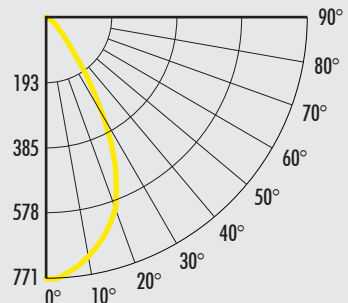

Height	Beam Diameter	FC
6.0'	6.5'	21.4
8.0'	8.7'	12.0
10.0'	10.9'	7.7
12.0'	13.1'	5.4
16.0'	17.4'	3.0

14121-ADJ25-L10-B10-30K-SB-UNI

1000lm - 10° - 3000K

CANDELA TABULATION

FOOTCANDLE DISTRIBUTION

System Power: 15.0W  
 Test Date: 7/26/2018  
 Beam Angle 50%: 15.7°  
 Field Angle 10%: 29.6°  
 Color Temperature: CRI: 3000K  
 90  
 Lumens Delivered: CBCP: 926.7  
 Power Factor: 8071  
 >0.90

MULTIPLIERS	
Lumens	
1000lm(L09):	1.00
1400lm (L14):	1.43
CRI	
80CRI (Blank):	1.17
90CRI (-C90):	1.00
97CRI (-C97):	0.90
CCT	
4000K :	1.03
3500K :	1.02
3000K :	1.00
2700K :	0.96
2500K :	0.79
1700K :	0.54

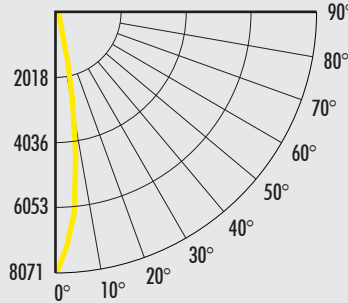

Height	Beam Diameter	FC
15.0'	4.1'	35.9
20.0'	5.5'	20.2
25.0'	6.9'	12.9
30.0'	8.3'	9.0
35.0'	9.7'	6.6

14121-ADJ25-L10-B25-30K-SB-UNI

1000lm - 25° - 3000K

CANDELA TABULATION

FOOTCANDLE DISTRIBUTION

System Power: 15.1W  
 Test Date: 1/20/2017  
 Beam Angle 50%: 29.2°  
 Field Angle 10%: 47.9°  
 Color Temperature: CRI : 3163K  
 R9 Value: 93.2  
 71.9  
 Lumens Delivered: CBCP: 1040  
 Power Factor: 4047  
 >0.90

MULTIPLIERS	
Lumens	
1000lm(L09):	1.00
1400lm (L14):	1.35
CRI	
80CRI (Blank):	1.17
90CRI (-C90):	1.00
97CRI (-C97):	0.90
CCT	
4000K :	1.03
3500K :	1.02
3000K :	1.00
2700K :	0.96
2500K :	0.79
1700K :	0.54

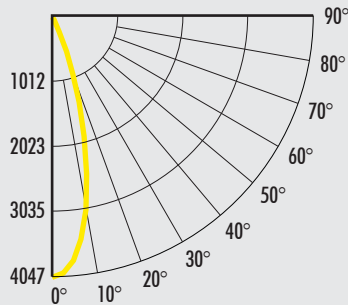

Height	Beam Diameter	FC
15.0'	7.8"	18.0
20.0'	10.4"	10.1
25.0'	13.0"	6.5
30.0'	15.6"	4.5
35.0'	18.2"	3.3

14121-ADJ25-L10-B35-30K-SB-UNI

1000lm - 35° - 3000K

CANDELA TABULATION

FOOTCANDLE DISTRIBUTION

System Power: 15.0W  
 Test Date: 1/20/2017  
 Beam Angle 50%: 37.9°  
 Field Angle 10%: 55.0°  
 Color Temperature: CRI : 3170K  
 R9 Value: 92  
 66.6  
 Lumens Delivered: CBCP: 1079  
 Power Factor: 2882  
 >0.90

MULTIPLIERS	
Lumens	
1000lm(L09):	1.00
1400lm (L14):	1.30
CRI	
80CRI (Blank):	1.17
90CRI (-C90):	1.00
97CRI (-C97):	0.90
CCT	
4000K :	1.03
3500K :	1.02
3000K :	1.00
2700K :	0.96
2500K :	0.79
1700K :	0.54

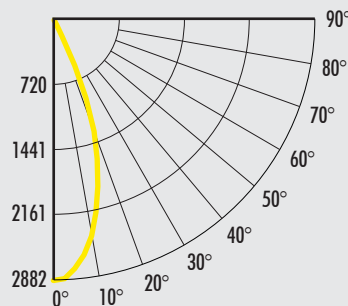

Height	Beam Diameter	FC
15.0'	10.3"	12.8
20.0'	13.7"	7.2
25.0'	17.2"	4.6
30.0'	20.6"	3.2
35.0'	24.0"	2.4

14121-ADJ25-L10-B60-30K-SB-UNI

1000lm - 60° - 3000K

CANDELA TABULATION

FOOTCANDLE DISTRIBUTION

System Power: 15.4W  
 Test Date: 10/17/2017  
 Beam Angle 50%: 57.1°  
 Field Angle 10%: 88.1°  
 Color Temperature: CRI : 3070K  
 R9 Value: 94.7  
 71.8  
 Lumens Delivered: CBCP: 717lm  
 Power Factor: 771cd  
 0.97

MULTIPLIERS	
Lumens	
1000lm(L09):	1.00
1400lm (L14):	1.95
CRI	
80CRI (Blank):	1.17
90CRI (-C90):	1.00
97CRI (-C97):	0.90
CCT	
4000K :	1.03
3500K :	1.02
3000K :	1.00
2700K :	0.96
2500K :	0.79
1700K :	0.54

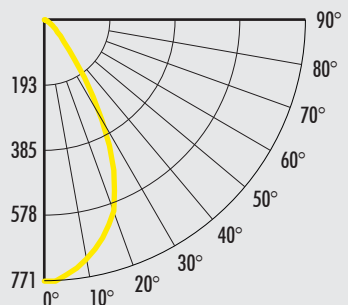

Height	Beam Diameter	FC
6.0'	6.5"	21.4
8.0'	8.7"	12.0
10.0'	10.9"	7.7
12.0'	13.1"	5.4
16.0'	17.4"	3.0

14121-ADJ40-L10-B10-30K-SB-UNI

1000lm - 10° - 3000K

CANDELA TABULATION

FOOTCANDLE DISTRIBUTION

System Power: 15.0W  
 Test Date: 7/26/2018  
 Beam Angle 50%: 15.7°  
 Field Angle 10%: 29.6°  
 Color Temperature: CRI: 3000K  
 90  
 Lumens Delivered: CBCP: 926.7  
 Power Factor: 8071  
 >0.90

MULTIPLIERS	
Lumens	
1000lm(L09):	1.00
1400lm (L14):	1.43
CRI	
80CRI (Blank):	1.17
90CRI (-C90):	1.00
97CRI (-C97):	0.90
CCT	
4000K :	1.03
3500K :	1.02
3000K :	1.00
2700K :	0.96
2500K :	0.79
1700K :	0.54

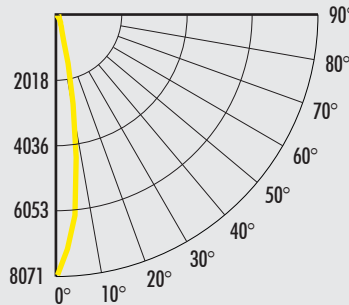

Height	Beam Diameter	FC
15.0'	4.1'	35.9
20.0'	5.5'	20.2
25.0'	6.9'	12.9
30.0'	8.3'	9.0
35.0'	9.7'	6.6

14121-ADJ40-L10-B25-30K-SB-UNI

1000lm - 25° - 3000K

CANDELA TABULATION

FOOTCANDLE DISTRIBUTION

System Power: 15.1W  
 Test Date: 7/30/2018  
 Beam Angle 50%: 29.1°  
 Field Angle 10%: 47.8°  
 Color Temperature: CRI: 3163K  
 R9 Value: 93.2  
 71.8  
 Lumens Delivered: CBCP: 1085  
 Power Factor: 4067  
 >0.90

MULTIPLIERS	
Lumens	
1000lm(L09):	1.00
1400lm (L14):	1.36
CRI	
80CRI (Blank):	1.17
90CRI (-C90):	1.00
97CRI (-C97):	0.90
CCT	
4000K :	1.03
3500K :	1.02
3000K :	1.00
2700K :	0.96
2500K :	0.79
1700K :	0.54

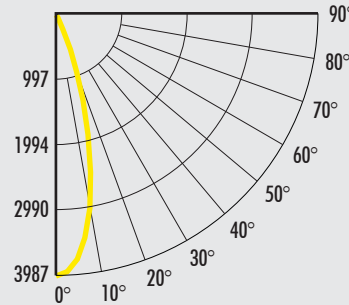

Height	Beam Diameter	FC
15.0'	7.6'	17.7
20.0'	10.2'	10.0
25.0'	12.7'	6.4
30.0'	15.3'	4.4
35.0'	17.8'	3.3

14121-ADJ40-L10-B35-30K-SB-UNI

1000lm - 35° - 3000K

CANDELA TABULATION

FOOTCANDLE DISTRIBUTION

System Power: 15.0W  
 Test Date: 7/30/2018  
 Beam Angle 50%: 37.9°  
 Field Angle 10%: 53.6°  
 Color Temperature: CRI: 3170K  
 R9 Value: 92  
 66.6  
 Lumens Delivered: CBCP: 1126  
 Power Factor: 2888  
 >0.90

MULTIPLIERS	
Lumens	
1000lm(L09):	1.00
1400lm (L14):	1.31
CRI	
80CRI (Blank):	1.17
90CRI (-C90):	1.00
97CRI (-C97):	0.90
CCT	
4000K :	1.03
3500K :	1.02
3000K :	1.00
2700K :	0.96
2500K :	0.79
1700K :	0.54

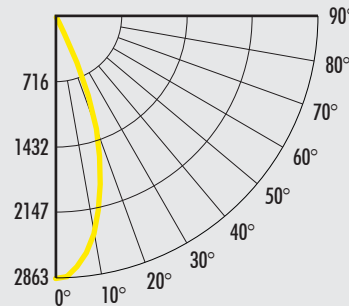

Height	Beam Diameter	FC
15.0'	9.8'	12.7
20.0'	13.1'	7.2
25.0'	16.4'	4.6
30.0'	19.7'	3.2
35.0'	22.9'	2.3

14121-ADJ40-L10-B60-30K-SB-UNI

1000lm - 60° - 3000K

CANDELA TABULATION

FOOTCANDLE DISTRIBUTION

System Power: 15.4W  
 Test Date: 7/30/2018  
 Beam Angle 50%: 57.1°  
 Field Angle 10%: 88.1°  
 Color Temperature: CRI: 3070K  
 R9 Value: 94.7  
 71.8  
 Lumens Delivered: CBCP: 717  
 Power Factor: 771  
 0.97

MULTIPLIERS	
Lumens	
1000lm(L09):	1.00
1400lm (L14):	1.98
CRI	
80CRI (Blank):	1.17
90CRI (-C90):	1.00
97CRI (-C97):	0.90
CCT	
4000K :	1.03
3500K :	1.02
3000K :	1.00
2700K :	0.96
2500K :	0.79
1700K :	0.54

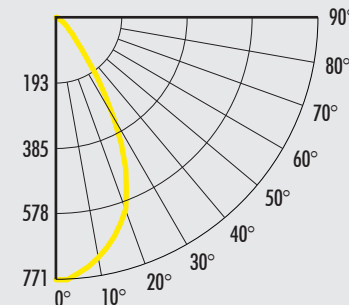

Height	Beam Diameter	FC
6.0'	6.5'	21.4
8.0'	8.7'	12.0
10.0'	10.9'	7.7
12.0'	13.1'	5.4
16.0'	17.4'	3.0