

Project Name: \_\_\_\_\_ Type: \_\_\_\_\_ Quantity: \_\_\_\_\_

### INTENDED USE

The Lumino Commercial LED Recessed Direct Down Light is designed to maximize heat rejection in an open air environment. The Lumino is designed for new construction installations for medium to high ceilings in commercial, institutional, and architectural spaces.

### DETAILS

W 9.25" x L 12.75" x Dia 8.75"

Construction: Integral cast-aluminum, heat sink design Non-IC rated housing must be kept 3" from insulation

Mounting: Suitable for New Construction Installations Only  
(2) 24" Adjustable Hanger Bar w/ 90° Repositioning Included  
Earthquake Structural Cable Compatible

Junction Box: 16 gauge pre-wired galvanized steel 64 cubic-inch for maximum (8) #12 AWG wires Equipped with safety standard die-cast aluminum fitting for flex-conduit

Reflector: Airtight to restrict airflow from room into plenums in compliance to the WSEC (Washington State Energy Code)

### ADDITIONAL FEATURES

Voltage: 120/277 50/60 Hz

Dimming: 5-Wire 0-10V Dimming

CRI: 90

Operating Temperature: 14°F(-10°C) - 176°F (80°C)

Life: 50,000 Hours

Power Factor: > .90

Listings: ETL/cETL listed to UL1598 and UL8750. Suitable for dry, damp, and wet locations.

Meets CA Title 24 Requirements and other standards restricting the use of Medium Base or Bi-Pin Sockets.

Caution: Use of surge protectors recommended on the power entering LED Housings.

Surge damage is not covered by warranty. (+1KV)

Remote Emergency Option: 90 minute emergency mode when AC power fails

Remote test switch, plate cover, and junction box included

Generator Transfer Device Option: Switches the driver to auxiliary generator power during loss of normal AC power (Recommended for applications requiring individual circuit switching)

ORDERING INFORMATION Example: (14086-8-10W-30K-WH-D10-EM)

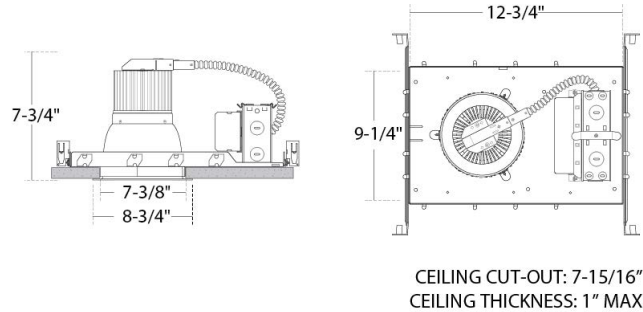

Model	Wattage & Lumens	Color Temp	Reflector Finish	Housing	Driver	Options
14086-8	<b>9W</b> 9W   1000 lms	<b>27K</b> 2700K	<b>HZ</b> Haze	<b>Non-IC</b> Non-IC Rated	<b>D10</b> 0-10V Dimming	<b>EM12</b> 12 Watt Emergency Battery
	<b>17W</b> 17W   2000 lms	<b>30K</b> 3000K	Reflector/ White Ring			
	<b>22W</b> 22W   2400 lms	<b>35K</b> 3500K	<b>WH</b> White Reflector/ White Ring	<b>ICA</b> ICA Rated	<b>UNI</b> Universal Dimming (0-10V, ELV and TRIAC)	<b>EM25</b> 25 Watt Emergency Battery
	<b>28W</b> 28W   2900 lms	<b>40K</b> 4000K				
	<b>32W</b> 32W   3300 lms	<b>50K<sup>2</sup></b> <b>5000K</b>				<b>GTD</b> Generator Transfer Device
	<b>35W</b> 35W   3800 lms					
	<b>39W</b> 39W   4100 lms					
	<b>48W</b> 48W   4800 lms					
	<b>55W<sup>1</sup></b> 55W   5300 lms					
	<b>45W</b> 45W   5600 lms					
<b>50W</b> 50W   6200 lms						

<sup>1</sup> Only available with 0-10V dimming options. See page 2 for further information.

<sup>2</sup> 50K only available in 80CRI

## COMPATIBLE DIMMERS

	<b>0-10 V</b> <a href="#">2100</a> <a href="#">2101</a> <a href="#">2102</a>	
		Diva DDTV
		IP-710-DL

## COLOR TEMPERATURE GUIDE



<p><b>2700K</b></p> <p>WARM WHITE</p> <p>friendly personal intimate</p> <p>HOMES LIBRARIES RESTAURANTS</p> <p>✓</p>	<p><b>3000K</b></p> <p>SOFT WHITE GLOW</p> <p>soft warm pleasing</p> <p>HOMES HOTEL ROOMS LOBBIES RETAIL STORES</p> <p>✓</p>	<p><b>3500K</b></p> <p>NEUTRAL GLOW</p> <p>sociable inviting non-threatening</p> <p>EXECUTIVE OFFICES RECEPTION AREAS SUPERMARKETS</p> <p>✓</p>	<p><b>4000K</b></p> <p>COOL WHITE GLOW</p> <p>neat clean efficient</p> <p>OFFICES CLASSROOMS MASS MERCHANTISERS SHOWROOMS</p> <p>✓</p>	<p><b>5000K</b></p> <p>DAYLIGHT GLOW</p> <p>bright cool alert</p> <p>GRAPHICS INDUSTRY HOSPITALS GALLERIES BEAUTY SALONS</p> <p>✓</p>
---	--	---	--	---