

Project Name:

Type:

Quantity:

FIXTURE SPECIFICATIONS

INTENDED USE

The Illusione 2.5 Inch Architectural LED Square Trimless Recessed Light Fixture is designed for lasting durability and beauty while providing quality and energy efficient lighting for low to medium ceilings. The Illusione is an ideal solution for clear and bright lighting in retail, hospitality, commercial, and high-end residential settings.

FEATURES

Construction: Die-Cast Aluminum Housing Designed to Secure to Existing Sheet Rock or Panel Ceilings Up to 1" Thick

Trim Ring: Reflector and Trim Secure to Sheet Rock or Housing Frame with Drywall Screws Secured to Trim Ring

Optics: Chip On Board LED

Reflector: Multifaced Specular Reflector

Voltage: 120/277 UNV

Dimming: Universal Dimming

Compatible with most 3-Wire ELV, 2-Wire Incandescent and 5-Wire 0-10V dimmers

Warm Dimming Option: Fixture starts at 2700K Full-Brightness and Smoothly Dims to 1850K / 5%

CRI: 80 Standard (97 Optional)

Life: 50,000 Hours (L70)

Lamp Equivalent: 75W MR16

Warranty: 5 Years Free of Defects in Material & Craftsmanship

Listings: ETL/cETL listed to UL1598 & UL8750

Title 24 / JA8 Compliant Certified



Fixed

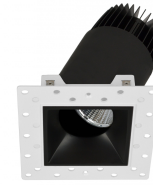

Adjustable



Wall Wash

Fixed / Adjustable

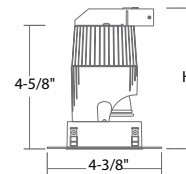

10L: H: 5-1/4"
14L: H: 6-1/2"

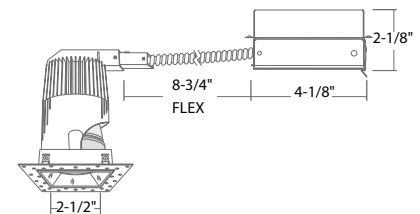

Ceiling Cut-Out: 2-7/8" Max
Ceiling Thickness: 3-00" Max

Wall Wash

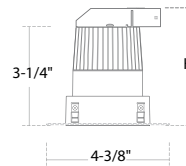

7L: H: 3-7/8"
12L: H: 5-1/8"

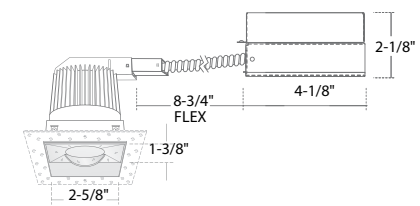

Ceiling Cut-Out: 2-7/8" Max
Ceiling Thickness: 3-00" Max



New Construction Frame (Square) - NC

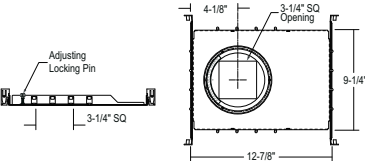

New Construction IC Frame (Square)

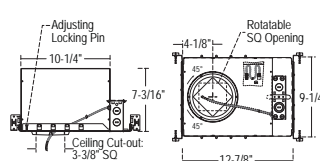

Shallow Frame - SH

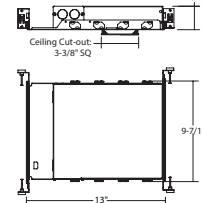

Fire-rated Frame - FR

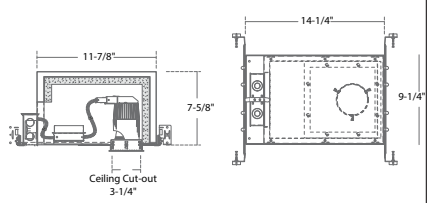

ORDERING INFORMATION Example: (14073-DIR-10L-D10-27K-MW-NC-WL)

Model	Trim	Delivered Lumens	Beam Spread	Color Temp	Reflector Finish	Housing	
14073	DIR Direct Down	10L 1000 lumens	Blank None Required ²	27K 2700K	MW Matte White	NC New Construction	
	25ADJ 25° Adjustable	14L 1400 lumens ⁸	D10 10° Narrow	27C 2700K (97 CRI)	BL Black	IC New Construction IC Rated	
	40ADJ 40° Adjustable	24L 2400 lumens ^{1,5,6,8}	D25 25° Spot	30K 3000K	CL Clear	SH Shallow Frame ^{1,5,7} H: 2-3/16"	
				D35 35° Flood	30C 3000K (97 CRI)	GR Graphite ³	FR Fire-Rated Frame
				D60 60° Wide Flood	35K 3500K	SH Satin Haze	
	WW Wall Wash	7L 750 lumens			40K 4000K		
		12L 1200 lumens ⁸		WD Warm Dimming (1800K-3000K)			
						Options	
						EM Emergency Backup ⁴	
						WL Wet Location	
						HEX Black Hex Cell Louver	

¹ Only available with DIR and WW trim styles with Shallow Frame (SH)
² Only available for Wall Wash
³ Not available for Wall Wash
⁴ EM not available with Shallow Frame (SH)
⁵ Not available with 10° Narrow Beam Spread
⁶ Not available for Warm Dimming option
⁷ Shallow housing not available for wall wash
⁸ Not available for IC-rated frame and fire-rated frame.

1000lm, 10°, 3000K

System Power: 15.0W
 Test Date: 7/26/2018
 Beam Angle 50%: 15.7°
 Field Angle 10%: 29.6°
 Color Temperature: 3000K
 CRI: 90
 Lumens Delivered: 926.7
 CBCP: 8071
 Power Factor: >0.90

MULTIPLIERS	
Lumens	
1000lm (L09):	1.00
1400lm (L14):	1.43
CRI	
80CRI (Blank):	1.17
90CRI (-C90):	1.00
97CRI (-C97):	0.90
CCT	
4000K:	1.03
3500K:	1.02
3000K:	1.00
2700K:	0.96
2500K:	0.81
1700K:	0.55

CANDELA TABULATION

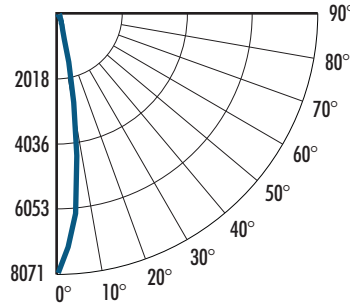

FOOTCANDLE DISTRIBUTION

Height	Beam Diameter	FC
15.0'	4.1'	35.9
20.0'	5.5'	20.2
25.0'	6.9'	12.9
30.0'	8.3'	9.0
35.0'	9.7'	6.6

1000lm, 25°, 3000K

System Power: 15.1W
 Test Date: 1/20/2017
 Beam Angle 50%: 29.2°
 Field Angle 10%: 47.9°
 Color Temperature: 3163K
 CRI: 93.2
 R9 Value: 71.9
 Lumens Delivered: 1040lm
 CBCP: 4047cd
 Power Factor: >0.90

MULTIPLIERS	
Lumens	
1000lm (L09):	1.00
1400lm (L14):	1.35
CRI	
80CRI (Blank):	1.17
90CRI (-C90):	1.00
97CRI (-C97):	0.90
CCT	
4000K:	1.03
3500K:	1.02
3000K:	1.00
2700K:	0.96
2500K:	0.79
1700K:	0.54

CANDELA TABULATION

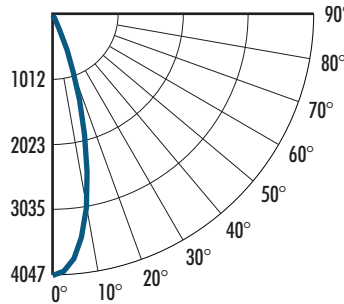

FOOTCANDLE DISTRIBUTION

Height	Beam Diameter	FC
15.0'	7.8'	18.0
20.0'	10.4'	10.1
25.0'	13.0'	6.5
30.0'	15.6'	4.5
35.0'	18.2'	3.3

1000lm, 35°, 3000K

System Power: 15.0W
 Test Date: 1/20/2017
 Beam Angle 50%: 37.9°
 Field Angle 10%: 55.0°
 Color Temperature: 3170K
 CRI: 92
 R9 Value: 66.6
 Lumens Delivered: 1079
 CBCP: 2882
 Power Factor: >0.90

MULTIPLIERS	
Lumens	
1000lm (L09):	1.00
1400lm (L14):	1.30
CRI	
80CRI (Blank):	1.17
90CRI (-C90):	1.00
97CRI (-C97):	0.90
CCT	
4000K:	1.03
3500K:	1.02
3000K:	1.00
2700K:	0.96
2500K:	0.79
1700K:	0.54

CANDELA TABULATION

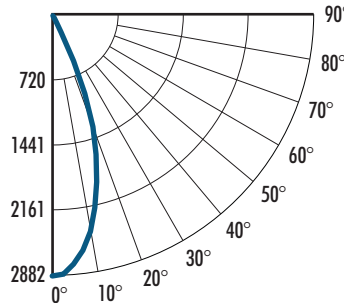

FOOTCANDLE DISTRIBUTION

Height	Beam Diameter	FC
15.0'	10.3'	12.8
20.0'	13.7'	7.2
25.0'	17.2'	4.6
30.0'	20.6'	3.2
35.0'	24.0'	2.4

1000lm, 60°, 3000K

System Power: 15.4W
 Test Date: 10/17/2017
 Beam Angle 50%: 57.1°
 Field Angle 10%: 88.1°
 Color Temperature: 3070K
 CRI: 94.7
 R9 Value: 71.8
 Lumens Delivered: 717
 CBCP: 771
 Power Factor: 0.97

MULTIPLIERS	
Lumens	
1000lm (L09):	1.00
1400lm (L14):	1.95
CRI	
80CRI (Blank):	1.17
90CRI (-C90):	1.00
97CRI (-C97):	0.90
CCT	
4000K:	1.03
3500K:	1.02
3000K:	1.00
2700K:	0.96
2500K:	0.79
1700K:	0.54

CANDELA TABULATION

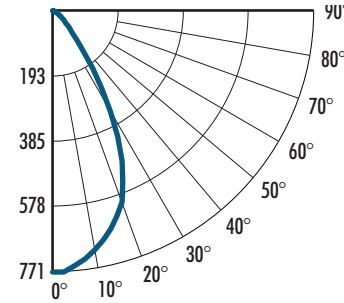

FOOTCANDLE DISTRIBUTION

Height	Beam Diameter	FC
6.0'	6.5'	21.4
8.0'	8.7'	12.0
10.0'	10.9'	7.7
12.0'	13.1'	5.4
16.0'	17.4'	3.0

1000lm, 10°, 3000K

System Power: 15.0W
 Test Date: 7/26/2018
 Beam Angle 50%: 15.7°
 Field Angle 10%: 29.6°
 Color Temperature: 3000K
 CRI: 90
 Lumens Delivered: 926.7
 CBCP: 8071
 Power Factor: >0.90

MULTIPLIERS	
Lumens	
1000lm (L09) :	1.00
1400lm (L14) :	1.43
CRI	
80CRI (Blank):	1.17
90CRI (-C90):	1.00
97CRI (-C97):	0.90
CCT	
4000K :	1.03
3500K :	1.02
3000K :	1.00
2700K :	0.96
2500K :	0.79
1700K :	0.54

CANDELA TABULATION

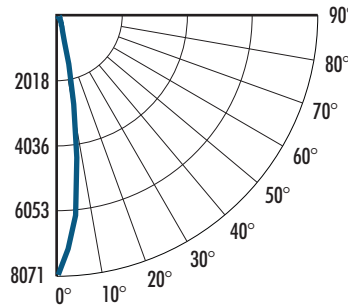

FOOTCANDLE DISTRIBUTION

Height	Beam Diameter	FC
15.0'	4.1'	35.9
20.0'	5.5'	20.2
25.0'	6.9'	12.9
30.0'	8.3'	9.0
35.0'	9.7'	6.6

1000lm, 25°, 3000K

System Power: 15.1W
 Test Date: 1/20/2017
 Beam Angle 50%: 29.2°
 Field Angle 10%: 47.9°
 Color Temperature: 3163K
 CRI : 93.2
 R9 Value: 71.9
 Lumens Delivered: 1040
 CBCP: 4047
 Power Factor: >0.90

MULTIPLIERS	
Lumens	
1000lm (L09) :	1.00
1400lm (L14) :	1.35
CRI	
80CRI (Blank):	1.17
90CRI (-C90):	1.00
97CRI (-C97):	0.90
CCT	
4000K :	1.03
3500K :	1.02
3000K :	1.00
2700K :	0.96
2500K :	0.79
1700K :	0.54

CANDELA TABULATION

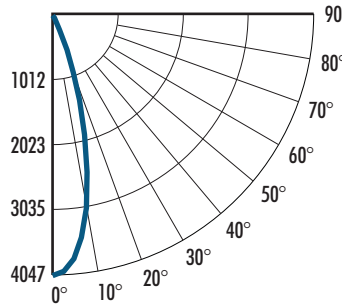

FOOTCANDLE DISTRIBUTION

Height	Beam Diameter	FC
15.0'	7.8'	18.0
20.0'	10.4'	10.1
25.0'	13.0'	6.5
30.0'	15.6'	4.5
35.0'	18.2'	3.3

1000lm, 35°, 3000K

System Power: 15.0W
 Test Date: 1/20/2017
 Beam Angle 50%: 37.9°
 Field Angle 10%: 55.0°
 Color Temperature: 3170K
 CRI : 92
 R9 Value: 66.6
 Lumens Delivered: 1079
 CBCP: 2882
 Power Factor: >0.90

MULTIPLIERS	
Lumens	
1000lm (L09) :	1.00
1400lm (L14) :	1.30
CRI	
80CRI (Blank):	1.17
90CRI (-C90):	1.00
97CRI (-C97):	0.90
CCT	
4000K :	1.03
3500K :	1.02
3000K :	1.00
2700K :	0.96
2500K :	0.79
1700K :	0.54

CANDELA TABULATION

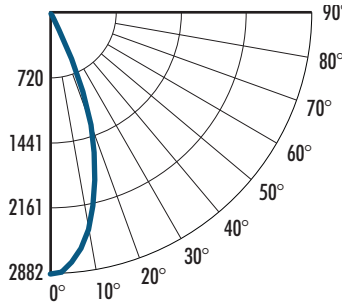

FOOTCANDLE DISTRIBUTION

Height	Beam Diameter	FC
15.0'	10.3'	12.8
20.0'	13.7'	7.2
25.0'	17.2'	4.6
30.0'	20.6'	3.2
35.0'	24.0'	2.4

1000lm, 60°, 3000K

System Power: 15.4W
 Test Date: 10/17/2017
 Beam Angle 50%: 57.1°
 Field Angle 10%: 88.1°
 Color Temperature: 3070K
 CRI : 94.7
 R9 Value: 71.8
 Lumens Delivered: 717lm
 CBCP: 771cd
 Power Factor: 0.97

MULTIPLIERS	
Lumens	
1000lm (L09) :	1.00
1400lm (L14) :	1.95
CRI	
80CRI (Blank):	1.17
90CRI (-C90):	1.00
97CRI (-C97):	0.90
CCT	
4000K :	1.03
3500K :	1.02
3000K :	1.00
2700K :	0.96
2500K :	0.79
1700K :	0.54

CANDELA TABULATION

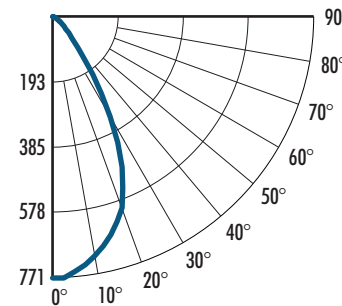

FOOTCANDLE DISTRIBUTION

Height	Beam Diameter	FC
6.0'	6.5'	21.4
8.0'	8.7'	12.0
10.0'	10.9'	7.7
12.0'	13.1'	5.4
16.0'	17.4'	3.0

1000lm, 10°, 3000K

System Power: 15.0W
 Test Date: 7/26/2018
 Beam Angle 50%: 15.7°
 Field Angle 10%: 29.6°
 Color Temperature: 3000K
 CRI: 90
 Lumens Delivered: 926.7
 CBCP: 8071
 Power Factor: >0.90

MULTIPLIERS	
Lumens	
1000lm (L09):	1.00
1400lm (L14):	1.43
CRI	
80CRI (Blank):	1.17
90CRI (-C90):	1.00
97CRI (-C97):	0.90
CCT	
4000K:	1.03
3500K:	1.02
3000K:	1.00
2700K:	0.96
2500K:	0.79
1700K:	0.54

CANDELA TABULATION

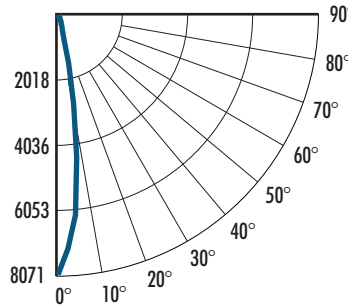

FOOTCANDLE DISTRIBUTION

Height	Beam Diameter	FC
15.0'	4.1'	35.9
20.0'	5.5'	20.2
25.0'	6.9'	12.9
30.0'	8.3'	9.0
35.0'	9.7'	6.6

1000, 1m, Narrow Flood, 3000K

System Power: 15.1W
 Test Date: 7/30/2018
 Beam Angle 50%: 29.1°
 Field Angle 10%: 47.8°
 Color Temperature: 3163K
 CRI: 93.2
 R9 Value: 71.8
 Lumens Delivered: 1085
 CBCP: 4067
 Power Factor: >0.90

MULTIPLIERS	
Lumens	
1000lm (L09):	1.00
1400lm (L14):	1.36
CRI	
80CRI (Blank):	1.17
90CRI (-C90):	1.00
97CRI (-C97):	0.90
CCT	
4000K:	1.03
3500K:	1.02
3000K:	1.00
2700K:	0.96
2500K:	0.79
1700K:	0.54

CANDELA TABULATION

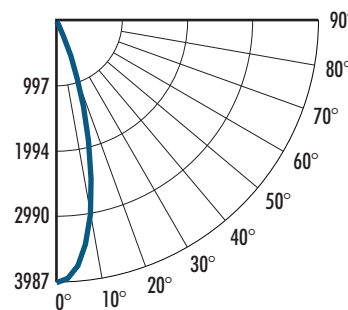

FOOTCANDLE DISTRIBUTION

Height	Beam Diameter	FC
15.0'	7.6'	17.7
20.0'	10.2'	10.0
25.0'	12.7'	6.4
30.0'	15.3'	4.4
35.0'	17.8'	3.3

1000, 1m, Flood, 3000K

System Power: 15.0W
 Test Date: 7/30/2018
 Beam Angle 50%: 37.9°
 Field Angle 10%: 53.6°
 Color Temperature: 3170K
 CRI: 92
 R9 Value: 66.6
 Lumens Delivered: 1126
 CBCP: 2888
 Power Factor: >0.90

MULTIPLIERS	
Lumens	
1000lm (L09):	1.00
1400lm (L14):	1.31
CRI	
80CRI (Blank):	1.17
90CRI (-C90):	1.00
97CRI (-C97):	0.90
CCT	
4000K:	1.03
3500K:	1.02
3000K:	1.00
2700K:	0.96
2500K:	0.79
1700K:	0.54

CANDELA TABULATION

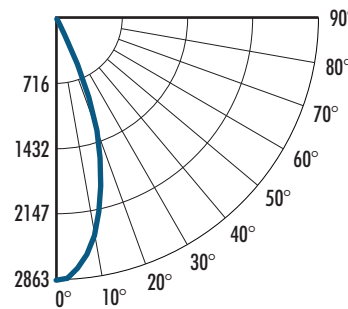

FOOTCANDLE DISTRIBUTION

Height	Beam Diameter	FC
15.0'	9.8'	12.7
20.0'	13.1'	7.2
25.0'	16.4'	4.6
30.0'	19.7'	3.2
35.0'	22.9'	2.3

1000lm, 60°, 3000K

System Power: 15.4W
 Test Date: 7/30/2018
 Beam Angle 50%: 57.1°
 Field Angle 10%: 88.1°
 Color Temperature: 3070K
 CRI: 94.7
 R9 Value: 71.8
 Lumens Delivered: 717
 CBCP: 771
 Power Factor: 0.97

MULTIPLIERS	
Lumens	
1000lm (L09):	1.00
1400lm (L14):	1.98
CRI	
80CRI (Blank):	1.17
90CRI (-C90):	1.00
97CRI (-C97):	0.90
CCT	
4000K:	1.03
3500K:	1.02
3000K:	1.00
2700K:	0.96
2500K:	0.79
1700K:	0.54

CANDELA TABULATION

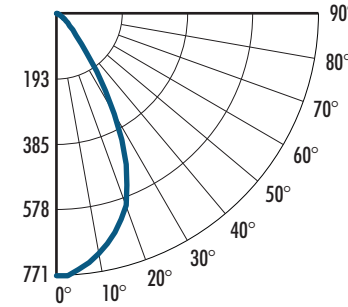

FOOTCANDLE DISTRIBUTION

Height	Beam Diameter	FC
6.0'	6.5'	21.4
8.0'	8.7'	12.0
10.0'	10.9'	7.7
12.0'	13.1'	5.4
16.0'	17.4'	3.0